

**MIGRARE**



# THE ULTIMATE FLARING & SWAGING TOOLS

COMPLIANT WITH  
AMERICA'S  
HVAC  
STANDARDS

**1 YEAR  
WARRANTY**



**PATENT PENDING**

**EASY**  
NO REAMING 

**10X**  
FASTER 

**FITS INTO ANY**  
**DRILL** 1800 RPM  
18V 

**HEAT**  
BY FRICTION 

**AVOID**  
CRACKS AND LEAKS 

## HIGH TEMPERATURE SWAGING AND FLARING TOOLS FOR COPPER AND ALUMINUM TUBING

### High Temperature Operation

Preserves copper's/aluminum's malleability during the process

### Ideal for Ductless A/C and Mini Splits Applications

Designed for the most common tubing diameters in HVAC

### Maximum Performance and Lifespan

Designed to last longer than 4,000 times



[WWW.FLARINGSPIN.COM](http://WWW.FLARINGSPIN.COM)

[sales@migrare.com](mailto:sales@migrare.com)

Check out further details about SPIN features on our website



MIGRARE

WWW.FLARINGSPIN.COM

**FLARING SPIN**  
Deliver flares with more area of contact between the valve and the flare, avoiding cracks and leaks.



**FLARING SPIN SET FSPIN100**  
*Flaring Set with 4 tools*



**FLARING SPIN SET FSPIN300**  
*Flaring Set with 5 tools*



**SWAGING SPIN**  
For hard and soft copper tubing. Great Swaging Depth. Easier to Braze.



**SWAGING SPIN SET SSPIN100**  
*Swaging Set with 5 tools*



**SWAGING SPIN SET SSPIN300**  
*Swaging Set with 6 tools*

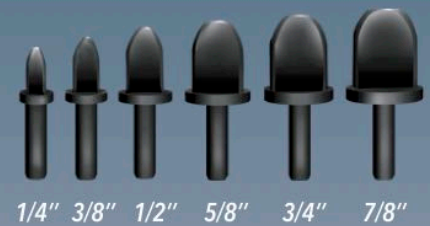

**NEW**

**SWAGING SPIN TOOL SSPIN378**  
**7/8"**



**IDEAL FOR DUCTLESS A/C & MINI SPLITS APPLICATIONS**

The Spin tools are compatible with high pressure evaporation and condensation systems, such as R410a Mini Split lines.



ACCESS OUR YOUTUBE CHANNEL AND CHECK FOR MORE INFORMATION ABOUT MIGRARE SPIN TOOLS  
[flaringspin.com/youtube](http://flaringspin.com/youtube)

**PATENT PENDING**



## SWAGING SPIN TOOL SSPIN300

### Product Documentation

Thank you for purchasing your new Swaging SPINs and welcome to the high temperature leakage-free flaring concept, designed from the ground up to HVAC systems.

The documentation for this product includes this User's Manual and the complementary Technical Documentation, available for download at [www.flaringspin.com](http://www.flaringspin.com). Complementary instructional videos are also available at [www.flaringspin.com/videos](http://www.flaringspin.com/videos).

For reaching maximum performance out of the use of your Swaging SPIN tool, carefully read these instructions and keep this manual for further reference.

### Packaging Content

The Swaging SPIN set SSPIN300 includes 6 Swaging Diameters:

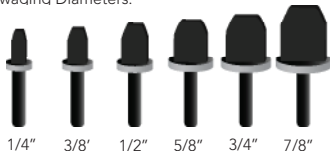

### Extra Features



**Up to 10x faster than conventional tools**



**Works either with a corded or a cordless drill\***



**No reaming process required\*\***

\*\*Cleaning the tubing is a standard procedure in any air conditioning system. The use of the SPIN Tools does not exclude the user from doing this procedure.

### Safety Information

Read and follow these instructions carefully:



The Swaging SPINs use a **HIGH TEMPERATURE** technology, due to friction between the metallic tube and the tool. For your safety, consider it **HOT** at all times.



Wait until the metallic tube and the tool to cool down before placing your hand onto the tube or the tool surface.



Always use protective gloves while working with the Swaging SPIN. **SFI LEVEL 10** protection gloves. Direct skin contact with the tube or the tool may result in serious injuries and burns.

Always keep the Swaging SPIN well attached and fastened into the power tool you are using (Corded Drills, Cordless drills).



Always use protective glasses while working with the Swaging SPIN. **ANSI Z87.1** eye protection (CAN/CSA Z94.3). Occasionally, chips may occur during the swaging process and may get to your eyes, causing severe injuries, burns or even loss of vision.

Do not use any loose clothing and jewelry or approach the tool with loose long hair during the operation of the tool, as it may entangle and get caught around it, causing serious personal injury.

Stay alert, watch what you are doing and use common sense when operating the Swaging SPIN. Do not use the Swaging SPIN while you are tired or under the influence of drugs, alcohol or medication. A moment of inattention while operating the Swaging SPIN may result in serious personal injury.

Store the tools out of the reach of children and do not allow people unfamiliar with the swaging tool or these instructions to operate the swaging tool.

## Instructions for Use

1. Make sure the tubing is firmly held at all times. You may use your other hand to do it. Keep a safe distance between your hand and the tube's border.

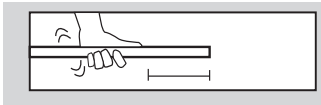

2. Fasten the Swaging SPIN correspondent to the tube diameter, into the drill/screwdriver's chuck, making sure it is not loose.

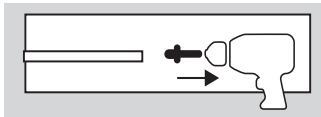

3. Make sure the HAMMERING MODE is OFF.

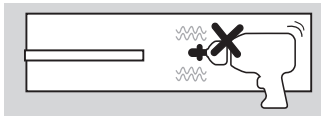

4. Turn ON, pull the trigger and keep the drill/screwdriver at MAXIMUM SPEED, at all time.

5. Keep the tube ALIGNED to the drill/screwdriver at all time and PUSH the Swaging SPIN all the way in, applying a CONSTANT PRESSURE, until the Stopper hits the tube.

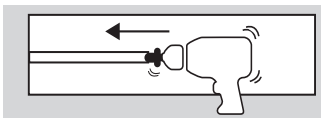

6. Keeping the tube ALIGNED to the drill/screwdriver and also keeping the drill/screwdriver at MAXIMUM SPEED, pull off the Swaging SPIN from inside the tube. Remember: the whole swaging process, in and out, shouldn't take more than 5 to 7 seconds.

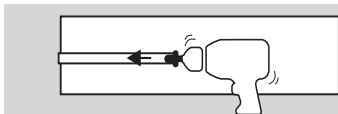

7. Right after the swaging process, the tube temperature is very high. Don't touch it. Wait the heat to dissipate before touching the swage.

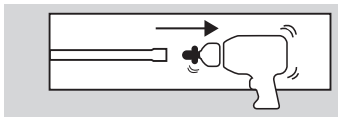

8. Assemble the fittings as usual.

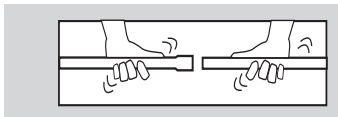

## \*Minimum Requirements

The SPIN tools are designed to work along with drills and/or screwdrivers, with minimum of 1,800 RPM and 500 watts for corded drills, or superior and 1,800RPM and 18V, or superior, for cordless drills.

Using the SPIN tools along with less powerful equipment may result in high decrease of performance.

### Customer Service

Cimport International LLC  
info@flaringspin.com  
+1-203-587-0336

[www.flaringspin.com](http://www.flaringspin.com)

