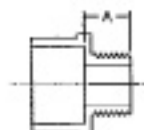

PVC Schedule 40 Pressure Fittings

ADAPTERS (Continued)

4604

Reducing Male Adapter (MIPT X Slip)

UNIV. FIG. NO.	NOM. SIZE	APPROX. NET WT./LBS.	DIM. A INCHES	
436-074	1/2 x 3/4	.039	7/8	
436-101	3/4 x 1/2	.029	7/8	
436-102	3/4 x 1	.064	15/16	
436-130	1 x 1/2	.046	1 1/8	
436-131	1 x 3/4	.049	1 3/32	
436-132	1 x 1 1/4	.099	1 1/8	
436-160	1 1/4 x 1	.112	1 1/8	
436-169	1 1/4 x 1 1/8	.157	1 3/16	
436-212	1 1/2 x 1 1/4	.107	1 1/8	
436-213	1 1/2 x 2	.173	1 1/8	
436-251	2 x 1 1/2	.154	1 1/8	
436-252	2 x 2 1/2	.525	1 1/8	

BUSHINGS

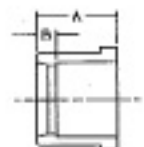
4618

Bushing (Spig x Slip)

UNIV. FIG. NO.	NOM. SIZE	APPROX. NET WT./LBS.	DIM. A INCHES	DIM. B INCHES
437-073	1/2 x 3/8	.010	15/16	1/4
437-101	3/4 x 1/2	.019	1 1/8	5/16
437-130	1 x 1/2	.040	1 1/8	1/2
437-131	1 x 3/4	.034	1 1/8	9/32
437-160	1 1/4 x 1/2	.085	1 1/8	11/16
437-167	1 1/4 x 3/4	.084	1 1/2	3/4
437-169	1 1/4 x 1	.061	1 1/8	13/32
437-209	1 1/2 x 1/2	.140	1 1/8	5/8
437-210	1 1/2 x 3/4	.114	1 1/2	17/32
437-211	1 1/2 x 1	.111	1 1/2	7/16
437-212	1 1/2 x 1 1/4	.057	1 1/2	1/4
437-247	2 x 1/2	.146	1 1/8	25/32
437-248	2 x 3/4	.200	1 1/8	13/16
437-249	2 x 1	.158	1 1/8	1/2
437-250	2 x 1 1/4	.170	1 1/8	5/16
437-251	2 x 1 1/2	.131	1 1/8	1/4
437-287	2 1/2 x 1/2	.320	1 1/8	1 1/8
437-288	2 1/2 x 3/4	.320	1 1/8	31/32
437-289	2 1/2 x 1	.330	1 1/8	27/32
437-290	2 1/2 x 1 1/4	.290	1 1/8	23/32
437-291	2 1/2 x 1 1/2	.330	1 1/8	19/32
437-292	2 1/2 x 2	.201	1 1/8	19/32

Do not use or test the products in this catalog with compressed air or other gases.