

www.zilmetusa.com

info@zilmetusa.com



LIST PRICE CATALOG

2020



ZILMET USA CORP • 400 FRENCHTOWN ROAD, EAST GREENWICH, RHODE ISLAND 02818
P:401-884-4943 • F:401-287-4951 • INFO@ZILMETUSA.COM • WWW.ZILMETUSA.COM

Zilmet is one of the oldest and largest expansion tank manufacturers in the world. Established in Italy in 1962, Zilmet is an international manufacturer of quality expansion vessels, pressure tanks and plate heat exchangers with several branches across the globe with worldwide distribution.

Zilmet is an ISO 9001 certified company that produces in excess of 7 million tanks and 1 million heat exchangers every year. We take great pride in our globally renowned quality and service and look forward to sharing our story and products with you and your customers.

With our North American Headquarters in East Greenwich, Rhode Island, Zilmet is proudly introducing new products for the hydronic, water system and solar industry into North America.



ZILMET HYDRO-PLUS (ZHP) Well Tanks	4
ZILMET HYDRO-PLUS (ZHPBC) Bottom Connection Well Tanks	5
ZILMET EASY PRO (ZEP) Thermal Expansion Tanks	6
ZILMET INOX PRO & ULTRA INOX PRO (ZS) Stainless Steel Expansion Tanks	7
ZILMET CAL PRO (ZHT)	
Hydronic Expansion Tanks	8
In-line Hydronic Radiant Tanks	9
ZILMET FLATS (ZFT) Flat Hydronic Expansion Tanks	9
ZILMET SOLAR TANKS and Accessories	10
ZILMET ULTRA PRO (ZUP) Potable Tanks with Replaceable Bladder	11
ZILMET EXPANSION TANK ACCESSORIES	12
ZIL-KIT BOILER TRIM KIT PACKAGE and Boiler Accessories	13
ZILMET INTAKLEAN® Magnetic Filter	17
ZILMET MAG PRO Magnetic Systems Hub	18
ZILMET MAG PRO PLUS Magnetic Systems Hub	19
ZILMET HEAT EXCHANGERS	
Plate and Frame	20
Brazed Plate	22
COMMERCIAL PRODUCTS	24
ASME RATED EXPANSION TANKS	
Zilmet Hydronic Expansion Tank with Replaceable Bladder (ZELA)	25
Zilmet Hydronic Expansion Tank with Fixed Diaphragm (ZETA)	26
Zilmet Thermal Expansion Tank with Replaceable Bladder (ZTXA)	27
Zilmet Thermal Expansion Tank with Fixed Diaphragm (ZTTA)	28
Zilmet Hydro-Pneumatic Tank with Replaceable Bladder (ZHXA)	29
Zilmet Hydro-Pneumatic Tank with Fixed Diaphragm (ZHXT)	31
ZILMET AIR AND DIRT SEPARATORS (ZADS)	32
ZILMET CHILLED WATER BUFFER TANKS (ZCBT) & HOT WATER BUFFER TANKS (ZHBT)	34
ZILMET HYDRAULIC SEPARATORS	35
ZILMET WARRANTY & Pallet Count List	36

ZILMET HYDRO-PLUS (ZHP) Well Tanks

NSF/ANSI 61



4

Stainless steel
side connection
allows for quicker,
less expensive
installation



IN LINE MODELS

Model Number:	Volume: (Gal)	Tank Weight: (Lbs)	Connection Size: (NPT)	Shipping Dimensions: (LxWxH)	System Drawdown: 30-50 (PSI) 40-60 (PSI)		UPC Code: (801985)	List Price: (US \$)
ZHP5	2.1	6	3/4"	13" x 9" x 9"	0.7	0.6	5010791	\$75.60
ZHP12	4.8	10	3/4"	16" x 11" x 11"	1.6	1.4	5011026	\$96.10
ZHP18	6.3	11	1"	18" x 12" x 13"	2.2	1.9	5011026	\$141.12
ZHP104IL	9.2	19	1"	16" x 16" x 18"	3.1	2.7	5010241	\$211.39
ZHP200IL	13.2	23	1"	16" x 16" x 23"	4.5	3.9	5010258	\$272.96

STAND MODELS

Model Number:	Volume: (Gal)	Tank Weight: (Lbs)	Connection Size: (NPT)	Shipping Dimensions: (LxWxH)	System Drawdown: 30-50 (PSI) 40-60 (PSI)		UPC Code: (801985)	List Price: (US \$)
ZHP200F	13.2	25	1"	16" x 16" x 23"	4.5	3.9	5010562	\$292.10
ZHP202	21.1	35	1"	18" x 18" x 26"	7.2	6.2	5010272	\$354.32
ZHP203	27.7	40	1-1/4"	21" x 20" x 28"	9.5	8.2	5010289	\$483.80
ZHP204	39.6	54	1-1/4"	20" x 20" x 37"	13.5	11.7	5010296	\$679.56
ZHP250	52.8	64	1-1/4"	24" x 24" x 34"	18.0	15.6	5010838	\$820.24
ZHP251	66	79	1-1/4"	25" x 25" x 40"	22.5	19.5	5010302	\$888.08
ZHP302	79.3	114	1-1/4"	25" x 25" x 47"	27.0	23.4	5010845	\$1,115.20
ZHP350	105.7	128	1-1/4"	25" x 25" x 61"	36.0	31.2	5010319	\$1,505.00
ZHP351	119	158	1-1/4"	31" x 31" x 46"	40.6	35.1	5046998	\$1,856.45
ZHP400	132.1	175	1-1/4"	30" x 28" x 55"	45.0	39.0	5010852	\$2,161.80
ZHP451	158.5	182	1-1/4"	30" x 30" x 64"	54.0	46.8	5010326	\$2,600.00

SPECIALTY TANKS

Model Number:	Volume: (Gal)	Tank Weight: (Lbs)	Connection Size: (NPT)	Shipping Dimensions: (LxWxH)	System Drawdown: 30-50 (PSI) 40-60 (PSI)		UPC Code: (801985)	List Price: (US \$)
ZHP202BV*	21.1	37	1"	18" x 18" x 26"	7.2	6.2	5010555	\$380.77
ZHP200BH**	13	20	1"	22" x 15" x 18"	4.5	3.9	5010265	\$317.73
ZHP202BH**	21.1	37	1"	18" x 18" x 26"	7.2	6.2	5010814	\$380.77
ZHP202SM	21.1	35	1"	18" x 18" x 26"	7.2	6.2	5010821	\$372.83

* vertical tank with welded pump mounting bracket

** horizontal tank with welded pump mounting bracket

Description:	Material:	Operating Conditions:	
shell	carbon steel +	max. operating pressure	150 psi
connection	stainless steel +	operating temperature	210 °F
diaphragm	butyl	factory precharge	38 psi
color	almond	warranty	5 years

+ internally coated with epoxy for potable water applications

TANK T WITH UNION



ZTT-1
1" connection
List Price: \$49.00



ZTT-2
1 1/4" connection
List Price: \$68.60

Model Number:	Length:	Item Weight:	Connections:	List Price: (US \$)
ZFLEX 1-12	12"	2 lbs	1" female	\$37.20
ZFLEX 1-18	18"	2 lbs	1" female	\$41.48
ZFLEX 2-18	18"	2 lbs	1 1/4" female	\$52.60

- please see page 12 for tank accessories

ZILMET HYDRO-PLUS (ZHPBC) Bottom Connection Well Tanks

NEW!

NSF/ANSI 61



5

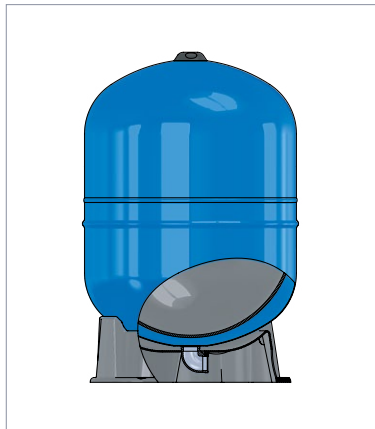

TECHNICAL FEATURES:

- 150 PSI Rated
- All Weather Epoxy-polyester powder coated paint
- Stainless steel elbow
- Polypropylene base for all weather applications
- 5 year manufacturer's warranty

Model Number:	Volume: (Gal)	Tank Weight: (Lbs)	Connection Size: (NPT)	Shipping Dimensions: (LxWxH)	System Drawdown 30-50 (PSI) 40-60 (PSI)		UPC Code: (801985)	List Price: (US \$)
ZHP202BC	21.1	26.2	1"	19" x 19" x 28"	7.2	6.2	5052586	\$425.60
ZHP202BV-BC	21.1	22.0	1"	19" x 19" x 28"	7.2	6.2	5054894	\$452.05
ZHP203BC	27.7	40.2	1 1/4"	21" x 21" x 30"	9.4	8.2	5054900	\$555.08
ZHP34BC	34.1	43.8	1 1/4"	21" x 21" x 35"	11.6	10.0	5055785	\$784.18
ZHP204BC	39.6	48.5	1 1/4"	21" x 21" x 40"	13.5	11.7	5052593	\$828.40
ZHP250BC	54.7	76.5	1 1/4"	21" x 21" x 51"	18.7	16.1	5055594	\$1,100.81
ZHP302BC	79.3	117.4	1 1/4"	26" x 26" x 48"	27.0	23.4	5055952	\$1,290.44
ZHP351BC	119.0	160.7	1 1/4"	26" x 26" x 67"	40.6	35.1	5055969	\$2,004.56

DIMENSIONAL DATA

Model Number:	Diameter inches (D)	Height Inches (H)	Base Diameter Inches (B)	Connection Height Inches (E)	Connection Size NPT (C)
ZHP202BC	17.7"	26.9"	16.8"	1.6"	1"
ZHP202BV-BC	17.7"	27.9"	16.8"	1.6"	1"
ZHP203BC	17.7"	29.2"	16.8"	1.6"	1 1/4"
ZHP34BC	19.7"	33.9"	16.8"	1.6"	1 1/4"
ZHP204BC	19.7"	38.3"	16.8"	1.6"	1 1/4"
ZHP250BC	19.7"	49.7"	16.8"	1.6"	1 1/4"
ZHP302BC	24.8"	46.9"	16.8"	2.1"	1 1/4"
ZHP351BC	24.8"	65.9"	16.8"	2.1"	1 1/4"

Description:

Material:

shell	carbon steel
connection	stainless steel
fixed membrane	butyl
material of base	polypropylene
tank color	blue
base color	grey

Operating Conditions:

max. operating pressure	150 psi
operating temperature	210 °F
factory precharge	38 psi
warranty	5 years

- please see page 12 for tank accessories

ZILMET EASY PRO (ZEP) Thermal Expansion Tanks



NSF/ANSI 61



6

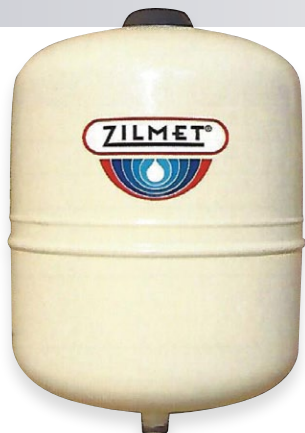

NEW! Stainless steel thermal expansion tanks for on demand and POU water heaters with up to 2 gal, 5 gal and 10 gal of total water volume

SPECIALTY TANKS: ZEP1 UPC Certified. ZEP2 and ZEP3 UPC Pending

Model Number:	Tank Weight: (Lbs)	Connection Size: (NPT)	Shipping Dimensions: (LxWxH)	Sized for up to: (Gal)	UPC Code: (801985)	List Price: (US \$)
ZEP1	.5	1/2"	3" x 3" x 3"	2	5054139	\$64.00
ZEP2	.8	1/2"	4" x 4" x 5"	5	5054139	\$110.00
ZEP3	1.7	1/2"	5" x 5" x 7"	10	5054139	\$126.00

IN LINE MODELS: All In Line tanks are UPC Certified

Model Number:	Volume: (Gal)	Tank Weight: (Lbs)	Connection Size: (NPT)	Shipping Dimensions: (LxWxH)	Acceptance Volume: (Gal)	UPC Code: (801985)	List Price: (US \$)
ZEP5	2.1	6	3/4"	13" x 9" x 9"	1.4	5041337	\$75.60
ZEP12	4.8	10	3/4"	16" x 11" x 11"	3.3	5041344	\$96.08
ZEP18	6.3	11	3/4"	18" x 12" x 13"	4.3	5041351	\$141.12
ZHP104IL	9.2	19	1"	16" x 16" x 18"	6.3	5010241	\$211.40
ZHP200IL	13.2	23	1"	16" x 16" x 23"	9	5010258	\$272.96

STAND MODELS

Model Number:	Volume: (Gal)	Tank Weight: (Lbs)	Connection Size: (NPT)	Shipping Dimensions: (LxWxH)	Acceptance Volume: (Gal)	UPC Code: (801985)	List Price: (US \$)
ZHP200F	13.2	23	1"	16" x 16" x 23"	9	5010562	\$299.18
ZHP200BH**+	13.2	23	1"	25" x 15.5" x 18"	9	5010562	\$299.18
ZHP202	21.1	35	1"	18" x 18" x 26"	14.4	5100272	\$375.90
ZHP202BH**+	21	35	1"	28" x 19" x 19"	14.4	5100272	\$375.90
ZHP203	27.7	40	1-1/4"	21" x 20" x 28"	18.9	5010289	\$538.65
ZHP204	39.6	54	1-1/4"	20" x 20" x 37"	27	5010296	\$762.09
ZHP250	52.8	64	1-1/4"	24" x 24" x 34"	36	5010838	\$883.43
ZHP251	66	79	1-1/4"	25" x 25" x 40"	44.9	5010302	\$1,029.00
ZHP302	79.3	114	1-1/4"	25" x 25" x 47"	54	5010845	\$1,243.20

**+ Horizontal model with pump bracket

Description:	Material:
shell	carbon steel
connection	stainless steel
diaphragm	butyl
color	almond

Operating Conditions:	
max. operating pressure	150 psi
operating temperature	210 °F
factory precharge	40 psi
warranty	5 years

ZEP1, ZEP2 and ZEP3 Material & Conditions:	
shell	stainless steel
color	stainless steel
max. pressure	150 psi
max. temperature	140 °F
factory precharge	50 psi
warranty	5 years

- please see page 12 for tank accessories

ZILMET INOX PRO & ULTRA INOX PRO (ZS) Stainless Steel Expansion Tanks

NSF/ANSI 61



7

All tanks
manufactured
with 304
Stainless Steel



**Zilmet Inox Pro
& Ultra Inox Pro (ZS)**

Models ZS8,
ZS12 and ZS18
are NSF61 Certified

IN LINE MODELS

INOX PRO

Model Number:	Volume: (Gal)	Tank Weight: (Lbs)	Connection Size: (NPT)	Shipping Dimensions: (LxWxH)	Acceptance Volume: (Gal)	UPC Code: (801985)	List Price: (US \$)
ZS160	0.04	0.5	1/4"	4" x 4" x 3"	N/A	N/A	\$91.38
ZS05	0.13	0.8	1/2"	4" x 4" x 5"	.1	5043355	\$114.65
ZS1	.26	1.7	1/2"	5" x 5" x 7"	.2	5043362	\$147.00
ZS2	.53	2	1/2"	6" x 6" x 8"	.3	5039945	\$163.75

IN LINE MODELS

Model Number:	Volume: (Gal)	Tank Weight: (Lbs)	Connection Size: (NPT)	Shipping Dimensions: (LxWxH)	Acceptance Volume: (Gal)	UPC Code: (801985)	List Price: (US \$)
ZS8	2.1	5	3/4"	9" x 9" x 12"	1.5	5038375	\$251.00
ZS12	3.2	6.8	3/4"	11" x 11" x 11"	3.2	5038498	\$480.34
ZS18	4.8	8.8	3/4"	11" x 11" x 15"	3.3	5043898	\$283.65
ZS24V*	6.3	11	1"	12" x 13" x 20"	4.9	5044796	\$719.85

* Vertical

STAND MODELS

ULTRA INOX PRO

Model Number:	Volume: (Gal)	Tank Weight: (Lbs)	Connection Size: (NPT)	Shipping Dimensions: (LxWxH)	Acceptance Volume: (Gal)	UPC Code: (801985)	List Price: (US \$)
ZS24H**+	6.3	13	1"	20" x 11" x 12"	4.9	5039983	\$726.07
ZS60V*+	15.9	33	1"	27" x 16" x 17"	12.3	5043348	\$1,515.18
ZS60H**+	15.9	31	1"	27" x 16" x 17"	12.3	5044772	\$1,533.78
ZS100V*+	26.4	42	1"	32" x 19" x 20"	20.4	5039631	\$2,322.77
ZS100H**+	26.4	44	1"	32" x 19" x 20"	20.4	5044789	\$2,335.02

* Vertical

**Horizontal

+ Includes welded pump bracket

Inox Pro Operating Conditions:

max. operating pressure ZS160	220 psi
max. operating pressure ZS05-ZS18	150 psi
operating temperature	14 °F - 210 °F
factory precharge .04 gal - .55 gal	50 psi
factory precharge 2.1 gal - 4.8 gal	36 psi
diaphragm	butyl
warranty	5 years

Ultra Inox Pro Operating Conditions:

max. operating pressure	150 psi
operating temperature	14 °F - 210 °F
factory precharge	22 psi
replaceable bladder	butyl
warranty	5 years

- please see page 12 for tank accessories

ZILMET CAL PRO (ZHT) Hydronic Expansion Tanks

8



Side connection
allows for quicker,
less expensive
installation



Side connection on stand models only

IN LINE MODELS

Model Number:	Volume: (Gal)	Tank Weight: (Lbs)	Connection Size: (NPT)	Shipping Dimensions: (LxWxH)	Acceptance Volume: (Gal)	UPC Code: (801985)	List Price: (US \$)
ZHT8-15	2.1	4.6	1/2"	9" x 9" x 13"	1.4	5044796	\$63.00
ZHT12	3.2	6.0	1/2"	12" x 12" x 12"	2.0	5039853	\$71.40
ZHT18-30	4.8	6.8	1/2"	12" x 12" x 16"	3.3	5039860	\$78.75
ZHT24-60	6.3	9.1	1/2"	13" x 13" x 17"	3.9	5038283	\$144.27
ZHT35	9.2	15.3	3/4"	16" x 16" x 17"	5.7	5039877	\$176.53
ZHT50-90	13.2	21.3	3/4"	16" x 16" x 22"	8.1	5038290	\$214.75

STAND MODELS

Model Number:	Volume: (Gal)	Tank Weight: (Lbs)	Connection Size: (NPT)	Shipping Dimensions: (LxWxH)	Acceptance Volume: (Gal)	UPC Code: (801985)	List Price: (US \$)
ZHT35F*	9.2	15.4	3/4"	16" x 16" x 17"	5.7	5042297	\$193.83
ZHT50F*	13.2	21.5	3/4"	16" x 16" x 22"	8.1	5042303	\$241.29
ZHT80	21.1	34	3/4"	18" x 18" x 25"	15.3	5038603	\$305.68
ZHT105	27.7	44	3/4"	20" x 21" x 27"	20.1	5039839	\$474.94
ZHT150	39.6	55	3/4"	21" x 21" x 37"	28.8	5039846	\$603.25
ZHT200	52.8	66	3/4"	24" x 24" x 33"	38.4	5039884	\$748.73
ZHT250	66	90.2	3/4"	25" x 25" x 40"	48.0	5039891	\$869.69
ZHT300	79.3	101.2	3/4"	26" x 26" x 46"	57.7	5039907	\$1,112.62
ZHT400	105.7	144.1	3/4"	26" x 26" x 61"	76.8	5038740	\$1,532.58
ZHT500	132.1	154	1"	30" x 30" x 55"	96.0	5039914	\$1,932.97
ZHT600	158.5	189.2	1"	30" x 30" x 62"	115.2	5038757	\$2,247.00
ZHT700	184.9	211.2	1"	30" x 30" x 70"	134.2	5039921	\$2,998.30

* with feet

Description:	Material:
shell	carbon steel
connections	carbon steel
diaphragm	SBR synthetic rubber
color	grey

For Hydronic Use Only

Operating Conditions:	
max. operating pressure 2.1 gal	75 psi
max. operating pressure 3.2-13.2 gal	60 psi
max. operating pressure 21-184 gal	90 psi
max. operating temperature	210 °F
factory precharge	12 psi
warranty	5 years

ZILMET FLATS (ZFT)

Flat Hydronic Expansion Tanks

9



The Space Saving Expansion Tanks

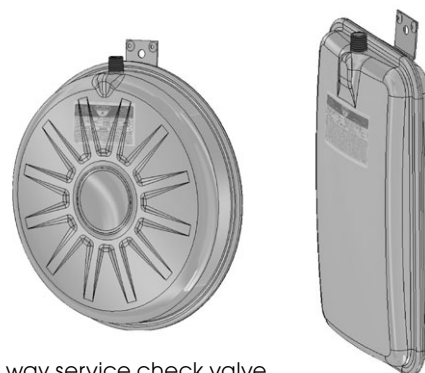

All tanks come with a fixed mounting bracket and a union connection with a two way service check valve

Model Number:	Volume: (Gal)	Tank Weight: (Lbs)	Connection Size: (NPT)	Shipping Dimensions: (LxWxH)	Acceptance Volume: (Gal)	UPC Code: (801985)	List Price: (US \$)
ZFT8C-15 *	2.1	10	1/2"	16" x 16" x 5"	1.1	5042501	\$121.79
ZFT18C-30*	4.8	15	1/2"	16" x 16" x 9"	2.4	5042594	\$139.74
ZFT8R-15**	2.1	10	1/2"	20" x 11" x 5"	1.1	5042587	\$134.64
ZFT18R-30**	4.8	20	1/2"	20" x 15" x 7"	2.7	5042600	\$220.32
ZFT24R-60**	6.3	21	1/2"	20" x 15" x 8"	3.9	5050322	\$280.24
ZFT-U	Union connection with a two way check valve						\$32.00

* round hydronic tank with union and mounting bracket

** rectangular hydronic tank with union and mounting bracket

Operating Conditions:

factory precharge	12 psi
max. working pressure ZFT8C, ZFT18C, ZFT8R	43.5 psi
max. working pressure ZFT18R, ZFT24R	51 psi
max. operating temperature	194° F
color	gray
warranty	5 years

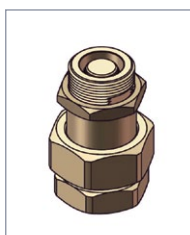

Tank union works on all 1/2" in line hydronic expansion tanks

ZFT-U:
Union connection
with a two way
check valve.



**Hanging
Bracket**

For Hydronic Use Only

ZILMET CAL PRO (ZHT) In-line Hydronic Radiant Tanks

Model Number:	Volume: (Gal)	Tank Weight: (Lbs)	Connection Size: (NPT)	Shipping Dimensions: (LxWxH)	Acceptance Volume: (Gal)	UPC Code: (801985)	List Price: (US \$)
ZHT-R15	2.1	5.0	1/2"	7.9" x 7.9" x 11"	1.4	5051725	\$110.76
ZHT-R30	4.8	9.2	1/2"	10.6" x 10.6" x 13.7"	3.3	5051732	\$124.20

Description:

Material:

shell	carbon steel
connection	stainless steel
fixed membrane	butyl
color	gray

Operating Conditions:

max. operating pressure	150 psi
operating temperature	210 °F
factory precharge	12 psi
warranty	5 years



TECHNICAL FEATURES:

- Designed for low temperature radiant floor systems
- All radiant tanks have a polypropylene liner to prevent corrosion due to oxygen entering the system
- All tanks come with a stainless steel connector
- Suitable for use with glycol

For Hydronic Use Only

ZILMET SOLAR PLUS (ZSP) Solar Expansion Tanks

ZILMET SOLAR TANKS and Accessories

10



SOLAR TANK MOUNTING BRACKETS

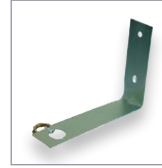

ZWH B: \$39.35

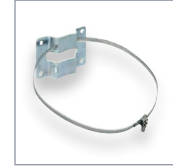

ZWH HP: \$42.15

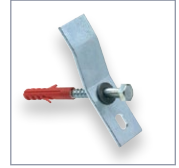

ZWH M: \$25.01

IN LINE MODELS

Model Number:	Volume: (Gal)	Tank Weight: (Lbs)	Connection Size: (NPT)	Shipping Dimensions: (LxWxH)	Acceptance Volume: (Gal)	UPC Code: (801985)	List Price: (US \$)
ZSP12	3.2	7.7	3/4"	11" x 12" x 13"	2.2	5040750	\$87.18
ZSP18	4.8	8.8	3/4"	11" x 16" x 12"	3.3	5038313	\$116.24
ZSP24	6.3	10.4	3/4"	12" x 13" x 17"	4.6	5038320	\$132.38

STAND MODELS

Model Number:	Volume: (Gal)	Tank Weight: (Lbs)	Connection Size: (NPT)	Shipping Dimensions: (LxWxH)	Acceptance Volume: (Gal)	UPC Code: (801985)	List Price: (US \$)
ZSP35*	9.2	18.7	3/4"	16" x 16" x 17"	6.4	5038337	\$202.67
ZSP50*	13.2	24	3/4"	16" x 16" x 23"	9.1	5038306	\$242.16
ZSP80	21.1	33	1"	26" x 20" x 20"	14.6	5038214	\$309.96
ZSP105	27.7	44	1"	21" x 20" x 27"	19.2	5038221	\$455.96
ZSP150	39.6	55	1"	21" x 21" x 37"	27.4	5038238	\$651.85
ZSP200	52.8	72.6	1"	24" x 24" x 34"	36.6	5038245	\$870.37
ZSP250	66.0	94.6	1"	26" x 26" x 40"	45.7	5041542	\$1,238.48
ZSP300	79.3	112.2	1"	26" x 26" x 48"	55	5038252	\$1,640.41
ZSP400	105.7	158.4	1"	26" x 26" x 61"	73.3	5041559	\$1,940.90
ZSP500	132.1	171.6	1"	31" x 31" x 57"	91.5	5038269	\$2,132.49
ZSP600	158.5	206.8	1"	31" x 31" x 64"	109.8	5042365	\$2,440.33

* with feet

Description:	Material:
shell	carbon steel
connections	carbon steel
fixed membrane	ZILAN membrane
color	White with epoxy powder coating

Operating Conditions:	
factory precharge	36 psi
max. working pressure	150 psi
max. operating temperature	230° F
warranty	5 years

VSG TANKS – Temperature reducing pre-vessel

Model Number:	Volume: (Gal)	Tank Weight: (Lbs)	Connection Size: (NPT)	Shipping Dimensions: (LxWxH)	UPC Code: (801985)	List Price: (US \$)
VSG5	1.3	3.3	3/4"	13" x 7" x 7"	5042723	\$74.20
VSG8	2.1	4.4	3/4"	9" x 9" x 13"	5042730	\$78.08
VSG12	3.2	6.82	3/4"	14" x 11" x 11"	5042747	\$90.58
VSG18	4.8	8.14	3/4"	16" x 11" x 11"	5045748	\$106.20
VSG35	9.2	17.16	3/4"	16" x 16" x 16"	5042754	\$153.22
VSG50	13.2	22	3/4"	17" x 17" x 22"	5045885	\$184.92
VSG105	27.7	39.16	1"	20" x 21" x 27"	5046844	\$347.53

For Hydronic Use Only

ZILMET ULTRA PRO

Potable Tanks with Replaceable Bladder

11



- These tanks offer unlimited service as the bladder is easily replaceable
- A full range of replaceable bladder expansion tanks ranging from 2 gallons up to 260 gallons

VERTICAL MODELS

Model Number:	Volume: (Gal)	Tank Weight: (Lbs)	Connection Size: (NPT)	Shipping Dimensions: (LxWxH)	Acceptance Volume: (Gal)	UPC Code: (801985)	List Price: (US \$)
ZUP8	2.1	2.6	3/4"	13.8" x 8.1" x 8.3"	1.5	5041566	\$69.06
ZUP12V	3.2	3.2	3/4"	11" x 12.6" x 11.1"	2.4	5041573	\$76.02
ZUP18V	5	3.8	3/4"	10.9" x 16.5" x 11"	3.7	5041580	\$85.14
ZUP24V	6.3	5.3	1"	19.4" x 11" x 11.3"	4.6	5041597	\$90.36
ZUP50V	13.2	9.9	1"	30.9" x 15.2" x 15.2"	9.7	5040668	\$313.14
ZUP60V	15.9	10.2	1"	34.3" x 15.4" x 15.8"	11.7	5041610	\$327.78
ZUP80V	21.1	11.6	1"	32.9" x 18.1" x 18.4"	15.5	5040767	\$397.56
ZUP100V	26.4	15.8	1"	38.2" x 18.1" x 18.4"	19.4	5041641	\$510.60
ZUP200V	52.8	36.5	1 1/2"	51.3" x 20.9" x 22.9"	38.8	5042013	\$836.94
ZUP300V	79.3	51	1 1/2"	24.8" x 24.8" x 55.7"	58.3	5042006	\$1,048.34
ZUP500V	132.1	79.7	1 1/2"	29.5" x 29.5" x 63.4"	97.2	5046462	\$1,722.72
ZUP750V	198.1	142.7	1 1/2"	29.5" x 29.5" x 83.7"	134	5046448	\$3,110.64
ZUP1000	264.2	208.7	1 1/2"	33.5" x 33.5" x 84.6"	154.2	5040491	\$6,263.88

HORIZONTAL MODELS

Model Number:	Volume: (Gal)	Tank Weight: (Lbs)	Connection Size: (NPT)	Shipping Dimensions: (LxWxH)	Acceptance Volume: (Gal)	UPC Code: (801985)	List Price: (US \$)
ZUP24H*	6.3	5.3	1"	10.6" x 11.4" x 19.1"	4.6	5038337	\$111.00
ZUP50H*	13.2	9.9	1"	15" x 16.1" x 22.1"	9.7	5038306	\$313.14
ZUP60H	15.9	10.2	1"	15" x 16.1" x 25.2"	11.7	5038214	\$327.78
ZUP80H	21.1	11.6	1"	17.7" x 18.9" x 25.2"	15.5	5038221	\$397.56
ZUP100H	26.4	15.8	1"	17.7" x 18.9" x 28.7"	19.4	5038238	\$510.60
ZUP200H	52.8	36.5	1 1/2"	21.7" x 22.8" x 38.8"	38.8	5038245	\$836.94
ZUP300H	79.3	51	1 1/2"	24.8" x 26" x 44.9"	58.3	5041542	\$1,060.14

* with feet

Description:	Material:
shell	carbon steel
connections	carbon steel
fixed membrane	butyl
color	blue

Operating Conditions:	
factory precharge	28 psi
max. working pressure	150 psi
max. operating temperature	210° F
warranty	5 years

TANK T KITS

**ZTK-1**

ZILMET TANK T KIT – No Lead Tank T Fitting Package with ZTT-1 for 1" connection.

List Price: **\$115.34**

ZTK-2

ZILMET TANK T KIT – No Lead Tank T Fitting Package with ZTT-2 for 1 1/4" connection.

List Price: **\$134.34**

Package Contains:

- No Lead Brass Tank T with Swivel Union Nut
- 40/60 Pressure Switch
- No Lead Pressure Gauge 0-100 psi
- 1/4" NPT X 3" No Lead Brass Nipple
- 1/2 NPT No Lead Brass Boiler Drain with Hose Bibb
- 1/2" No Lead Pressure Relief Valve

TANK T WITH UNION

**ZTT-1**

1" connection size

List Price: **\$49.00**

**ZTT-2**

1 1/4" connection size

List Price: **\$68.60**

STAINLESS STEEL FLEX CONNECTOR



Our new connector allows for easier and faster installation in tank replacement applications

Model Number:	Length:	Item Weight:	Connections:	List Price: (US \$)
ZFLEX 1-12	12"	2 lbs	1" female	\$37.20
ZFLEX 1-18	18"	2 lbs	1" female	\$41.48
ZFLEX 2-18	18"	2 lbs	1 1/4" female	\$52.60

MOUNTING BRACKETS FOR TANKS UP TO 6.3 GAL



ZWH B: **\$39.35**



ZWH HP: **\$42.15**

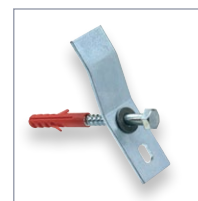

ZWH M: **\$25.01**

Ultra Pro/Inox Pro Replacement Membranes

List Price:
(US \$)

Replacement membrane for 24L Ultra Pro Tank	\$341.80
Replacement membrane for 60-80L Ultra Pro Tank	\$385.20
Replacement membrane for 100L Ultra Pro Tank	\$424.40
Replacement membrane for 200L Ultra Pro Tank	\$786.00
Replacement membrane for 300L Ultra Pro Tank	\$980.80
Replacement membrane for 500L Ultra Pro Tank	\$1,598.24
Replacement membrane for 750-1000L Ultra Pro tank	\$1,960.60

UNION CONNECTION

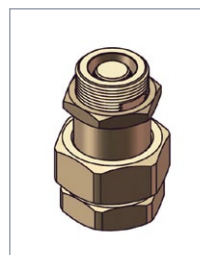

Union connection with a two way check valve for hydronic use only

ZFT-U: **\$32.00**

THE **ALL NEW** BOILER TRIM KIT PACKAGE

This new kit enables the installer to carry the essential components for a heating system in one compact carton.

Available in NPT and SWT connections

The assembly includes:

- 4.8 gal hydronic expansion tank
- Microbubble deaerator
- Multi isolation valve
- Back flow prevention device
- Boiler fill valve
- Brass connector nipples (2)

FEATURES AND BENEFITS:

- 4.8 gal hydronic expansion tank included in package
- NPT and SWT connections
- All in one package solution
- Multi isolation valve
- Drain off outlet for easy system servicing
- Microbubble deaerator
- For use with up to 50% glycol max



PRODUCT RANGE AND DIMENSIONS

Model Number:	Weight: (Lbs)	Connection Size:	Shipping Dimensions: (LxWxH)	UPC Code: (801985)	List Price: (US \$)
ZBTK01N	20	¾" NPT	12.5" x 12.5" x 22"	5055181	\$660.00
ZBTK02N	20	1" NPT	12.5" x 12.5" x 22"	5055198	\$700.00
ZBTK03N	20	1 ¼" NPT	12.5" x 12.5" x 22"	5055204	\$740.00
ZBTK01S	20	¾" SWT	12.5" x 12.5" x 22"	5055211	\$700.00
ZBTK02S	20	1" SWT	12.5" x 12.5" x 22"	5055228	\$740.00
ZBTK03S	20	1 ¼" SWT	12.5" x 12.5" x 22"	5055235	\$780.00

NEW!**MICROBUBBLE DEAERATOR**

Zilmet Microbubble Deaerator is designed to vent trapped air within sealed systems at pressures up to 150 PSI. This helps to maintain optimum system efficiency, improves energy usage, reduces system corrosion, eliminates noise from system pipe work and helps to extend the working life of system heat pumps

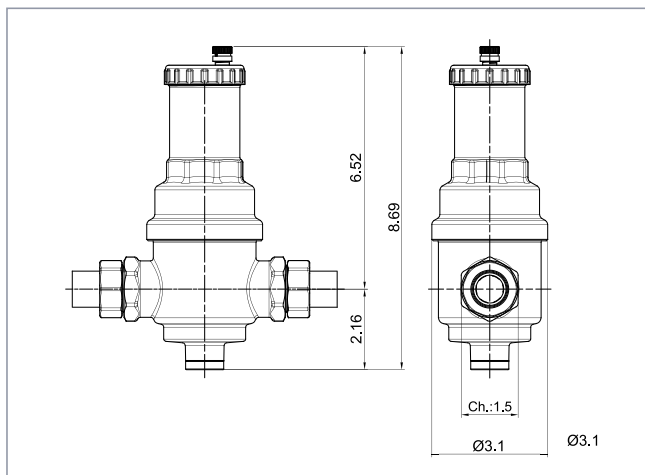
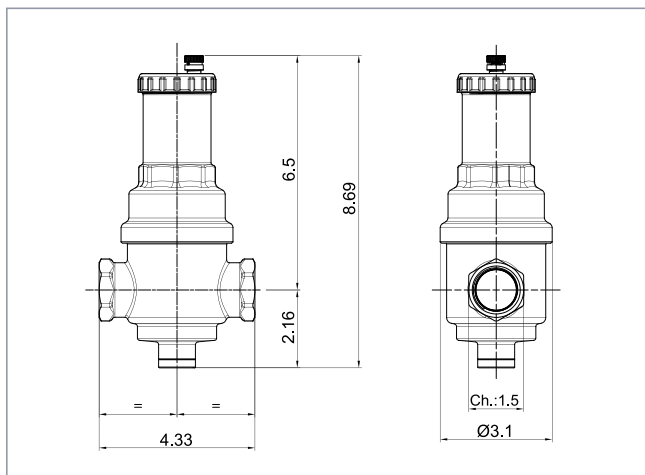

Model Number:	Product Range Description:	UPC Code: (505514)	List Price: (US \$)
ZU0001	¾" Microbubble Deaerator NPT	3759273	\$240.00
ZU0002	1" Microbubble Deaerator NPT	3759280	\$264.00
ZU0003	1 ¼" Microbubble Deaerator NPT	3759297	\$380.00
ZU0004	¾" Microbubble Deaerator SWT	3759303	\$256.00
ZU0005	1" Microbubble Deaerator SWT	3759310	\$276.00
ZU0006	1 ¼" Microbubble Deaerator SWT	3759327	\$435.00

Operating Conditions:

max. operating pressure	150 psi
max. temperature	230 °F
inlet connections	¾" NPT, 1" NPT, 1 ¼" NPT ¾" SWT, 1" SWT, 1 ¼" SWT

NEW!

BOILER FILL VALVE

Zilmet Boiler Fill Valve is a crucial part of a boiler trim kit. Designed as an automatic filling unit which reintegrates fluid into the closed systems in the event of lost fluid deaeration (process produces steam/ gas mixture that develops continuously in closed looped heating circuits)



FEATURES AND BENEFITS:

- Isolation valve standard
- Easy to use “dial up” adjustment head
- Internal check valve prevents the return of potentially contaminated fluid

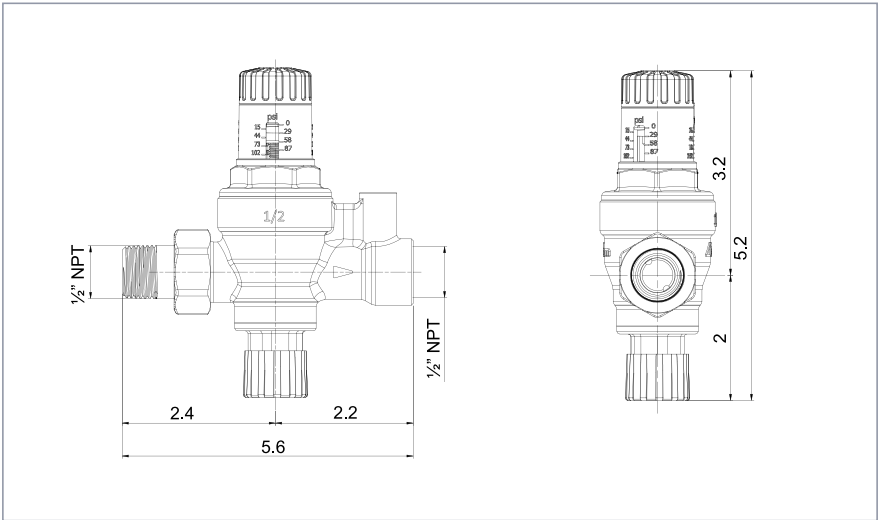

Model Number:	Product Range Description:	UPC Code: (505514)	List Price: (US \$)
ZU0007	1/2" Boiler Fill Valve	3759334	\$153.00

Operating Conditions:	
max. operating pressure	150 psi
max. temperature	230 °F
inlet connection	1/2" NPT
adjustment range	7.5 to 100 PSI

NEW!**BACKFLOW PREVENTION DEVICE**

The Zilmet Backflow Prevention Device is designed to prevent potentially polluted heating system fluid back flowing into the domestic water system

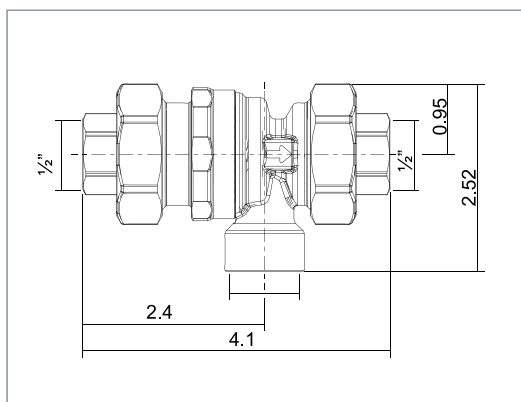
**FEATURES AND BENEFITS:**

- Drainage point to visibly identify system operating faults
- Internal stainless steel filter
- NPT or SWT connection options available
- Robust brass construction

Model Number:	Product Range Description:	UPC Code: (505514)	List Price: (US \$)
ZU0008	1/2" Backflow Prevention Device NPT	3759341	\$126.40
ZU0009	1/2" Backflow Prevention Device SWT	3759358	\$135.20

Operating Conditions:

max. operating pressure	175 psi
max. temperature	32 °F to 210 °F
inlet connection	1/2" NPT, 1/2" SWT

MULTI ISOLATION VALVE

Zilmet Multi Isolation Valve is the ultimate valve for complete fluid control. The valve allows complete isolation for the inlet flow, expansion vessel and live system providing the ideal component for boiler trim kit assemblies

**FEATURES AND BENEFITS:**

- System pressure gauge supplied as standard
- Multiple isolation points
- Anti-tamper locking handle
- Drain port as standard

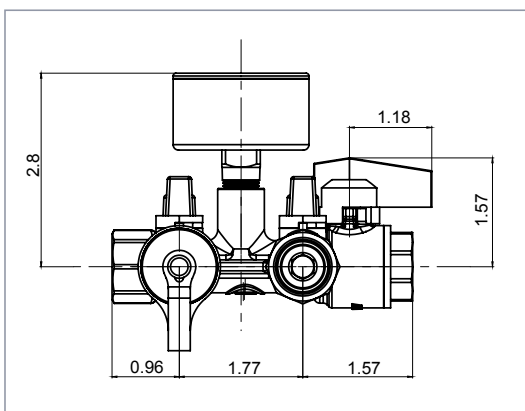

Model Number:	Product Range Description:	UPC Code: (505514)	List Price: (US \$)
ZU0020	Multi Isolation Valve NPT	3759372	\$116.00

Operating Conditions:

max. operating pressure	150 psi
-------------------------	---------

ZILMET INTAKLEAN²

Multifunction Magnetic Dirt Separator Filter **NEW!**

17

intaKlean²

MULTIFUNCTION MAGNETIC DIRT SEPARATOR FILTER FOR HYDRAULIC CIRCUITS

Zilmet IntaKlean is the best solution in solving plant problems due to the presence of particles caused by corrosion and scale during normal system operation. The magnetic filter effectively collects all the impurities present in the circuit and prevents them from circulating within it. All the magnetic contaminants (ferrous residues) and non-magnetic (algae, sludge, sand etc.) are then easily removed by simply opening the drain plug. The device protects the boiler continuously, avoiding wear and damage of all system components.



TECHNICAL FEATURES:

- It can be mounted on vertical, horizontal and diagonal piping
- All impurities are removed helping to increase the working life of the boiler
- Maintains optimum system efficiency by fighting corrosion
- Easy to clean
- Easy 32 ounce dosing of the treatment fluids
- 5 year manufacturer's warranty

PRODUCT RANGE AND DIMENSIONS

Model Number:	Weight: (Lbs)	Connection Size: (NPT)	Shipping Dimensions: (LxWxH)	C (Inches)	D (Inches)	E (Inches)	UPC Code: (505514)	List Price: (US \$)
IK203	5	¾"	12" x 12" x 8"	9.4"	7.5"	6.1"	3758801	\$320.00
IK210	5	1"	12" x 12" x 8"	10.0"	7.5"	6.1"	3758818	\$405.00
IK211	5	1 ¼"	12" x 12" x 8"	10.1"	7.5"	6.1"	3758825	\$437.80

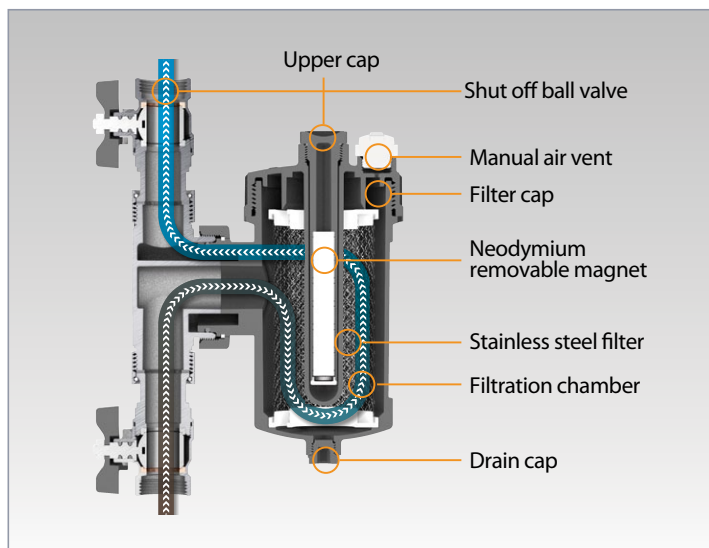
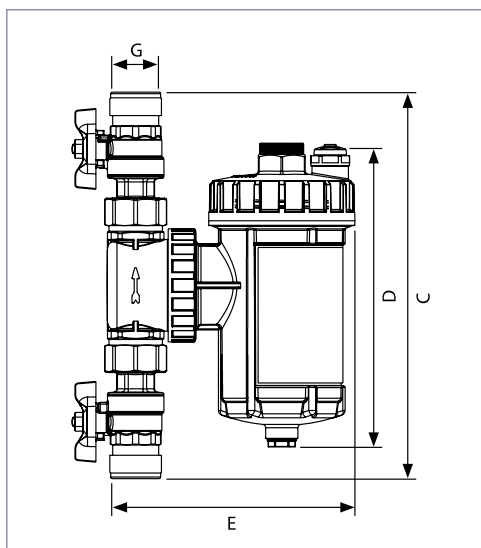

For Hydronic Use Only

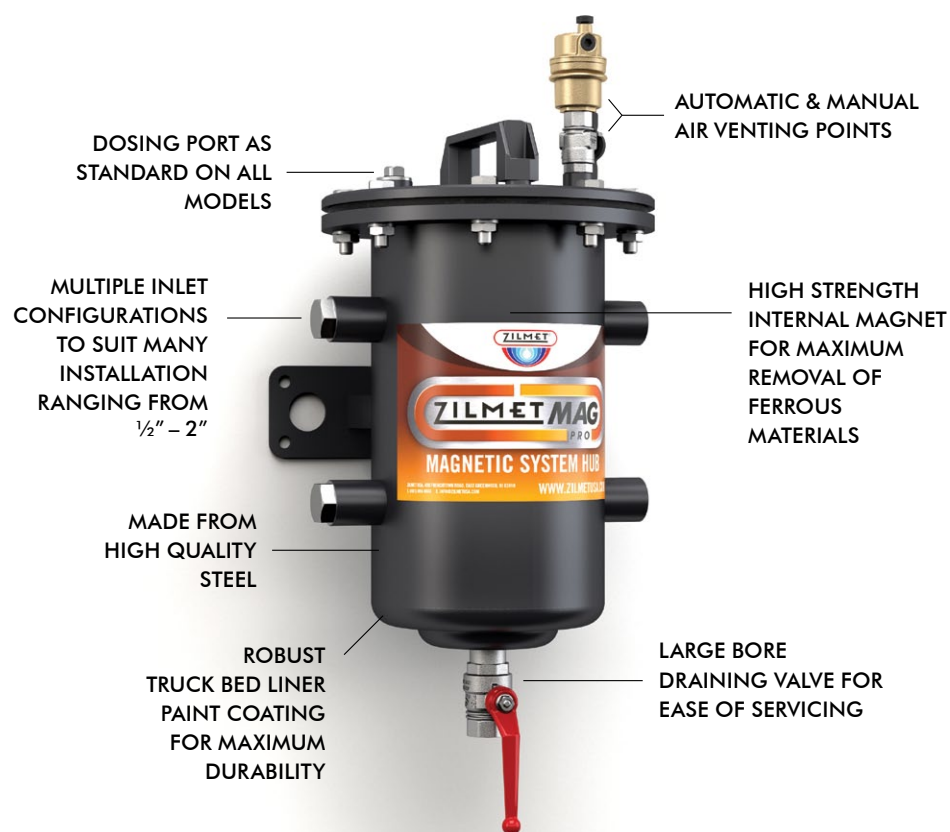

TECHNICAL FEATURES:

- Various inlet connection sizes ranging from ½" NPT to 2" NPT
- Quick and efficient servicing schedule
- Self closing filter basket for easy debris removal
- Multiple inlet configurations to suit many installations
- Manual and automatic air venting
- Mesh particle filtration down to 100 Microns
- 5 year manufacturer's warranty

ZILMET MAG

Model Number:	Weight: (Lbs)	Connection Size: (NPT)	Shipping Dimensions: (LxWxH)	List Price: (US \$)
ZM02	30	½"	19" x 13" x 12"	\$2652.00
ZM03	30	¾"	19" x 13" x 12"	\$2796.00
ZM10	30	1"	19" x 13" x 12"	\$2928.00
ZM11	30	1 ¼"	19" x 13" x 12"	\$3192.00
ZM12	30	1 ½"	19" x 13" x 12"	\$3632.00
ZM20	30	2"	19" x 13" x 12"	\$3968.00

ZILMET MAG ACCESSORY PACKS

Model Number:	Weight: (Lbs)	Connection Size: (NPT)	Shipping Dimensions: (LxWxH)	List Price: (US \$)
ZMA02	30	½"	19" x 13" x 12"	\$181.36
ZMA03	30	¾"	19" x 13" x 12"	\$216.52
ZMA10	30	1"	19" x 13" x 12"	\$258.68
ZMA11	30	1 ¼"	19" x 13" x 12"	\$313.28
ZMA12	30	1 ½"	19" x 13" x 12"	\$394.20
ZMA20	30	2"	19" x 13" x 12"	\$524.92

For Hydronic Use Only

Technical Specification	
max. operating pressure	145 psi
max. temperature	230 °F
degree of filtration	100 Micron
Inlet connection NPT	½", ¾", 1", 1 ¼", 1 ½", 2"



ZILMET MAG Accessories Pack Include:

- 1 Dosing Tundish
- 2 Ball valves of appropriate size
- 1 Dosing isolation valve

ZILMET MAG PRO PLUS

Magnetic System Hub for Commercial and Industrial Systems

NEW!

19

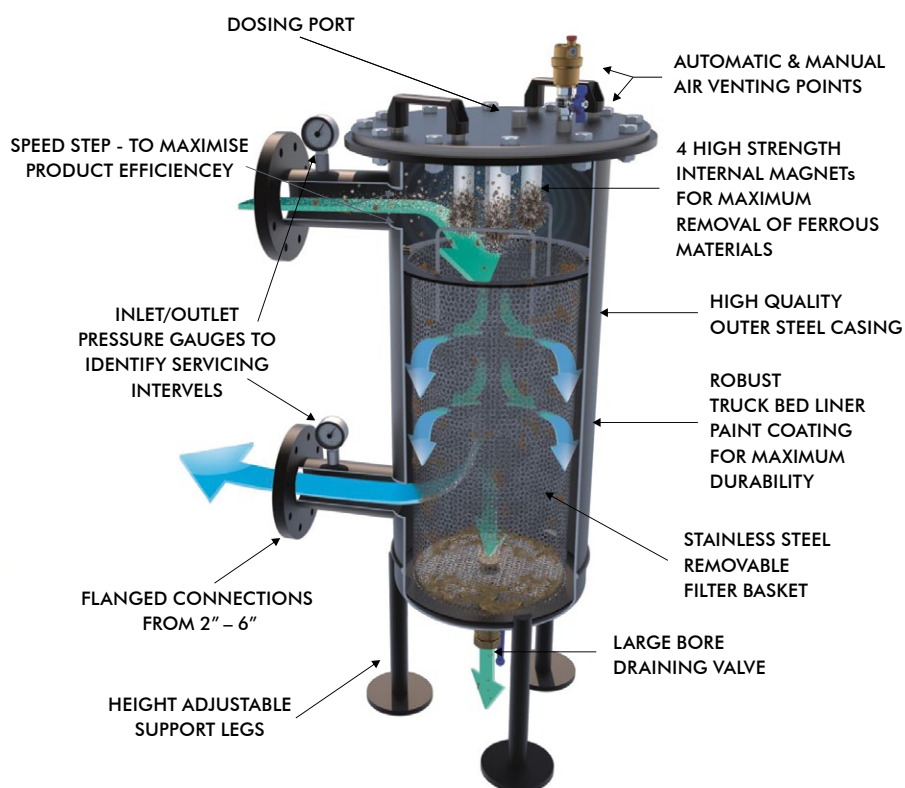

ZILMET MAG PRO PLUS

Model Number:	Weight: (Lbs)	Connection Size: (Flanged)	Shipping Dimensions: (LxWxH)	List Price: (US \$)
ZMPP20	115	2"	44" x 18" x 23"	\$9,512.00
ZMPP22	115	2 ½"	44" x 18" x 23"	\$10,160.00
ZMPP30	115	3"	44" x 18" x 23"	\$11,420.00
ZMPP40	115	4"	44" x 18" x 23"	\$12,840.00
ZMPP50	115	5"	44" x 18" x 23"	\$16,948.00
ZMPP60	115	6"	44" x 18" x 23"	\$19,060.00

For Hydronic Use Only

Technical Specification

max. operating pressure	145 psi
max. temperature	203 °F
Inlet Connection	2" to 6" Flanged
manufacturers warranty	5 years

GENERAL INFORMATION:

- Applications: The Zilmet plate heat exchanger has many applications. These include: production of sanitary hot water, decoupling of thermal circuits, district heating systems, recovery of heat coming from industrial process, cooling or heating of alimentary fluids (milk, beer, wine, etc), cooling of industrial machineries, heating of water for swimming pools and solar systems.
- Advantages: In every situation which requires a thermal exchange between two fluids, Zilmet plate heat exchangers are the right choice. The high efficiency, the long life, the low price, the small dimensions, the high modularity, the easy maintenance and the high reliability are some of the most important advantages of Zilmet plate heat exchangers.



TECHNICAL FEATURES:

- Plates: The plates are manufactured with 316 L stainless steel .0197 inches thick. This kind of material and thickness allows a smooth and quick transition to assure great corrosion resistance.
- Gaskets: Zilmet plate heat exchangers are equipped with glued EPDM gaskets with a maximum working temperature of 284 F. For particular applications, such as gasoline and oils, they can be equipped on request with nitril glued gaskets, for a maximum working temperature of 230 F.
- Frames: The frames are manufactured with silver painted carbon steel. The thickness is designed for the respective working pressure.
- Tests: 100% of Zilmet plate heat exchangers are tested before shipment at 1.5 times the maximum working pressure.
- **Custom heat exchangers are available upon request. Please contact us for custom pricing.**

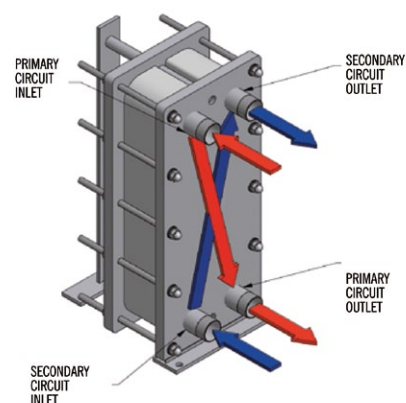
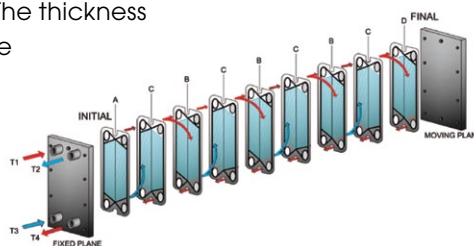

ZILMET PLATE AND FRAME Heat Exchanger

21

			Z2/10	Z2/16	Z3/10	Z3/16	Z4/16
Frame	Length	in	7,09	7,09	13,38	13,38	14,57
	Height	in	18,90	18,90	30,71	30,71	40,94
	Thickness	in	0,47	0,55	0,98	1,18	1,38
Plates	Exchange surface	in ²	52,70	52,70	201,50	201,50	341,00
	Thickness	in	0,02	0,02	0,02	0,02	0,02
Tie rods	Length (nr of plates)	in	4,72(7-13)	4,72 (7-13)	13,78 (7-49)	13,78 (7-51)	19,68 (21-73)
			5,90 (15-21)	5,90 (15-21)	21,65 (51-75)	21,65 (53-75)	39,37 (>75)
			9,45 (23-35)	9,45 (23-35)	25,59 (77-101)	25,59 (77-101)	
			11,81 (37-45)	11,81 (37-55)			
Guide Carrying bars	Length (nr of plates)	in	4,92 (7-13)	4,92 (7-13)	13,78 (7-49)	13,78 (7-51)	19,68 (21-73)
			5,71 (15-21)	5,71 (15-21)	21,65 (51-75)	21,65 (53-75)	39,37 (>75)
			9,84 (23-35)	9,84 (23-35)	25,59 (77-101)	25,59 (77-101)	
			11,81 (37-45)	11,81 (37-55)			
	Standard connections	in	1" F	1" F	2" M inox 304	2" M inox 304	3" F
	Connection distance	in	14,57/2,56	14,57/2,56	23,78/5,71	23,78/5,71	33,46/6,61
	Distance between the plates	in	0,12	0,12	0,13	0,13	0,14
	Approximate weights	Lb	35,93+0,59 x n°P	40,78+0,59 x n°P	220,46+1,76 x n°P	264,55+1,76x n°P	462,97+2,64 x n°P
	Nominal pressure	psi	145	232	145	232	232
	Test pressure	psi	217,5	348	217,5	348	348
	Max. working temperature (with standard EPDM gaskets)	°F	284	284	284	284	230
	Max. working temperature (with NBR gaskets)	°F	230	230	230	230	230

Custom sizes and configurations available upon request.

– Please call for pricing **401.884.4943**

HEATING SYSTEMS AND GENERAL APPLICATION

Zilmet heat exchangers, made of high quality 316 stainless steel and pure copper are particularly suitable to a wide variety of applications, including:

- Boiler components
- Hot water production with tank, Hot water immediate production
- Traditional boiler heating
- Pool heating
- Thermal circuits decoupling
- District heating
- Solar system

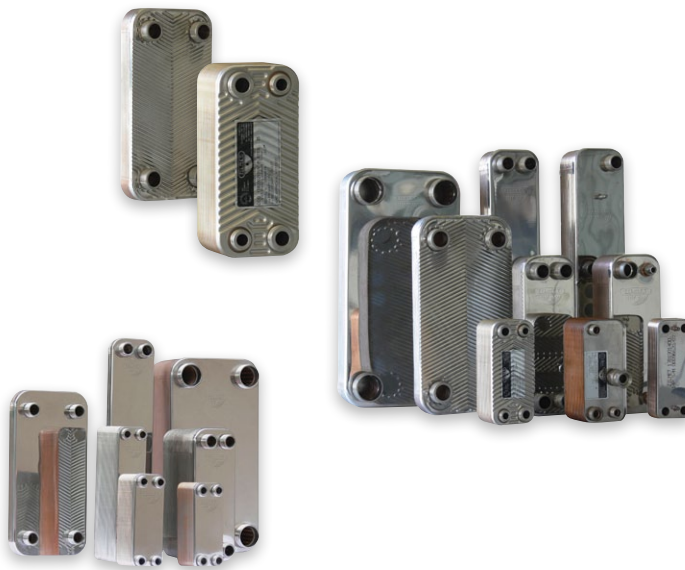

- Full line available
- Ideal for hydronic and refrigeration use

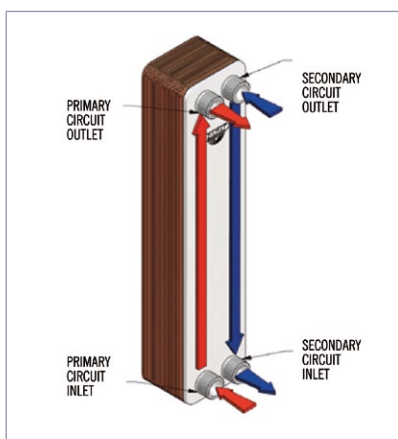

REFRIGERATION/AIR CONDITIONING FIELD

Zilmet has recently extended its range of brazed plate heat exchangers introducing a range of products dedicated to the refrigeration and air conditioning area. The new series has been designed and built for evaporation and condensing units; they are also compatible with various types of refrigerants, including high-pressure ones such as 'R410A'.

Please contact us for more information on these refrigeration heat exchangers.

Zilmet heat exchangers are in full compliance with all safety and functionality requirements of Directive 97/23 / EC on pressure equipment.

Custom sizes and configurations available upon request.

ZILMET BRAZED PLATE Heat Exchanger

23

Model Number:	Weight: (Lbs)	Connection Size: (NPT)	List Price: (US \$)
ZB190 – 20 plates	2.4	3/4"	\$352.10
ZB207 – 14 plates	1.8	3/4"	\$391.14
ZB207 – 20 plates	2.4	3/4"	\$462.10
ZB207 – 30 plates	3.5	3/4"	\$550.17
ZB207 – 36 plates	4.1	3/4"	\$582.26
ZB207 – 40 plates	4.6	3/4"	\$633.96
ZB315 – 10 plates	2.3	3/4"	\$625.86
ZB315 – 16 plates	3.2	3/4"	\$696.38
ZB315 – 20 plates	3.9	3/4"	\$758.79
ZB315 – 24 plates	4.6	3/4"	\$814.37
ZB315 – 30 plates	5.5	3/4"	\$906.71
ZB315 – 40 plates	7.2	3/4"	\$1,057.19

Description:	Material:
Shaped plates material	Stainless Steel AISI 316L
Brazing material	99% Copper
Connection material	Stainless Steel AISI 316L

Operating Conditions:	
Max working pressure primary circuit	72.5 PSI
Max working pressure secondary circuit	145 PSI
Max operating temperature	14°F / 248°F

Model Number:	Weight: (Lbs)	Connection Size: (NPT)	List Price: (US \$)
ZB250 – 20 plates	8.4	1"	\$780.24
ZB250 – 30 plates	11.0	1"	\$962.73
ZB250 – 40 plates	13.7	1"	\$1,169.19
ZB250 – 50 plates	16.3	1"	\$1,390.64
ZB250 – 60 plates	19	1"	\$1,594.58
ZB250 – 70 plates	21.6	1"	\$1,719.41
ZB250 – 90 plates	26.9	1"	\$2,210.58
ZB500 – 20 plates	14.6	1"	\$1,184.45
ZB500 – 30 plates	19.6	1"	\$1,518.80
ZB500 – 40 plates	24.5	1"	\$1,848.45
ZB500 – 60 plates	34.4	1"	\$2,512.21
ZB450 – 40 plates	48.6	2"	\$2,649.56
ZB450 – 50 plates	58.4	2"	\$3,058.92
ZB450 – 70 plates	78.2	2"	\$3,616.16

Description:	Material:
Shaped plates material	Stainless Steel AISI 316L
Brazing material	99% Copper
Connection material	Stainless Steel AISI 316L

Operating Conditions:	
Max working pressure primary circuit	435 PSI
Max working pressure secondary circuit	435 PSI
Max operating temperature	-58°F / 392°F

– Please call for pricing **401.884.4943**

STANDARD ON ALL ASME RATED EXPANSION TANKS:



- 1 Pressure Gauge included and integrated
- 2 Bladder integrity monitor included
 - Allows for fast, accurate assessment of the tanks integrity. The indicator will change color from white to red in case of a compromised bladder or diaphragm
- 3 Easy Access Air Vent at work level on the side of the tank
- 4 Protective guard mount for gauges to prevent any damage when shipping and installing
- 5 Higher factory pre-charge (at 40 psi) so it can be easily dropped down in the field as needed
- 6 UPGRADE OPTION: Patented Smart-Tank Monitor
 - Capacitive Dry Sensor that detects movement inside the tank
 - If bladder/diaphragm extends beyond normal movement, the monitor will activate an audible and visual LED alarm to notify maintenance staff of a potential system issue

Zilmet offers a full line of ASME rated expansion tanks for all applications. These tanks have recently been redesigned to include some new features and benefits that make servicing and installing much easier. The design and construction is manufactured to conform to ASME Section VIII, Div I.

High Pressure:	Multiplier to Net Price:
150	standard rating
200	150%
250	175%
300	250%
400	325%
500	400%

OTHER ASME ACCESSORIES AND UPGRADES INCLUDE:

- Seismic Restraints
- Saddles to mount the tank horizontally
- Clips to secure a tank into place
- Available in 304 Stainless Steel
- Available in 312 Stainless Steel
- Smart Tank Monitor

Zilmet Hydronic Expansion Tank with Replaceable Bladder (ZELA) ASME Rated Expansion Tank

25

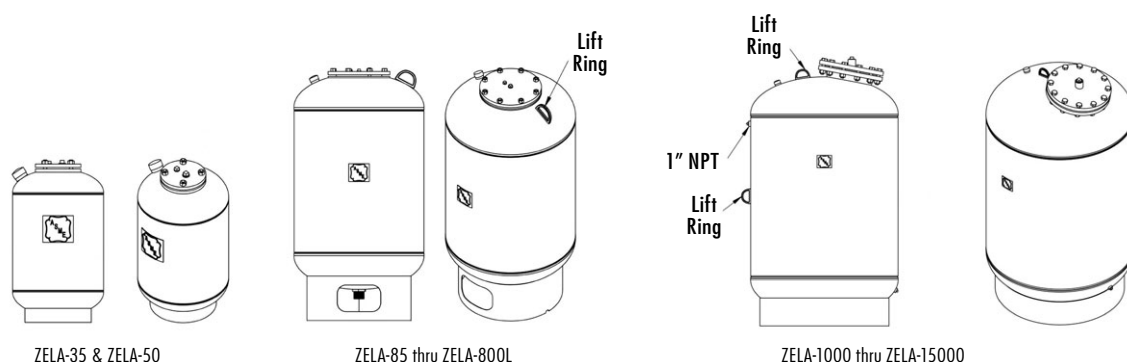

Model Number:	Volume: (Gal)	Tank Weight: (Lbs)	Connection Size: (NPT)	Shipping Dimensions: (LxWxH)	List Price: (US \$)
ZELA-35	10	40	3/4"	12" x 12" x 23.5"	\$2,795.84
ZELA-50	13	50	3/4"	14" x 14" x 24"	\$3,079.48
ZELA-85	23	90	1"	16" x 16" x 37"	\$3,700.78
ZELA-130	35	125	1"	20" x 20" x 37"	\$4,754.29
ZELA-200	53	210	1 1/2"	24" x 24" x 43"	\$5,503.90
ZELA-300	79	225	1 1/2"	24" x 24" x 55"	\$6,030.65
ZELA-400	106	300	1 1/2"	30" x 30" x 49"	\$6,158.96
ZELA-500	132	335	1 1/2"	30" x 30" x 57"	\$6,489.87
ZELA-600	158	360	1 1/2"	30" x 30" x 65"	\$9,582.86
ZELA-800L	211	475	1 1/2"	32" x 32" x 76"	\$10,589.09

Model Number:	Volume: (Gal)	Tank Weight: (Lbs)	Connection Size: (NPT)	Shipping Dimensions: (LxWxH)	List Price: (US \$)
ZELA-1000	264	710	1 1/2"	36" x 36" x 75"	\$12,979.74
ZELA-1200	317	720	1 1/2"	36" x 36" x 87"	\$13,574.03
ZELA-1400	370	875	1 1/2"	36" x 36" x 99"	\$14,776.10
ZELA-1600	422	1100	1 1/2"	48" x 48" x 74"	\$20,347.53
ZELA-2000	528	1280	1 1/2"	48" x 48" x 87"	\$22,319.48
ZELA-2500	660	1435	2"	48" x 48" x 95"	\$29,186.86
ZELA-3000L	792	1550	2"	48" x 48" x 122"	\$36,756.57
ZELA-3000S	792	2169	2"	60" x 60" x 80"	\$51,182.86
ZELA-4000	1056	2638	2"	60" x 60" x 102"	\$54,874.86
ZELA-5000	1320	3246	2"	60" x 60" x 125"	\$57,274.29
ZELA-7500	1980	4005	3"	72" x 72" x 127"	\$92,901.71
ZELA-10000	2640	4845	3"	72" x 72" x 159"	\$108,590.86
ZELA-15000	3963	5925	3"	72" x 72" x 233"	\$165,865.14

Description:	Material:
shell	carbon steel
connection	carbon steel
bladder	heavy duty butyl

- The design and construction is manufactured to conform to ASME Section VIII, Div I

Operating Conditions:	
precharge of	40 psi
max. operating pressure	125 PSIG*
max. operating temperature	240 °F
warranty	1 year

*200 & 250 PSIG available

Available Upon Request:

- Stainless steel ASME tanks (304 and 316 stainless)
- Seismic restraints
- Ratings for: 200 and 250 PSI

Zilmet Hydronic Expansion Tank with Fixed Diaphragm (ZETA) ASME Rated Expansion Tank

26

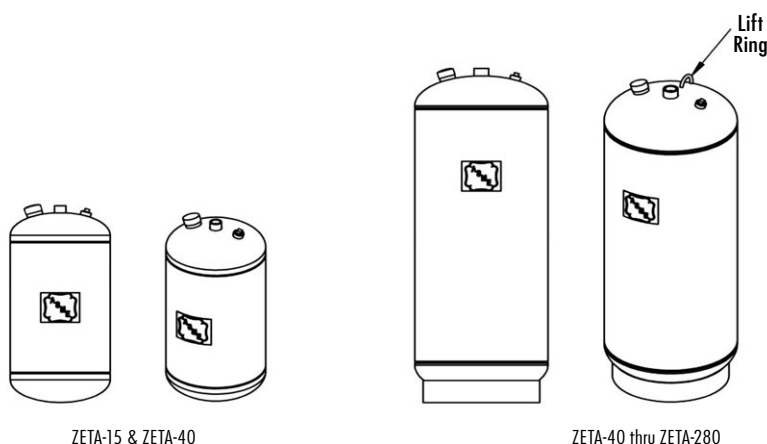

Model Number:	Volume: (Gal)	Tank Weight: (Lbs)	Connection Size: (NPT)	Shipping Dimensions: (LxWxH)	Acceptance Volume:	List Price: (US \$)
ZETA-15	7.8	42	3/4"	12" x 12" x 19"	6.3	\$1,229.09
ZETA-20	10.9	52	3/4"	12" x 12" x 25"	8.8	\$1,262.86
ZETA-40	25	84	1"	16" x 16" x 34"	20.2	\$1,951.69
ZETA-60	35	97	1"	16" x 16" x 45"	28	\$2,255.58
ZETA-80	45	148	1"	20" x 20" x 39"	36	\$2,903.90
ZETA-100	60	175	1"	20" x 20" x 50"	48.5	\$3,045.71
ZETA-120	70	259	1 1/2"	24" x 24" x 47"	56.5	\$3,754.81
ZETA-144	80	268	1 1/2"	24" x 24" x 50"	65	\$4,024.94
ZETA-180	90	283	1 1/2"	24" x 24" x 53"	73	\$4,639.48
ZETA-200	115	325	1 1/2"	24" x 24" x 67"	93	\$4,754.29
ZETA-240	140	362	1 1/2"	24" x 24" x 79"	113.5	\$5,524.16
ZETA-260	158	591	1 1/2"	30" x 30" x 64"	128	\$7,621.49
ZETA-280	211	752	1 1/2"	30" x 30" x 82"	171	\$8,785.67

Description:	Material:
shell	carbon steel
connection	carbon steel
bladder	heavy duty butyl

Operating Conditions:	
precharge of	40 psi
max. operating pressure	125 PSIG
ZETA-15 thru ZETA-60	150 PSIG
ZETA-80 thru ZETA-280	125 PSIG
max. operating temperature	240 °F
warranty	1 year

Available Upon Request:

- Stainless steel ASME tanks (304 and 316 stainless)
- Seismic restraints
- Ratings for: 200 and 250 PSI

Zilmet Thermal Expansion Tank with Replaceable Bladder (ZTXA) ASME Rated Expansion Tank

27

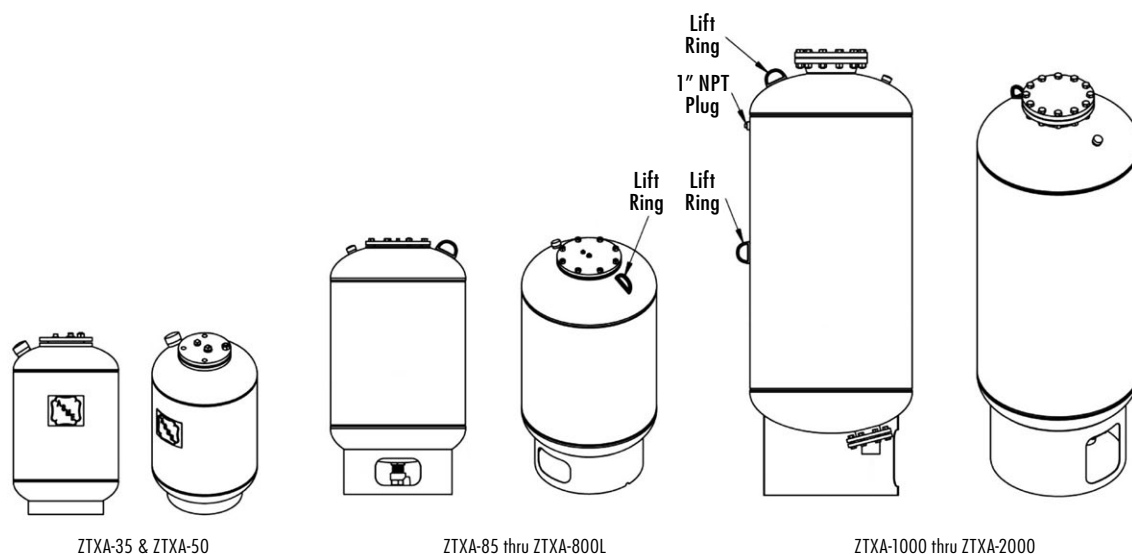

Model Number:	Volume: (Gal)	Tank Weight: (Lbs)	Connection Size: (NPT)	Shipping Dimensions: (LxWxH)	List Price: (US \$)
ZTXA-35	10	40	3/4"	12" x 12" x 23.5"	\$4,486.67
ZTXA-50	13	50	3/4"	14" x 14" x 24"	\$4,786.67

Model Number:	Volume: (Gal)	Tank Weight: (Lbs)	Connection Size: (NPT)	Shipping Dimensions: (LxWxH)	List Price: (US \$)
ZTXA-85	23	90	1"	16" x 16" x 37"	\$4,906.67
ZTXA-130	35	132	1"	20" x 20" x 37"	\$5,226.67
ZTXA-200	53	220	1 1/2"	24" x 24" x 43"	\$7,273.33
ZTXA-300	79	236	1 1/2"	24" x 24" x 55"	\$10,120.00
ZTXA-400	106	315	1 1/2"	30" x 30" x 49"	\$11,800.00
ZTXA-500	132	347	2"	30" x 30" x 57"	\$12,333.33
ZTXA-600	158	378	2"	30" x 30" x 65"	\$13,613.33
ZTXA-800L	211	503	2"	32" x 32" x 76"	\$14,893.33

Model Number:	Volume: (Gal)	Tank Weight: (Lbs)	Connection Size: (NPT)	Shipping Dimensions: (LxWxH)	List Price: (US \$)
ZTXA-1000	264	795	3"	36" x 36" x 86.5"	\$17,273.33
ZTXA-1200	317	820	3"	36" x 36" x 98.5"	\$18,333.33
ZTXA-1400	370	980	3"	36" x 36" x 110.5"	\$19,460.00
ZTXA-1600	422	1395	3"	48" x 48" x 84"	\$25,466.67
ZTXA-2000	528	1525	3"	48" x 48" x 96"	\$27,186.67

Description:	Material:
shell	carbon steel
connection	stainless steel
bladder	heavy duty butyl (FDA Approved)

Operating Conditions:	
precharge of	40 psi
max. operating pressure	150 PSIG
max. operating temperature	240 °F
warranty	1 year

Available Upon Request:

- Stainless steel ASME tanks (304 and 316 stainless)
- Seismic restraints
- Ratings for: 200 and 250 PSI

- The design and construction is manufactured to conform to ASME Section VIII, Div I

Zilmet Thermal Expansion Tank with Fixed Diaphragm (ZTTA) ASME Rated Expansion Tank

28

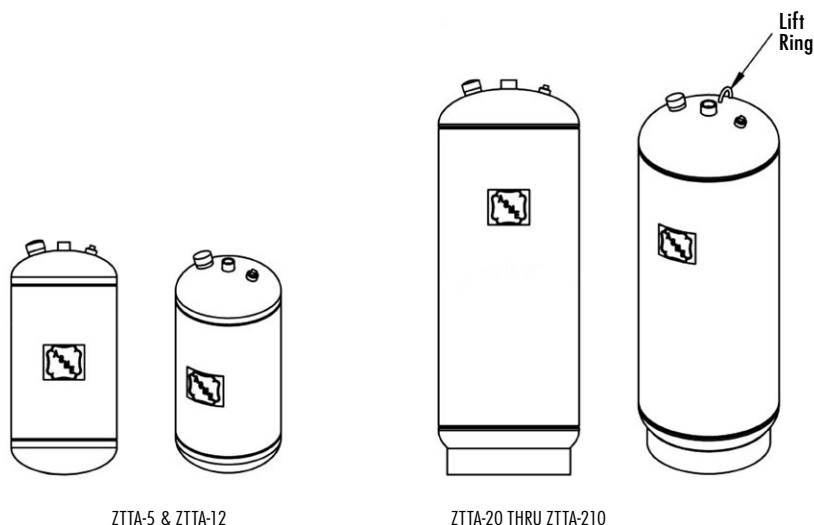

Model Number:	Volume: (Gal)	Tank Weight: (Lbs)	Connection Size: (NPT)	Shipping Dimensions: (LxWxH)	Acceptance Volume: (Gal)	List Price: (US \$)
ZTTA-5	3.5	22	3/4"	10" x 10" x 14"	2.3	\$1,865.50
ZTTA-12	5	28	3/4"	12" x 12" x 14"	3.3	\$2,200.00
ZTTA-20	8	34	3/4"	12" x 12" x 20"	5.3	\$2,440.00
ZTTA-30	15	64	3/4"	16" x 16" x 23"	10	\$2,753.33
ZTTA-42	22	88	1"	16" x 16" x 31"	14.5	\$2,940.00
ZTTA-60	26	93	1"	16" x 16" x 34"	17.5	\$3,626.67
ZTTA-80	35	109	1"	16" x 16" x 45"	23.5	\$3,840.00
ZTTA-100	45	148	1"	20" x 20" x 39"	30	\$4,066.67
ZTTA-125	60	175	1"	20" x 20" x 50"	40	\$4,533.33
ZTTA-160	70	259	1"	24" x 24" x 47"	47	\$5,013.33
ZTTA-180	80	268	1"	24" x 24" x 50"	53	\$5,473.33
ZTTA-210	90	283	1"	24" x 24" x 53"	60	\$5,760.00

Description:	Material:
shell	carbon steel
connection	stainless steel
bladder	heavy duty butyl (FDA Approved)

Operating Conditions:	
precharge of	40 psi
max. operating pressure	150 PSIG
max. operating temperature	240 °F
warranty	1 year

Available Upon Request:

- Stainless steel ASME tanks (304 and 316 stainless)
- Seismic restraints
- Ratings for: 200 and 250 PSI

Zilmet Hydro-Pneumatic Tank with Replaceable Bladder (ZHXA) ASME Rated Expansion Tank

29

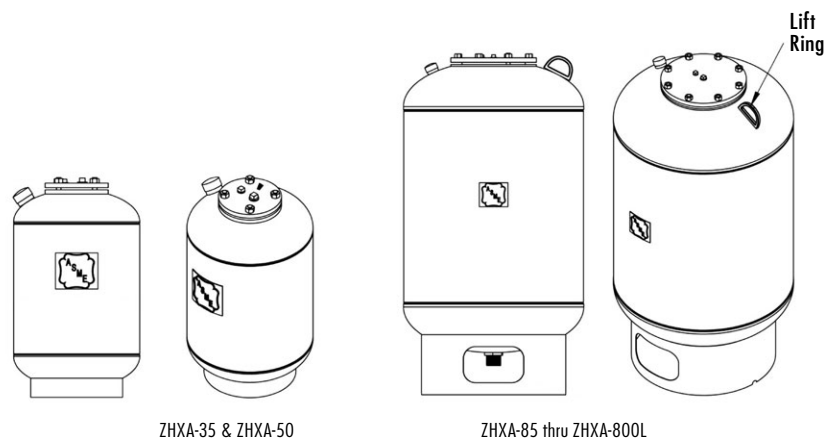

Model Number:	Volume: (Gal)	Tank Weight: (Lbs)	Connection Size: (NPT)	Shipping Dimensions: (LxWxH)	List Price: (US \$)
ZHXA-35	10	40	3/4"	12" x 12" x 23.5"	\$2,957.92
ZHXA-50	13	50	3/4"	14" x 14" x 24"	\$3,160.52
ZHXA-85	23	90	1"	16" x 16" x 37"	\$4,126.23
ZHXA-130	35	125	1"	20" x 20" x 37"	\$5,118.96
ZHXA-200	53	210	1 1/2"	24" x 24" x 43"	\$6,267.01
ZHXA-300	79	225	1 1/2"	24" x 24" x 55"	\$7,516.36
ZHXA-400	106	300	1 1/2"	30" x 30" x 49"	\$8,867.01
ZHXA-500	132	330	2"	30" x 30" x 57"	\$9,245.19
ZHXA-600	158	360	2"	30" x 30" x 65"	\$12,398.96
ZHXA-700	158	360	2"	30" x 30" x 65"	\$12,398.96
ZHXA-800L	211	475	2"	32" x 32" x 76"	\$14,256.10

Description:	Material:
shell	carbon steel
connection	epoxy lined
bladder	heavy duty butyl (FDA Approved)

Operating Conditions:	
precharge of	40 psi
max. operating pressure	125 PSIG*
max. operating temperature	240 °F
warranty	1 year

*200 & 250 PSIG available

Available Upon Request:

- Stainless steel ASME tanks (304 and 316 stainless)
- Seismic restraints
- Ratings for: 200 and 250 PSI

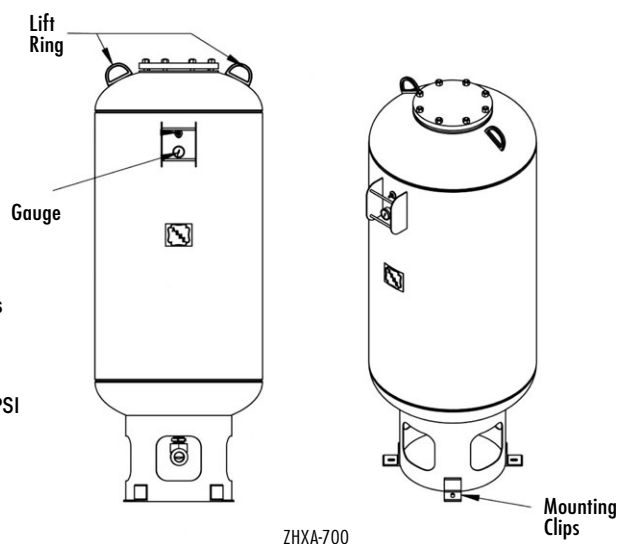

- The design and construction is manufactured to conform to ASME Section VIII, Div I

Zilmet Hydro-Pneumatic Tank with Replaceable Bladder (ZHXA) ASME Rated Expansion Tank

30

-continued

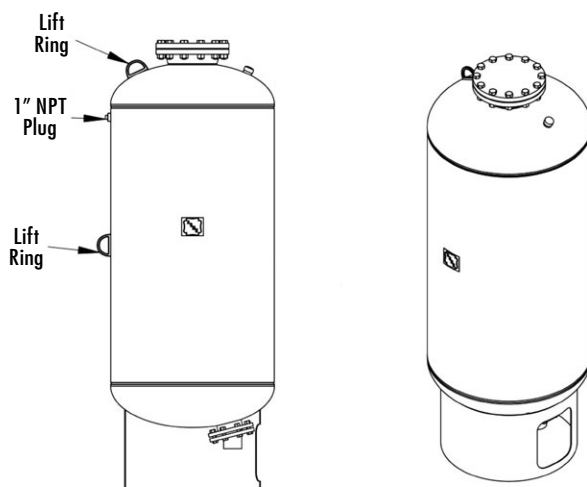

ZHXA-1000 THRU ZHXA-15000

Model Number:	Volume: (Gal)	Tank Weight: (Lbs)	Connection Size: (NPT)	Shipping Dimensions: (LxWxH)	List Price: (US \$)
ZHXA-1000	264	735	3"	36" x 36" x 87"	\$17,382.86
ZHXA-1200	317	745	3"	36" x 36" x 98.5"	\$18,503.90
ZHXA-1400	370	900	3"	36" x 36" x 110.5"	\$19,624.94
ZHXA-1600	422	1210	3"	48" x 48" x 84"	\$24,953.25
ZHXA-2000	528	1305	3"	48" x 48" x 96"	\$27,188.57
ZHXA-2500	660	1430	4"	48" x 48" x 110"	\$33,712.21
ZHXA-3000L	792	1575	4"	48" x 48" x 138"	\$36,845.71
ZHXA-3000S	792	2169	4"	60" x 60" x 93"	\$48,015.58
ZHXA-4000	1056	2638	4"	60" x 60" x 115"	\$56,247.79
ZHXA-5000	1320	3246	4"	60" x 60" x 138"	\$73,644.16
ZHXA-7500	1980	4080	4"	72" x 72" x 140"	\$204,826.44
ZHXA-10000	2640	4920	4"	72" x 72" x 172"	\$325,402.20
ZHXA-15000	3963	6000	4"	72" x 72" x 243"	\$399,482.72

Description:	Material:
shell	carbon steel
connection	epoxy lined
bladder	heavy duty butyl (FDA Approved)

Operating Conditions:	
precharge of	40 psi
max. operating pressure	125 PSIG*
max. operating temperature	240 °F
warranty	1 year

*200 & 250 PSIG available

Available Upon Request:

- Stainless steel ASME tanks (304 and 316 stainless)
- Seismic restraints
- Ratings for: 200 and 250 PSI

Zilmet Hydro-Pneumatic Tank with Fixed Diaphragm (ZHXT) ASME Rated Expansion Tank

31

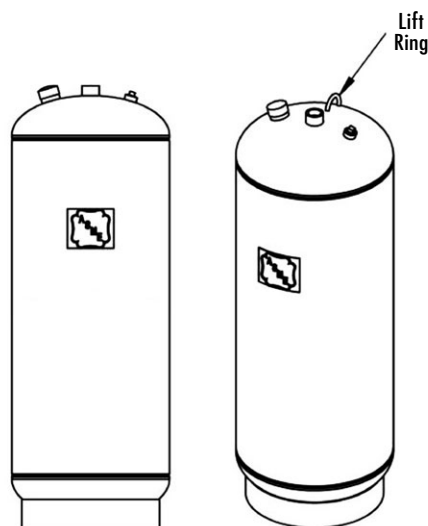

ZHXT-400 thru ZHXT-480

Model Number:	Volume: (Gal)	Tank Weight: (Lbs)	Connection Size: (NPT)	Shipping Dimensions: (LxWxH)	Acceptance Volume: (Gal)	List Price: (US \$)
ZHXT-400	8	34	3/4"	12" x 12" x 21"	6.3	\$2,994.34
ZHXT-401	15	64	1"	16" x 16" x 26"	11.9	\$3,180.78
ZHXT-402	25	84	1"	16" x 16" x 34"	19.8	\$3,741.30
ZHXT-403	35	97	1"	16" x 16" x 46"	27.5	\$3,802.08
ZHXT-404	70	259	1 1/2"	24" x 24" x 47"	52.8	\$5,692.99
ZHXT-405	90	283	1 1/2"	24" x 24" x 53"	55.5	\$5,936.10
ZHXT-415	115	325	1 1/2"	24" x 24" x 67"	71	\$11,846.29
ZHXT-440	140	362	1 1/2"	24" x 24" x 79"	91	\$13,679.12
ZHXT-460	160	591	1 1/2"	30" x 30" x 62"	127	\$16,398.20
ZHXT-480	210	752	1 1/2"	30" x 30" x 80"	166	\$19,645.08

Description:	Material:
shell	carbon steel
connection	epoxy lined
bladder	heavy duty butyl (FDA Approved)

Operating Conditions:	
precharge of	40 psi
max. operating pressure	125 PSIG*
max. operating temperature	240 °F
warranty	5 years

*200 & 250 PSIG available

Available Upon Request:

- Stainless steel ASME tanks (304 and 316 stainless)
- Seismic restraints
- Ratings for: 200 and 250 PSI

- The design and construction is manufactured to conform to ASME Section VIII, Div I

NEW!

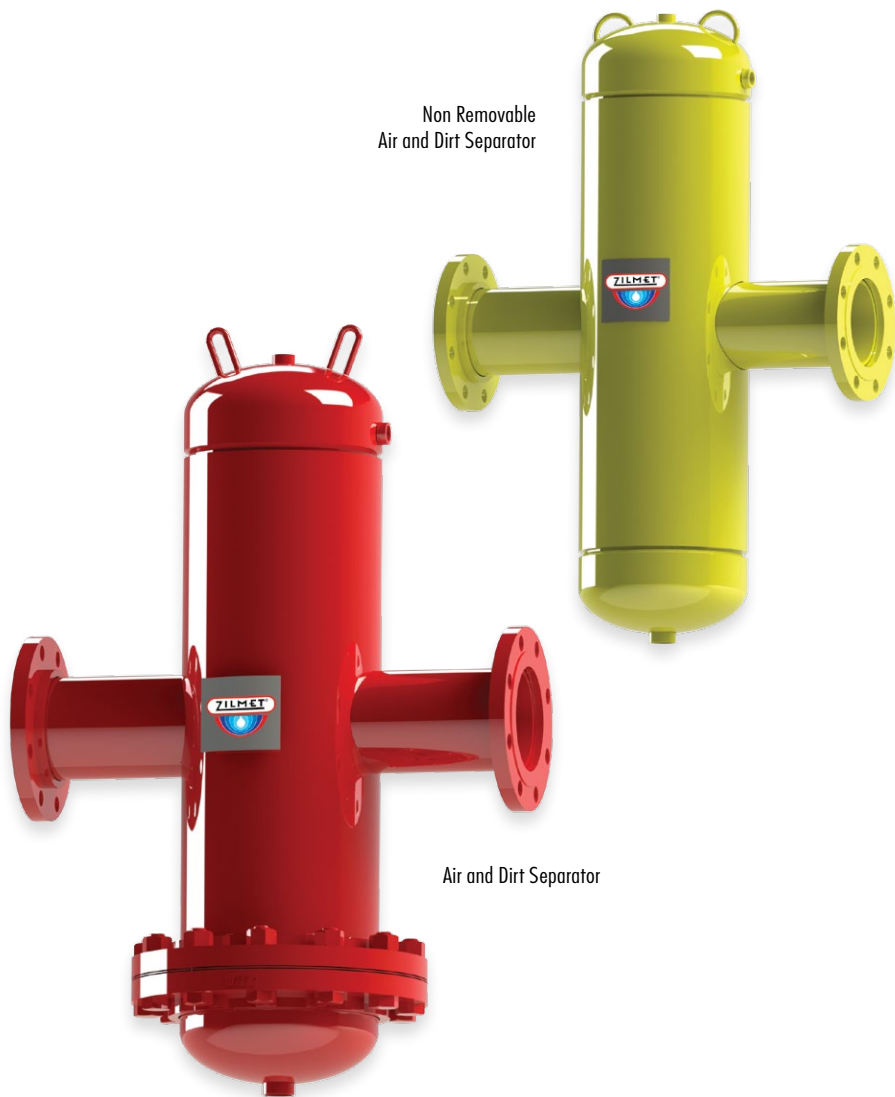

Zilmet Air and Dirt Separators (ZADS) are designed to eliminate entrained air and separate debris associated with start-up and continuous operation of any hydronic system. The design incorporates a removeable end cover for access to the coalescing media, a skim valve (optional) used to eliminate floating debris, and an air vent (optional) to automatically release air from the separator. The design and construction is manufactured to conform to ASME Section VIII, Div I.

Standard	
material	carbon steel
Coalescing media	stainless steel
max. design temperature	250° F
max. design pressure	150 PSIG

Optional add-ons	
material	stainless steel
coalescing media	copper mesh
blow down valve	bronze
skim valve	bronze
air vent	cast iron

Optional magnetic filtration to remove ferrous particulate

For Hydronic Use Only

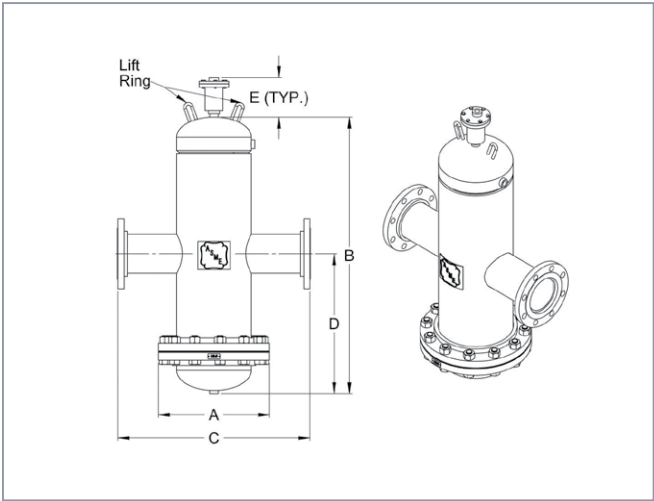

Air and Dirt Separator (ZADS)

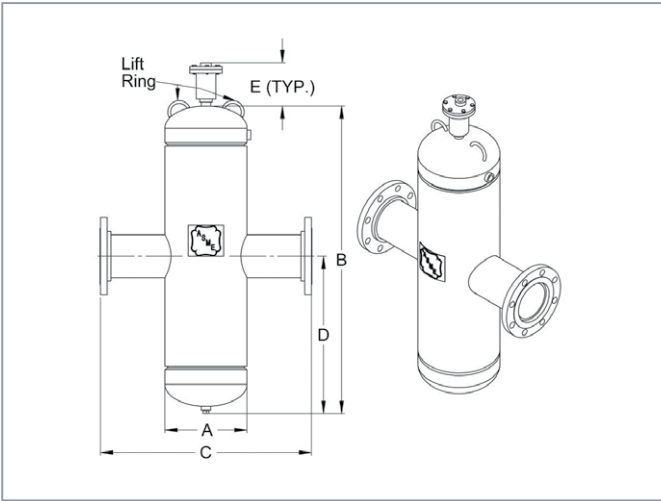

Non Removable Air and Dirt Separator (ZADSN)

NEW!

AIR AND DIRT SEPARATOR (ZADS)				Standard Velocity (ZADS)				Replacement Cartridge	High Velocity (ZADS-HV)				Replacement Cartridge
Model Number:	Flange Size: (In.)	A (In.)	B (In.)	C (In.)	D (In.)	FLOW GPM	List Price: (US \$)	List Price: (US \$)	C (In.)	D (In.)	FLOW GPM	List Price: (US \$)	List Price: (US \$)
ZADS-2	2	9	15.25	23	11.5	69	\$3,787.54	\$1,624.03	33	16.5	105	\$6,523.92	\$2,441.60
ZADS-2-NPT	2	9	9	23	11.5	69	\$3,136.82	\$1,624.03	33	16.5	105	\$5,873.19	\$2,441.60
ZADS-2.5	2.5	10	15.75	23	11.5	108	\$4,154.62	\$1,624.03	33	16.5	155	\$7,124.58	\$2,441.60
ZADS-2.5 NPT	2.5	10	10.5	23	11.5	108	\$3,503.89	\$1,624.03	33	16.5	155	\$6,479.42	\$2,441.60
ZADS-3	3	11	20.25	29	14.5	144	\$5,139.04	\$4,076.75	42	21	225	\$8,798.67	\$6,090.10
ZADS-3-NPT	3	11	12.75	29	14.5	144	\$4,360.40	\$4,076.75	42	21	225	\$8,020.02	\$6,090.10
ZADS-4	4	13.5	20.625	29	14.5	255	\$6,507.23	\$5,433.82	42	21	405	\$11,190.21	\$8,236.93
ZADS-5	5	16	27.75	39	19.5	398	\$9,988.88	\$8,159.07	59	29.5	630	\$15,867.63	\$12,480.53
ZADS-6	6	19	27.75	39	19.5	570	\$14,543.94	\$11,662.96	59	29.5	910	\$17,575.08	\$13,909.90
ZADS-8	8	23.5	33.625	49	24.5	945	\$21,679.64	\$17,246.94	75	37.5	1610	\$36,301.45	\$28,014.46
ZADS-10	10	27.5	37.5	65	32.5	1440	\$34,399.33	\$34,099.00	92	46	2450	\$51,173.53	\$49,577.31
ZADS-12	12	32	42.5	76	38	2100	\$43,709.68	\$34,099.00	110	55	3500	\$64,733.04	\$49,577.31

Non-ASME also available. For Hydronic Use Only

**NON-REMOVABLE
AIR AND DIRT SEPARATOR (ZADSN)**

				Standard Velocity (ZADSN)				High Velocity (ZADSN-HV)			
Model Number:	Flange Size: (In.)	A (In.)	B (In.)	C (In.)	D (In.)	FLOW GPM	List Price: (US \$)	C (In.)	D (In.)	FLOW GPM	List Price: (US \$)
ZADSN-2	2	4.5	15.25	23	11.5	69	\$3,787.54	33	16.5	105	\$6,523.92
ZADSN-2-NPT	2	4.5	9	23	11.5	69	\$3,136.82	33	16.5	105	\$5,873.19
ZADSN-2.5	2.5	5.5	15.75	23	11.5	108	\$4,154.62	33	16.5	155	\$7,124.58
ZADSN-2.5 NPT	2.5	5.5	10.5	23	11.5	108	\$3,503.89	33	16.5	155	\$6,479.42
ZADSN-3	3	6.5	20.25	29	14.5	144	\$5,139.04	42	21	225	\$8,798.67
ZADSN-3-NPT	3	6.5	12.75	29	14.5	144	\$4,360.40	42	21	225	\$8,020.02
ZADSN-4	4	8.5	20.625	29	14.5	255	\$6,507.23	42	21	405	\$11,190.21
ZADSN-5	5	10	27.75	39	19.5	398	\$9,988.88	59	29.5	630	\$15,867.63
ZADSN-6	6	12	27.75	39	19.5	570	\$14,543.94	59	29.5	910	\$17,575.08
ZADSN-8	8	16	33.625	49	24.5	945	\$21,679.64	75	37.5	1610	\$36,301.45
ZADSN-10	10	20	37.5	65	32.5	1440	\$34,399.33	92	46	2450	\$51,173.53
ZADSN-12	12	24	42.5	76	38	2100	\$43,709.68	110	55	3500	\$64,733.04

Non-ASME also available. For Hydronic Use Only

NEW!**Zilmet ASME Chilled Water Buffer Tanks (ZCBT)**

are designed for use in chilled water systems with insufficient water volume capacity, in relation to the chiller capacity. The ZCBT Series Buffer Tanks effectively increase system volume and reduce the rate of temperature change (ΔT) in the return water, resulting in improved temperature control, consistent system operation and controlled compressor cycling. The design and construction is manufactured to conform to ASME Section VIII, Div I.

**STANDARD FEATURES FOR (ZCBT) & (ZHBT):**

- ASME rated (125 PSI @ 450° F)
- Integral Ring Stand for Vertical Installation
- Top Air Vent Connection
- (ZCBT) only: Internal Baffle

Features (ZCBT) and (ZHBT)

material	carbon steel
max. pressure	125 PSIG
max. temperature	450° F
finish	red oxide primer
auxiliary connections	3.4" NPT top vent; 1" NPT bottom drain

(ZCBT) Chilled Water Buffer Tanks

					3"	4"	6"	8"	10"
Model Number:	Gallons	Diameter (in.)	Height (in.)	Weight	ListPrice: (US \$)	ListPrice: (US \$)	ListPrice: (US \$)	ListPrice: (US \$)	ListPrice: (US \$)
ZCBT-120	120	24	60	425	\$8,898.78	\$9,454.95	\$10,011.12	\$10,845.38	\$11,957.73
ZCBT-200	200	30	72	597	\$9,454.95	\$10,011.12	\$10,567.30	\$11,401.56	\$12,513.90
ZCBT-300	300	36	72	793	\$12,513.90	\$13,070.08	\$13,626.25	\$14,460.51	\$15,572.86
ZCBT-500	500	42	90	1391	\$17,797.55	\$18,353.73	\$18,909.90	\$19,744.16	\$20,856.51
ZCBT-850	850	54	96	2718	\$26,696.33	\$27,252.50	\$27,808.68	\$28,642.94	\$29,755.28
ZCBT-1040	1040	60	96	3873	\$31,145.61	\$31,701.89	\$32,258.06	\$33,092.32	\$34,204.67

ZILMET HOT WATER BUFFER TANKS (ZHBT)

NEW!**Zilmet ASME Hot Water Buffer Tanks (ZHBT)**

are designed for use with today's high efficiency systems that incorporate small modular low mass boilers. A properly sized Zilmet Hot Water Buffer Tank adds necessary thermal mass to the system to dampen fast transactions and minimize boiler cycling that occurs during zero or low domestic load conditions. The design and construction is manufactured to conform to ASME Section VIII, Div I.

**OPTIONAL FEATURES FOR (ZCBT) & (ZHBT):**

- 1/2" Elastomeric Insulation
- Weather Resistant Coating
- Available with 1" to 2-1/2" NPT Connections
- 1"-20" flange connections also available

(ZHBT) Hot Water Buffer Tanks

Model Number:	Gallons	Diameter (in.)	Height (in.)	Weight
ZHBT-120	120	30	60	248
ZHBT-210	210	30	75	459
ZHBT-300	300	36	72	781

Consult technical team for pricing and availability for higher working pressures and larger system connections

Prices and lead times available upon request

NEW!

Zilmet Primary/Secondary Header hydraulic separations are used in heating and cooling systems that require the primary and secondary loop of the system to be interlocked. The primary and secondary headers (ZPSA) are designed to keep both connected hydraulic circuits completely independent from one another and to provide a means for system air elimination. The Zilmet Primary/Secondary Header with Air/Dirt Separator (ZPSAV) builds on that functionality with the inclusion of internal coalescence coils in the tank that eliminate entrained air and separate debris associated with start-up and maintenance of the system. As a result, the ZPSAV replaces the need for an air/dirt separator. The design and construction is manufactured to conform to ASME Section VIII, Div I.

**STANDARD FEATURES:**

- Separates Primary and Secondary loop hydraulically
- Removes air from system
- Separates and collects sediment
- Easy installation

Features

material	stainless steel
max. pressure	150 PSIG
max. temperature	450° F
finish	primer painted exterior

Legs come standard with 6" connection models and above
Consult technical team for pricing and availability for higher working pressures and larger system connections

ZPSA – PRIMARY/SECONDARY HEADER – With Internal Baffle @ 150PSI

Model Number:	Connection (in.)	Diameter (in.)	Height (in.)	Width	Flow (GPM)	Weight (lbs.)	List Price: (US \$)
ZPSA-2	2	6.625	34.25	14.75	65	90	\$3,820.91
ZPSA-2.5	2.5	6.625	39.25	14.75	68	115	\$4,499.44
ZPSA-3	3	10.75	49.5	18.75	175	225	\$7,141.27
ZPSA-4	4	10.75	70.25	22.75	180	330	\$8,364.85
ZPSA-5	5	14	80.5	26	300	215	\$11,295.88
ZPSA-6	6	18	93.75	30	500	320	\$12,119.02
ZPSA-8	8	24	122.75	36	900	575	\$15,678.53
ZPSA-10	10	30	149.25	42	1420	935	\$25,583.98
ZPSA-12	12	30	179.5	42	1425	1165	\$34,883.20
ZPSA-14	14	42	199.25	54	1650	2430	\$68,364.85
ZPSA-16	16	48	224.25	60	2200	3260	\$89,043.38

ZPSAV – PRIMARY/SECONDARY HEADER – With Air/Dirt Separation @ 150PSI

Model Number:	Connection (in.)	Diameter (in.)	Height (in.)	Width	Flow (GPM)	Weight (lbs.)	List Price: (US \$)
ZPSAV-2	2	6.625	34.25	14.75	65	120	\$6,028.92
ZPSAV-2.5	2.5	6.625	39.25	14.75	68	145	\$6,785.32
ZPSAV-3	3	10.75	49.5	18.75	175	270	\$9,421.58
ZPSAV-4	4	10.75	70.25	22.75	180	380	\$11,006.67
ZPSAV-5	5	14	80.5	26	300	280	\$14,838.71
ZPSAV-6	6	18	93.75	30	500	375	\$16,685.21
ZPSAV-8	8	24	122.75	36	900	635	\$23,337.04
ZPSAV-10	10	30	149.25	42	1420	995	\$37,958.84
ZPSAV-12	12	30	179.5	42	1425	1250	\$46,957.73
ZPSAV-14	14	42	199.25	54	1650	2480	\$92,030.03
ZPSAV-16	16	48	224.25	60	2200	3310	\$119,860.96

For Hydronic Use Only

Product:	Model:	Warranty Duration:
Well Tanks	Hydro Plus (ZHP)	5 Year Limited Manufacturer's Warranty
Thermal Expansion Tanks	Easy Pro (ZEP)	5 Year Limited Manufacturer's Warranty
Hydronic Expansion Tanks	Cal Pro (ZHT)	5 Year Limited Manufacturer's Warranty
Hydronic Flat Expansion Tanks	Zilmet Flats (ZFT)	5 Year Limited Manufacturer's Warranty
Stainless Steel Tanks	Inox Pro (ZS) and Ultra Inox Pro (ZUP)	5 Year Limited Manufacturer's Warranty
Solar Expansion Tanks and Pre Solar Vessels	Solar Plus (ZSP) Pre Solar (VSG)	5 Year Limited Manufacturer's Warranty
Heat Exchanger	Brazed Plate and Frame	1 Year Limited Manufacturer's Warranty
Commercial Products	All Models	1 Year Limited Manufacturer's Warranty
Magnetic Filters	All sizes	5 Year Limited Manufacturer's Warranty

THERMAL EXPANSION TANKS

Model Number:	Layer Count	Pallet Count
ZEP1	N/A	75/box
ZEP5	18	162
ZEP12	10	70
ZEP18	8	48
ZEP104IL	6	24

WELL EXPANSION TANKS

Model Number:	Layer Count	Pallet Count
ZHP5	18	162
ZHP12	10	70
ZHP18	8	48
ZHP104IL	6	24
ZHP200F	6	18
ZHP200BH	5	20
ZHP200IL	6	18
ZHP202	4	12
ZHP202BH	3	12
ZHP202SM	3	12
ZHP202BV	4	12
ZHP202BC	4	12
ZHP203	4	10
ZHP204	4	8
ZHP204BC	4	8
ZHP250	4	8
ZHP302	4	6
ZHP350	N/A	4
ZHP351	N/A	3
ZHP400	N/A	2
ZHP451	N/A	2

HYDRONIC EXPANSION TANKS

Model Number:	Layer Count	Pallet Count
ZHT8	20	120
ZHT18	10	70
ZHT24	8	48
ZHT35	6	24
ZHT35F	6	24
ZHT50	6	18
ZHT50F	6	18
ZHT80	4	12
ZHT105	4	10
ZHT150	4	8
ZHT200	4	8
ZHT250	4	8
ZHT300	4	6
ZHT400	N/A	4
ZHT500	N/A	2
ZHT600	N/A	2
ZHT700	N/A	2





NOTES:



ZILMET USA CORP • 400 FRENCHTOWN ROAD, EAST GREENWICH, RHODE ISLAND 02818
P:401-884-4943 • F:401-287-4951 • INFO@ZILMETUSA.COM • WWW.ZILMETUSA.COM