

T.P.I.

Top Performer Immersion.

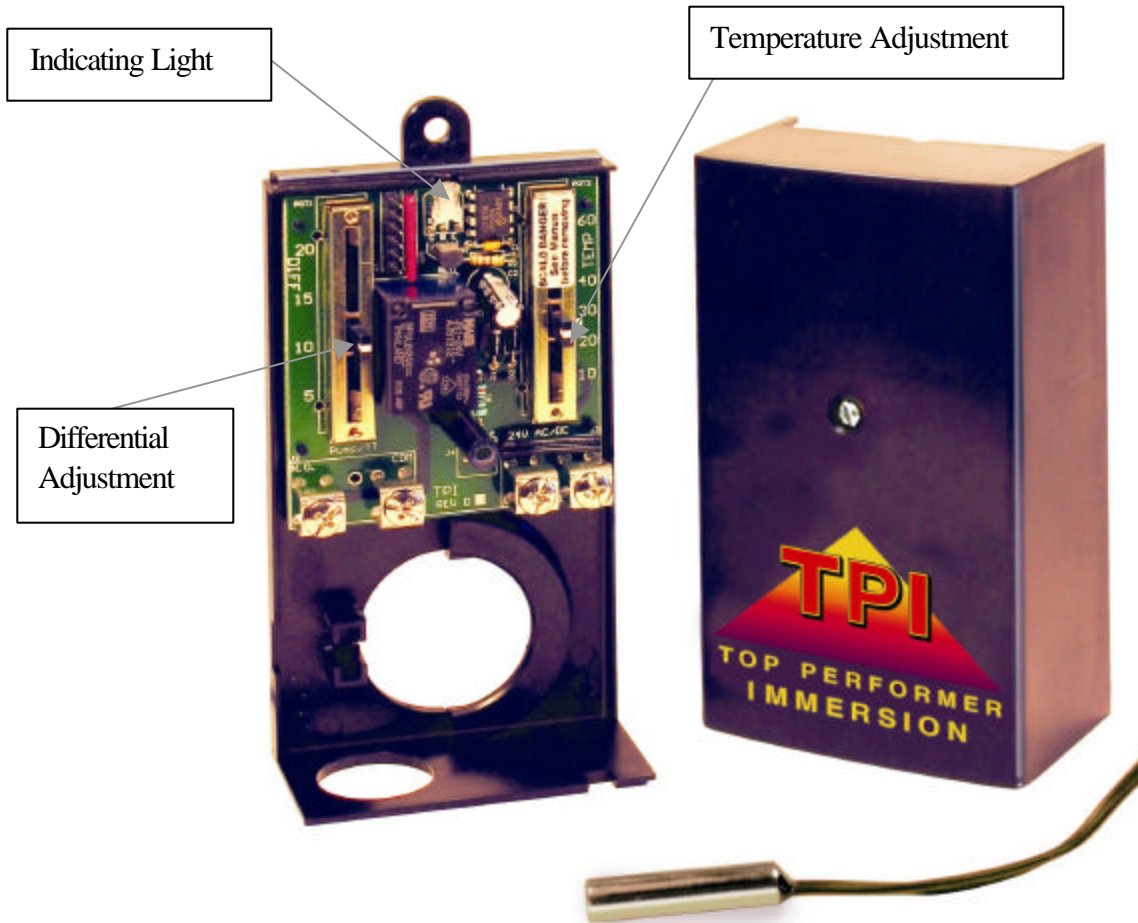

Installation Manual

TPI (Top Performer Immersion)

Installation Manual

Installation

Attaching TPI to Top Performer tank:

Place hole in back of TPI over immersion well. (See Diagram 1)

TPI should fit flush against the tank without immersion well protruding beyond bottom of TPI case.

Use self-tapping screw provided (Screw A) to attach TPI directly to the Top Performer.

Attaching TPI to other tanks:

Place hole in back of TPI over immersion well. (See Diagram 1)

If TPI cannot fit flush against the tank without immersion well protruding beyond bottom of TPI case, TPI can be mounted directly onto the immersion well itself.

Place square nut in the retaining well on the TPI box.

Use proper machine bolt provided (Bolt B or Bolt C) to tighten against the immersion well.

Inserting the Temperature Sensor:

Slide temperature sensor all the way into the immersion well – until it contacts the end. (See Diagram 1)

The sensor will measure temperature adequately by resting against the bottom of the immersion well.

(Note: Sensor does NOT need to make intimate contact with entire well surface to work properly)

CAUTION: Sensor is soldered directly to TPI. DO NOT BEND SHARPLY OR OVERWORK.

Wiring the TPI:

THE TPI MUST BE POWERED WITH 24VAC.

Run all 24VAC wiring thru the square notch on bottom of TPI case. (See Diagram 2)

Connect incoming wiring to 24VAC connectors on the bottom right corner of TPI. (See Diagram 2)

Connect outgoing wiring to PUMP/TT connectors on the bottom left corner of TPI. (See Diagram 2)

If output wiring is 110VAC, use knockout at bottom of TPI case, with appropriate chase nipple.

Consult attached Wiring Diagrams for appropriate wiring configurations.

TPI Cover:

Be certain to replace TPI cover using Black Screw provided.

Operation

Indicator Light operation:

The TPI has an integral indicator light at the top of the case. (See Front Cover or Inside Cover of TPI)

Indicator light will come on (Green) when TPI is powered.

When TPI is calling for heat, the Indicator light will blink.

When TPI is satisfied, the Indicator light will be solid.

During normal operation, Indicator light is Green.

If TPI detects a failure, Indicator light will flash (Red). Replace TPI.

Adjustments

Adjusting the Temperature Setting:

The temperature setting slide is on the right-hand side of the TPI (See Front Cover or Inside Cover of TPI)

The TPI comes with a factory set temperature setting of 120°F.

To adjust the temperature setting, slide the lever to the desired setting, using the indicator scale.

TPI has a normal temperature setting range from 100°F to 140°F.

CAUTION: IT IS NOT RECOMMENDED TO SET TEMPERATURE ABOVE 140° F.
(SEE WATER TEMPERATURE REGULATION below)

In order to set the temperature above 140°F, { **NOT RECOMMENDED** }, you must remove the SCALD DANGER label attached to the temperature slide.

Adjusting the Differential Setting:

The differential setting slide is on the left-hand side of the TPI (See Front Cover or Inside Cover of TPI)

The TPI comes with a factory set differential setting of 10°.

This means that the TPI will call for heat when the tank temperature has fallen to 10 degrees below the Temperature set point.

To adjust the differential setting, slide the lever to the desired setting, using the indicator scale.

WATER TEMPERATURE REGULATION

WARNING: Exposure to 125° F or hotter water can cause scalding injuries. Appropriate caution must be taken when using hot water. Special supervision must be given to those who cannot act quickly such as children, invalids or elderly persons.

The input of heat into the tank is controlled by an immersion thermostat. These automatic controls are set at the factory to maintain a water temperature of 120° F*.

*Although these thermostats are designed to industry standards, they can fail to control temperature properly without any notice, and therefore should be tested periodically for your protection.

DANGER: IF YOU DISCOVER EXTREME HOT WATER COMING FROM THE FAUCET, IMMEDIATELY SHUT OFF THE MAIN SWITCH TO THE BOILER AND CALL COMPETENT SERVICE PERSONNEL. ANY OVERHEATED WATER IS A POTENTIAL HAZARD TO LIFE AND PROPERTY. DO NOT OPERATE UNTIL THE SOURCE OF THE PROBLEM HAS BEEN DETERMINED AND ELIMINATED.



Water temperature over 125° F can cause severe burns instantly or death from scalds.

Children, disabled and elderly are at the highest risk of being scalded.

See instruction manual before setting temperature at the water heater.

Feel water before bathing or showering.

Diagram 1

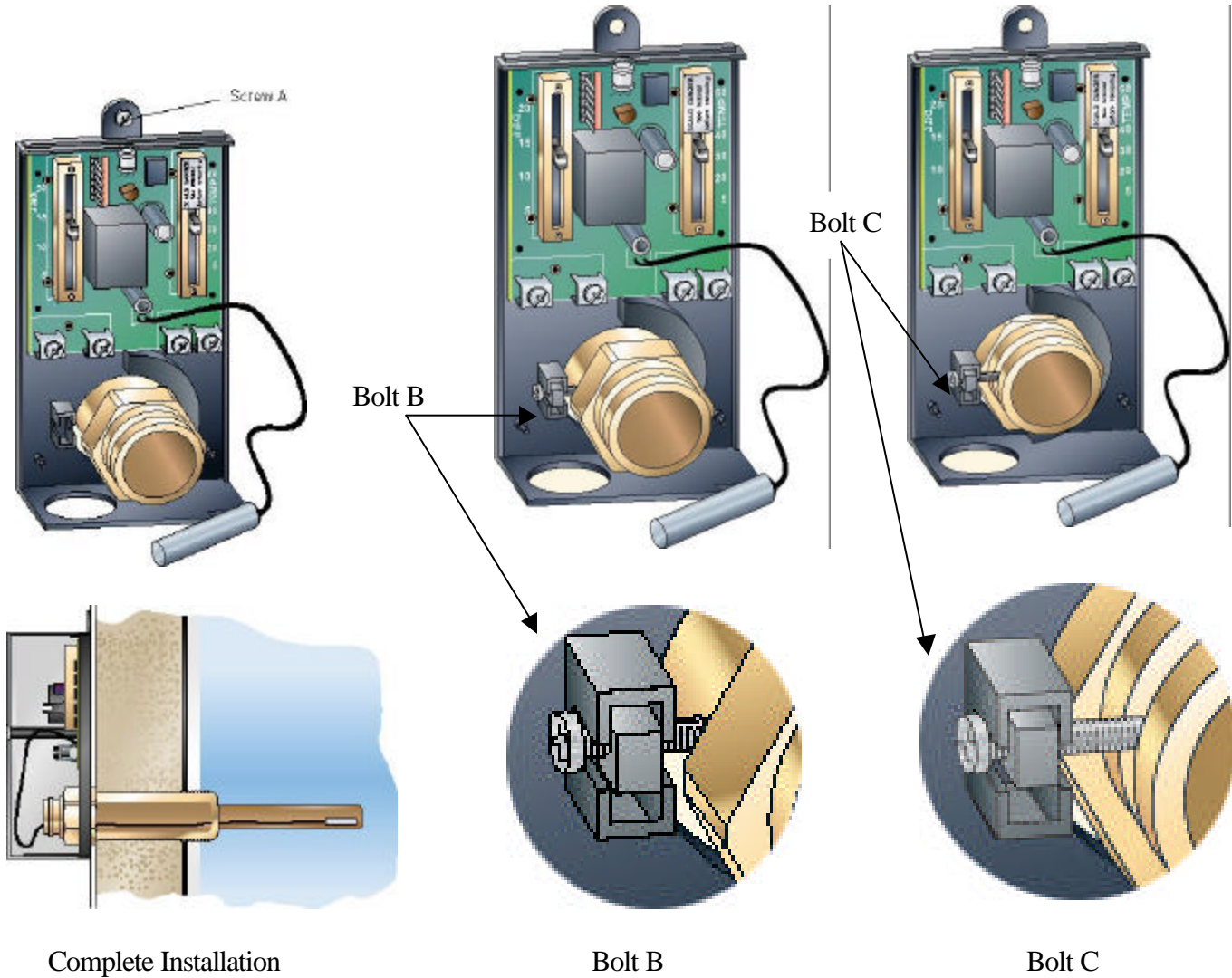

Diagram 2

