

EFFECTIVE:
18-DEC-12

SUPERSEDES:
04-DEC-12

HORIZONTAL MOTORS

ODP

FRAME: 180T
BASIC TYPE: D

PRINT:
07-2207

SHEET:
1 OF 1

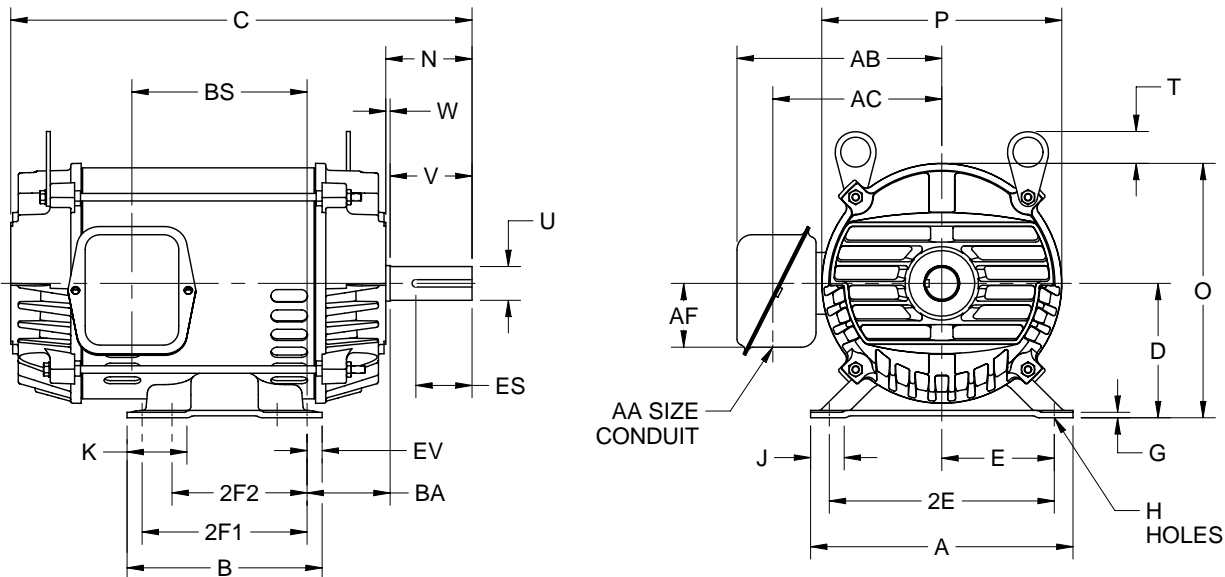

DIMENSIONS ARE IN INCHES AND MILLIMETERS
(TOLERANCES ARE IN INCHES)

UNITS	A	B	C	D -.06	E	2E ±.03	G	H +.05	J
IN	8.75	6.50	15.00	4.50	3.75	7.50	.19	.41	1.13
MM	222	165	381	114	95	191	5	10	29

UNITS	K	N	O	P ²	T ⁴	U -.0005	V MIN	W	AA
IN	2.00	2.88	8.50	8.00	1.06	1.1250	2.50	.13	.75
MM	51	73	216	203	27	28.575	64	3	

UNITS	AB	AC	AF	BA	BS	ES MIN	EV	SQ KEY
IN	6.83	5.63	2.13	2.75	5.97	1.78	.50	.250
MM	173	143	54	70	152	45	13	6.35

FRAME	UNITS	2F1 ±.03	2F2 ±.03
182T	IN	--	4.50
	MM	--	114
184T	IN	5.50	--
	MM	140	--

1. DIMENSIONS MAY VARY BY .25" DUE TO CASTING AND/OR FABRICATION VARIATIONS.
2. LARGEST MOTOR WIDTH.
3. STANDARD ASSEMBLY POSITION F-1 IS SHOWN. CONDUIT OPENING MAY BE LOCATED IN STEPS OF 90 DEGREES. STANDARD AS SHOWN WITH CONDUIT OPENING DOWN.
4. LIFTING LUGS - WHEN SPECIFIED ON BILL.
5. FRAME REFERENCE: 7.750/182/184

07-2207/G

Nidec Motor Corporation
St. Louis, Missouri

INFORMATION DISCLOSED ON THIS DOCUMENT IS CONSIDERED PROPRIETARY AND SHALL NOT BE REPRODUCED OR DISCLOSED WITHOUT WRITTEN CONSENT OF NIDEC MOTOR CORPORATION



ISSUED BY
R. KING
APPROVED BY
J. HAGENE

IHP_DP_NMCA (MAR-2011) SOLIDEDGE