

Little **GIANT**®

HVAC PRODUCT CATALOG



TABLE OF CONTENTS

VCMX 4
VCMA-15 SERIES 6
VCMA-20 SERIES 8
VCC-20 SERIES 10
VCC-20-P SERIES 12
VCL-14 SERIES 14
VCL-24ULS SERIES 16
VCL-45ULS SERIES 18
1-ABS SERIES 20
2-ABS SERIES 22
3-ABS SERIES 24
EC-1-DV SERIES 26
EC-1K-DV SERIES 28
EC-OP-K SERIES 30
TP SERIES 32
CP SERIES 34
RIM-U SERIES 36
GKPK-SC SERIES 38
ACS-2 & 3 IN-PAN Condensate Overflow Detection Switches 40
ACS-4 SERIES 42
ACS-5 SERIES 44
ACCESSORIES 46
ADDITIONAL CHECK VALVES 47

For the most up-to-date product information, visit littlegiant.com.

VCMX

APPLICATIONS

- Designed for automatic collection and removal of condensate from air conditioning, refrigeration and dehumidification equipment when gravity drainage is not possible or practical. Also suitable for high efficiency oil and gas-fired condensing furnace and condensing boiler equipment.

FEATURES

- External test/run lever
- Slim footprint
- Vertical centrifugal pump design
- Stainless steel motor shaft
- Automatic start and stop operation
- Galvanized steel “quick install” wall mount bracket
- Some models equipped with external, float activated switch for automatic high-level water detection (overflow detection switch)
- For models with overflow detection switch: dual function NO and NC operation (set to NO from factory for equipment shut down connection)
- Models equipped with overflow detection switch include two 5” switch lead wires
- 3/8” O.D. barbed ¼-turn quick release, locking discharge adapter with built-in check valve
- Rubber feet for vibration/noise dampening
- “Anti-sweat” tank sleeve included on select models and available separately for all others
- 3 - 1-1/8” diameter inlet openings, two fitted with removable cap plug (3 + 1 inlet openings for models without overflow detection switch)
- Recessed tank sump
- Oil resistant tank and check valve
- Thermally protected, fan cooled motor
- Maximum water temperature: 140 °F
- 6’, 3-conductor cable with grounded 3-prong plug
- Some models include 20’ x 3/8” I.D. vinyl discharge tubing
- 3-year warranty



VCMX-20ULS



VCMX-20ULST



VCMX-20UL



VCMX-20ULS-C



SERIES SPECIFICATIONS

NXTGEN™

| Item No. | Model | HP | Input Voltage | Hz | Amps (FLA) | Watts (kW) | Discharge Size | Check Valve | Overflow Detection Switch | Performance GPH (LPH) @ Head | | | | | Shut-Off Ft. | PSI | Cord | Weight (lbs) |
|----------|------------|------|---------------|-------|------------|------------|----------------|---------------|---------------------------|------------------------------|------------|------------|------------|-----------|--------------|-----|------------|--------------|
| | | | | | | | | | | 1' | 5' | 10' | 15' | 20' | | | | |
| 554520 | VCMX-20UL | 1/30 | 115 | 60 | 1.5 | 93 | 3/8" (9.5 mm) | 3/8" (9.5 mm) | No | 84 (318.4) | 75 (284.3) | 60 (227.4) | 42 (159.2) | 10 (37.9) | 21 (6.4 m) | 9.1 | 6' (1.8 m) | 5.5 (2.5 Kg) |
| 554521 | VCMX-20UL | 1/30 | 230 | 50/60 | 0.7/0.6 | 75 | 3/8" (9.5 mm) | 3/8" (9.5 mm) | No | 78 (295.6) | 67 (253.9) | 51 (193.3) | 29 (109.9) | 0 (0) | 19 (5.7 m) | 9.1 | 6' (1.8 m) | 5.5 (2.5 Kg) |
| 554530 | VCMX-20ULS | 1/30 | 115 | 60 | 1.5 | 93 | 3/8" (9.5 mm) | 3/8" (9.5 mm) | Yes | 84 (318.4) | 75 (284.3) | 60 (227.4) | 42 (159.2) | 10 (37.9) | 21 (6.4 m) | 9.1 | 6' (1.8 m) | 5.5 (2.5 Kg) |
| 554531 | VCMX-20ULS | 1/30 | 230 | 50/60 | 0.7/0.6 | 75 | 3/8" (9.5 mm) | 3/8" (9.5 mm) | Yes | 78 (295.6) | 67 (253.9) | 51 (193.3) | 29 (109.9) | 0 (0) | 19 (5.7 m) | 9.1 | 6' (1.8 m) | 5.5 (2.5 Kg) |

NXTGEN™ with Tubing

| Item No. | Model | HP | Input Voltage | Hz | Amps (FLA) | Watts (kW) | Discharge Size | Check Valve | Overflow Detection Switch | Performance GPH (LPH) @ Head | | | | | Shut-Off Ft. | PSI | Cord | Weight (lbs) |
|----------|-------------|------|---------------|-------|------------|------------|----------------|---------------|---------------------------|------------------------------|------------|------------|------------|-----------|--------------|-----|------------|--------------|
| | | | | | | | | | | 1' | 5' | 10' | 15' | 20' | | | | |
| 554550 | VCMX-20ULST | 1/30 | 115 | 60 | 1.5 | 93 | 3/8" (9.5 mm) | 3/8" (9.5 mm) | Yes | 84 (318.4) | 75 (284.3) | 60 (227.4) | 42 (159.2) | 10 (37.9) | 21 (6.4 m) | 9.1 | 6' (1.8 m) | 5.5 (2.5 Kg) |
| 554551 | VCMX-20ULST | 1/30 | 230 | 50/60 | 0.7/0.6 | 75 | 3/8" (9.5 mm) | 3/8" (9.5 mm) | Yes | 80 (303.2) | 69 (261.5) | 54 (204.7) | 36 (136.4) | 0 (0) | 20 (6.1 m) | 9.1 | 6' (1.8 m) | 5.5 (2.5 Kg) |

NXTGEN™ with Anti-Sweat Sleeve

| Item No. | Model | HP | Input Voltage | Hz | Amps (FLA) | Watts (kW) | Discharge Size | Check Valve | Overflow Detection Switch | Performance GPH (LPH) @ Head | | | | | Shut-Off Ft. | PSI | Cord | Weight (lbs) |
|----------|--------------|------|---------------|----|------------|------------|----------------|---------------|---------------------------|------------------------------|------------|------------|------------|-----------|--------------|-----|------------|--------------|
| | | | | | | | | | | 1' | 5' | 10' | 15' | 20' | | | | |
| 554542 | VCMX-20ULS-C | 1/30 | 115 | 60 | 1.5 | 93 | 3/8" (9.5 mm) | 3/8" (9.5 mm) | Yes | 84 (318.4) | 75 (284.3) | 60 (227.4) | 42 (159.2) | 10 (37.9) | 21 (6.4 m) | 9.1 | 6' (1.8 m) | 5.5 (2.5 Kg) |

VCMX

REPLACEMENT PARTS & KITS

| Item | Part Number |
|---|-------------|
| Tank | 154390 |
| Feet, Rubber (4 pack 554520, 554530, 554550, 554551, 554521, 554531) | 925047 |
| Cover, Motor | 154425 |
| Float Arm Assembly | 154460 |
| Check Valve, 3/8" | 154724 |
| Overflow Detection Switch Assembly (554530, 554550, 554551, 554542, 554531) | 599136 |
| Anti-sweat Sleeve and Bracket (554542) | 599138 |
| Bracket, Tank (554520, 554530, 554550, 554551, 554521, 554531) | 154483 |

ENGINEERING DATA

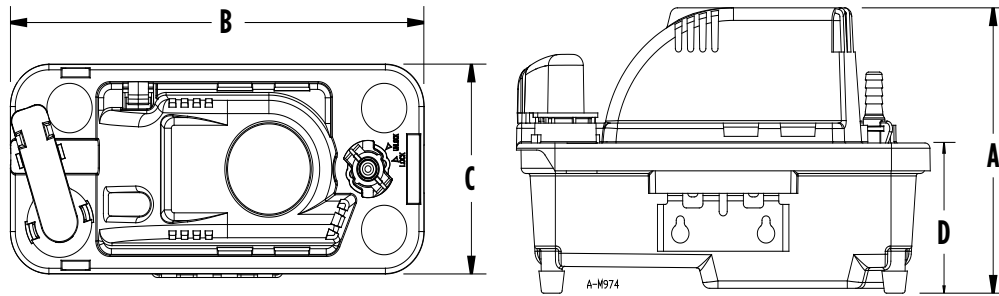

| Model | A | B | C | D |
|--------------|----------------|------------------|-----------------|----------------|
| VCMX-20UL | 6.5" (165.1mm) | 10.2" (259.1 mm) | 4.8" (121.9 mm) | 3.4" (86.4 mm) |
| VCMX-20ULS | 6.5" (165.1mm) | 10.2" (259.1 mm) | 4.8" (121.9 mm) | 3.4" (86.4 mm) |
| VCMX-20ULST | 6.5" (165.1mm) | 10.2" (259.1 mm) | 4.8" (121.9 mm) | 3.4" (86.4 mm) |
| VCMX-20ULS-C | 6.8" (172.7mm) | 10.3" (261.6 mm) | 5.1" (129.5 mm) | 3.4" (86.4 mm) |

PERFORMANCE DATA

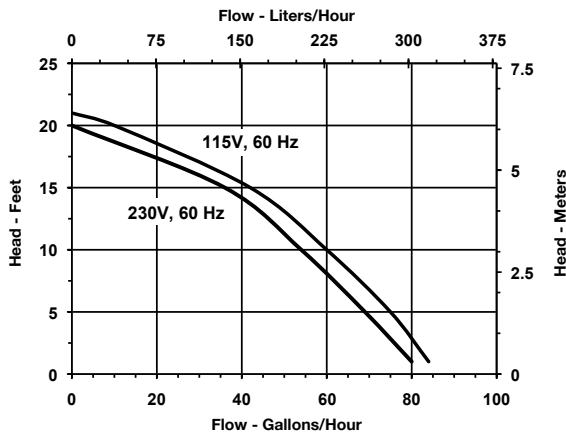

CONSTRUCTION

| | |
|--------------------|---------------|
| Housing/Tank Cover | ABS |
| Motor Cover | ABS |
| Volute | ABS |
| Tank | Polypropylene |
| Impeller | Polypropylene |
| Switch Float | ABS |
| Check Valve | Acetal |

VCMA-15 SERIES

APPLICATIONS

- Designed for automatic collection and removal of condensate from air conditioning, refrigeration and dehumidification equipment when gravity drainage is not possible or practical. Also, suitable for high efficiency oil and gas-fired condensing furnace and condensing boiler equipment.

FEATURES

- 1/2-gallon collection tank
- Vertical centrifugal pump design
- Stainless steel motor shaft
- Automatic start and stop operation
- Some models equipped with float (solid polymer) activated switch for automatic high-level water detection (overflow detection switch)
- For models with overflow detection switch: dual function NO and NC operation (set to NO from factory for equipment shut down connection)
- Models equipped with overflow detection switch include two 5" switch lead wires
- 3/8" O.D. barbed discharge adapter with built-in check valve
- Three 1-1/8" diameter inlet openings (two fitted with removable cap plug)
- Thermally protected, fan cooled motor
- Built-in wall mount tabs on tank
- Removable pump float locking tab for safety during transportation (remove at time of installation)
- Maximum water temperature: 140 °F
- 6 ft, 3-conductor cable with grounded 3-prong plug
- Some models include 20' x 3/8" I.D. vinyl discharge tubing



SERIES SPECIFICATIONS

| Item No. | Model | HP | Input Voltage | Hz | Amps (FLA) | Watts (kW) | Discharge Size | Performance GPH (LPH) @ Head | | | | Shut-Off Ft. | PSI | Cord | Weight (lbs) |
|----------|-------------|------|---------------|----|------------|------------|-------------------------|------------------------------|------------|-----------|-------|--------------|-----|-----------|--------------|
| | | | | | | | | 1' | 5' | 10' | 20' | | | | |
| 554401 | VCMA-15UL | 1/50 | 115 | 60 | 1 | 60 | 3/8" (9.5 mm) OD Barbed | 65 (246.4) | 50 (189.5) | 25 (94.8) | 0 (0) | 15 (4.6 m) | 6.5 | 6 (1.8 m) | 4.4 (2 kg) |
| 554411 | VCMA-15ULT | 1/50 | 115 | 60 | 1 | 60 | 3/8" (9.5 mm) OD Barbed | 65 (246.4) | 50 (189.5) | 25 (94.8) | 0 (0) | 15 (4.6 m) | 6.5 | 6 (1.8 m) | 5.8 (2.6 Kg) |
| 554405 | VCMA-15ULS | 1/50 | 115 | 60 | 1 | 60 | 3/8" (9.5 mm) OD Barbed | 65 (246.4) | 50 (189.5) | 25 (94.8) | 0 (0) | 15 (4.6 m) | 6.5 | 6 (1.8 m) | 4.4 (2 kg) |
| 554415 | VCMA-15ULST | 1/50 | 115 | 60 | 1 | 60 | 3/8" (9.5 mm) OD Barbed | 65 (246.4) | 50 (189.5) | 25 (94.8) | 0 (0) | 15 (4.6 m) | 6.5 | 6 (1.8 m) | 5.8 (2.6 Kg) |

Note: GPH is through check valve.

VCMA-15 SERIES

REPLACEMENT PARTS & KITS

| Item | Part Number |
|---------------|-------------|
| Tank | 154401 |
| Cover, Motor | 154421 |
| Float Arm | 154452 |
| Switch Holder | 154471 |
| Switch | 950337 |
| Check Valve | 154715 |

ENGINEERING DATA

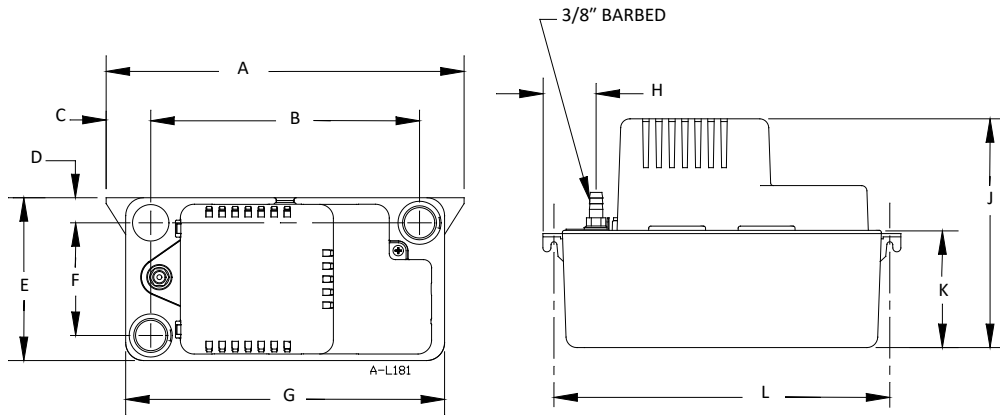

| A | B | C | D | E | F | G | H | I | J | K |
|------------|--------------|-------------|-------------|---------|------------|--------------|--------------|-----------|------------|--------------|
| 11 (279.4) | 8.3 (210.82) | 1.4 (35.56) | 0.8 (20.32) | 5 (127) | 3.5 (88.9) | 9.8 (248.92) | 1.6 (400.64) | 7 (177.8) | 3.6 (91.4) | 10.3 (261.6) |

PERFORMANCE DATA

115 V, 60 HZ

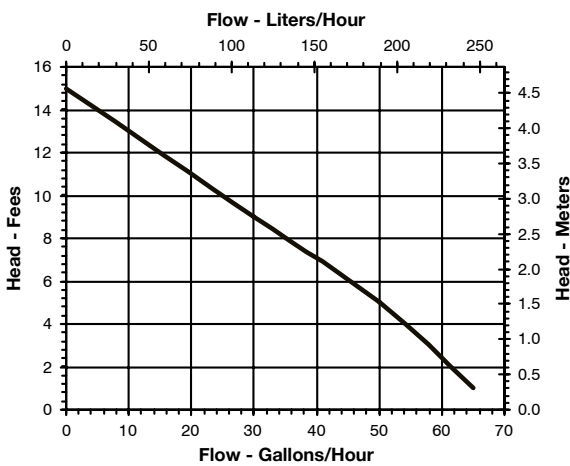

CONSTRUCTION

| | |
|--------------------|----------------------------|
| Motor | 1/50 hp |
| Discharge | 3/8" OD barbed |
| Housing/Tank Cover | ABS |
| Motor Cover | ABS |
| Volute | ABS |
| Tank | ABS |
| Impeller | Glass filled polypropylene |
| Check Valve | Acetal |

VCMA-20 SERIES

APPLICATIONS

- Designed for automatic collection and removal of condensate from air conditioning, refrigeration and dehumidification equipment when gravity drainage is not possible or practical. Also, suitable for high efficiency oil and gas-fired condensing furnace and condensing boiler equipment.

FEATURES

- 1/2-gallon collection tank
- Vertical centrifugal pump design
- Stainless steel motor shaft
- Automatic start and stop operation
- Some models equipped with float (solid polymer) activated switch for automatic high-level water detection (overflow detection switch)
- For models with overflow detection switch: dual function NO and NC operation (set to NO from factory for equipment shut down connection)
- Models equipped with overflow detection switch include two 5" switch lead wires
- 3/8" O.D. barbed discharge adapter with built-in check valve
- Three 1-1/8" diameter inlet openings (two fitted with removable cap plug)
- Thermally protected, fan cooled motor
- Built-in wall mount tabs on tank
- Removable pump float locking tab for safety during transportation (remove at time of installation)
- Maximum water temperature: 140 °F
- 6 ft, 3-conductor cable with grounded 3-prong plug
- Some models include 20' x 3/8" I.D. vinyl discharge tubing



SERIES SPECIFICATIONS

| Item No. | Model | HP | Input Voltage | Hz | Amps (FLA) | Watts (kW) | Discharge Size | Performance GPH (LPH) @ Head | | | | Shut-Off Ft. | PSI | Cord | Weight (lbs) |
|----------|-------------|------|---------------|-------|------------|------------|------------------------|------------------------------|------------|------------|-------|--------------|-----|-----------|--------------|
| | | | | | | | | 1' | 5' | 10' | 20' | | | | |
| 554421 | VCMA-20UL | 1/30 | 115 | 60 | 1.5 | 93 | 3/8" (9.5mm) OD Barbed | 80 (303.2) | 70 (265.3) | 48 (181.9) | 0 (0) | 20 (6.1 m) | 8.7 | 6 (1.8 m) | 5 (2.3 Kg) |
| 554451 | VCMA-20UL | 1/30 | 230 | 50/60 | 0.5 | 75 | 3/8" (9.5mm) OD Barbed | 80 (303.2) | 70 (265.3) | 48 (181.9) | 0 (0) | 17 (5.2 m) | 7.4 | 6 (1.8 m) | 5 (2.3 Kg) |
| 554431 | VCMA-20ULT | 1/30 | 115 | 60 | 1.5 | 93 | 3/8" (9.5mm) OD Barbed | 80 (303.2) | 70 (265.3) | 48 (181.9) | 0 (0) | 20 (6.1 m) | 8.7 | 6 (1.8 m) | 6 (2.7 Kg) |
| 554425 | VCMA-20ULS | 1/30 | 115 | 60 | 1.5 | 93 | 3/8" (9.5mm) OD Barbed | 80 (303.2) | 70 (265.3) | 48 (181.9) | 0 (0) | 20 (6.1 m) | 8.7 | 6 (1.8 m) | 5 (2.3 Kg) |
| 554455 | VCMA-20ULS | 1/30 | 230 | 50/60 | 0.5 | 75 | 3/8" (9.5mm) OD Barbed | 80 (303.2) | 70 (265.3) | 48 (181.9) | 0 (0) | 17 (5.2 m) | 7.4 | 6 (1.8 m) | 5 (2.3 Kg) |
| 554435 | VCMA-20ULST | 1/30 | 115 | 60 | 1.5 | 93 | 3/8" (9.5mm) OD Barbed | 80 (303.2) | 70 (265.3) | 48 (181.9) | 0 (0) | 20 (6.1 m) | 8.7 | 6 (1.8 m) | 6.3 (2.9 Kg) |
| 554461 | VCMA-20ULST | 1/30 | 230 | 60 | 0.5 | 75 | 3/8" (9.5mm) OD Barbed | 80 (303.2) | 70 (265.3) | 48 (181.9) | 0 (0) | 17 (5.2 m) | 7.4 | 6 (1.8 m) | 6.3 (2.9 Kg) |

Note: GPH is through check valve.

VCMA-20 SERIES

REPLACEMENT PARTS & KITS

| Item | Part Number |
|---------------|-------------|
| Tank | 154401 |
| Cover, Motor | 154421 |
| Float Arm | 154452 |
| Switch Holder | 154471 |
| Switch | 950337 |

ENGINEERING DATA

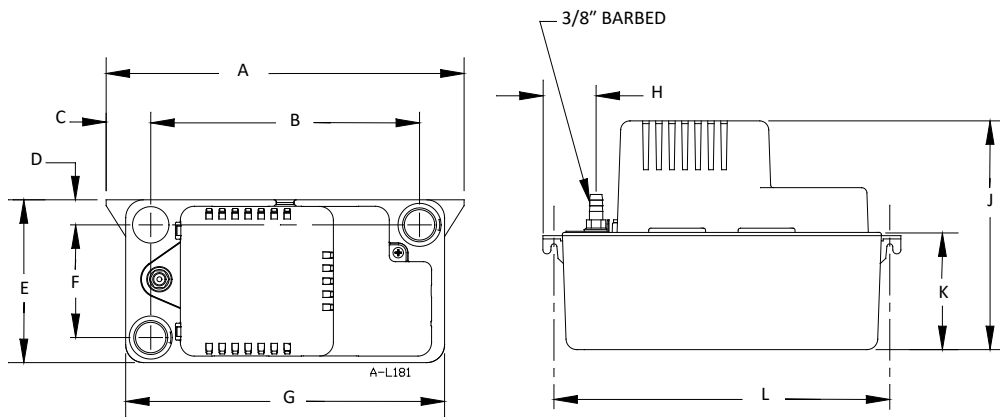

| A | B | C | D | E | F | G | H | J | K | L |
|------------|--------------|-------------|-------------|---------|------------|--------------|--------------|-----------|------------|--------------|
| 11 (279.4) | 8.3 (210.82) | 1.4 (35.56) | 0.8 (20.32) | 5 (127) | 3.5 (88.9) | 9.8 (248.92) | 1.6 (400.64) | 7 (177.8) | 3.6 (91.4) | 10.3 (261.6) |

PERFORMANCE DATA

115 V, 60 HZ

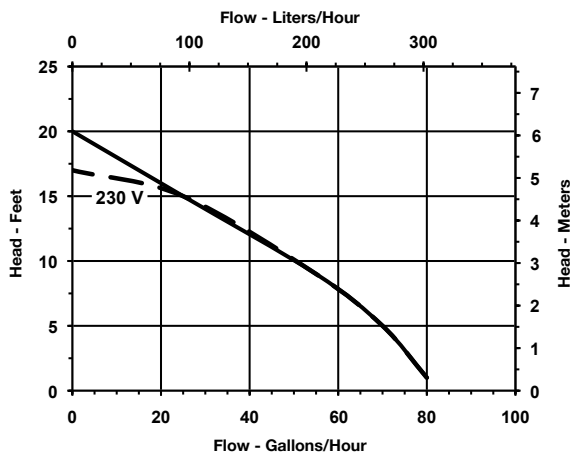

CONSTRUCTION

| | |
|--------------------|----------------------------|
| Motor | 1/30 hp |
| Discharge | 3/8" OD barbed |
| Housing/Tank Cover | ABS |
| Volute | ABS |
| Tank | ABS |
| Impeller | Glass filled polypropylene |
| Check Valve | Acetal |

VCC-20 SERIES

APPLICATIONS

- Designed for automatic collection and removal of condensate from air conditioning, refrigeration and dehumidification equipment when gravity drainage is not possible or practical. Also, suitable for high efficiency oil and gas-fired condensing furnace and condensing boiler equipment.

FEATURES

- Low profile for limited spaces
- Vertical centrifugal pump design
- Stainless steel motor shaft
- Automatic start, stop and high-level water detection (overflow detection switch)
- 3/8" O.D. barbed discharge adapter with built-in check valve (installed on the pump)
- 1/4" O.D. barbed discharge adapter (included in the box)
- Two inlet openings 1-1/8"
- Overflow detection float activated switch
- Two 5" overflow detection switch lead wires
- Thermally protected, fan cooled motor
- Intermittent liquid temperature up to 120 °F
- 6 ft, 3-conductor cable with grounded 3-prong plug (115 V and 230 V models)



SERIES SPECIFICATIONS

| Item No. | Model | HP | Input Voltage | Hz | Amps (FLA) | Watts (kW) | Discharge Size | Performance GPH (LPH) @ Head | | | | Shut-Off Ft. | PSI | Cord | Weight (lbs) |
|----------|-----------|------|---------------|-------|------------|------------|-------------------------|------------------------------|------------|------------|-------|--------------|-----|-----------|--------------|
| | | | | | | | | 1' | 5' | 10' | 20' | | | | |
| 554200 | VCC-20ULS | 1/30 | 115 | 60 | 1.5 | 93 | 3/8" (9.5 mm) OD Barbed | 80 (303.2) | 70 (265.3) | 45 (170.6) | 0 (0) | 20 (6.1 m) | 8.6 | 6 (1.8 m) | 5.4 (2.5 Kg) |
| 554210 | VCC-20ULS | 1/30 | 230 | 50/60 | 0.6/0.5 | 75 | 3/8" (9.5 mm) OD Barbed | 80 (303.2) | 70 (265.3) | 45 (170.6) | 0 (0) | 17 (5.2 m) | 7.4 | 6 (1.8 m) | 5.4 (2.5 Kg) |

Note: GPH is through check valve.

VCC-20 SERIES

REPLACEMENT PARTS & KITS

| Item | Part Number |
|---------------------------|-------------|
| Tank | 154004 |
| Impeller | 154009 |
| Volute | 154015 |
| Cover, Motor | 154006 |
| Check Valve | 154715 |
| Switch Pump | 950337 |
| Seal Ring | 928006 |
| Overflow Detection Switch | 154714 |
| Float/Stem | 154017 |
| Adapter, 1/4" | 154037 |

ENGINEERING DATA

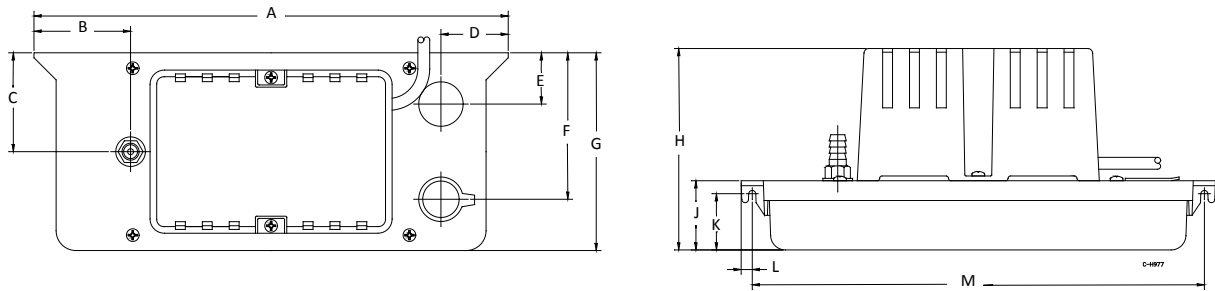

| A | B | C | D | E | F | G | H | J | K | L | M |
|------------|-----------|------------|------------|----------|----------|---------|--------------|-------------|-------------|------------|---------------|
| 12 (304.8) | 2.44 (62) | 2.5 (63.5) | 1.7 (43.2) | 1.3 (33) | 3.7 (94) | 5 (127) | 5.09 (129.3) | 1.75 (44.5) | 1.42 (36.1) | 0.28 (7.1) | 11.44 (290.6) |

PERFORMANCE DATA

115 V, 60 HZ

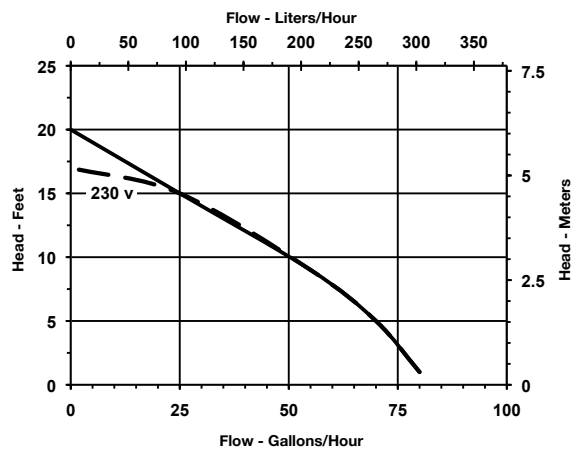

CONSTRUCTION

| | |
|--------------------|----------------------------|
| Motor | 1/30 hp |
| Discharge | 3/8" OD barbed |
| Housing/Tank Cover | ABS |
| Motor Cover | ABS |
| Volute | ABS |
| Tank | ABS |
| Impeller | Glass filled polypropylene |
| Check Valve | Acetal |

VCC-20-P SERIES

APPLICATIONS

- Designed for automatic collection and removal of condensate from air conditioning, refrigeration, and dehumidification equipment installed in air handling and plenum applications having limited space and where gravity drainage is not possible or practical.
- The VCC-20-P is constructed with plastics that have been tested by Underwriter's Laboratories' to UL Standard 2043 "Fire Test for Heat and Visible Smoke Release for Discrete Products and Their Accessories Installed in Air Handling Spaces".

FEATURES

- The pump meets the requirements of UL 2043 and is labeled "For Plenum Applications"
- 1/30 hp motor
- 1-3/4" low profile tank height ideal for tight spaces
- Vertical centrifugal pump design
- 1.2-quart (1.1 liters) capacity tank
- Automatic start and stop switch
- 3/8" O.D. barbed discharge adapter with built-in check valve (installed on the pump)
- 1-1/8" diameter inlet
- Float-activated auxiliary high-level switch
 - Two 72" high-level switch lead wires
- Thermally protected, fan-cooled motor
- Intermittent liquid temperature up to 140 °F
- Designed for hard-wire installation only
- 72" 3-conductor lead wires with conduit fitting for 1/2" diameter flexible metal conduit
- Stainless motor shaft



SERIES SPECIFICATIONS

| Item No. | Model | HP | Input Voltage | Hz | Amps (FLA) | Watts (kW) | Discharge Size | Performance GPH (LPH) @ Head | | | | Shut-Off Ft. | PSI | Cord | Weight (lbs) |
|-----------|----------|------|---------------|-------|------------|------------|-------------------------|------------------------------|------------|------------|-------|--------------|-----|--------------|-----------------|
| | | | | | | | | 1' | 5' | 10' | 20' | | | | |
| 554220101 | VCC-20-P | 1/30 | 115 | 60 | 1.5 | 93 | 3/8" (9.5 mm) OD Barbed | 80 (303.2) | 70 (265.3) | 45 (170.6) | 0 (0) | 20' | 8.6 | 72" (183 cm) | 4.5 lbs/2.05 kg |
| 554220102 | VCC-20-P | 1/30 | 230 | 50/60 | 0.6/0.5 | 60 | 3/8" (9.5 mm) OD Barbed | 80 (303.2) | 70 (265.3) | 45 (170.6) | 0 (0) | 17' | 7.4 | 72" (183 cm) | 4.5 lbs/2.05 kg |

Note: GPH is through check valve.

VCC-20-P SERIES

ENGINEERING DATA

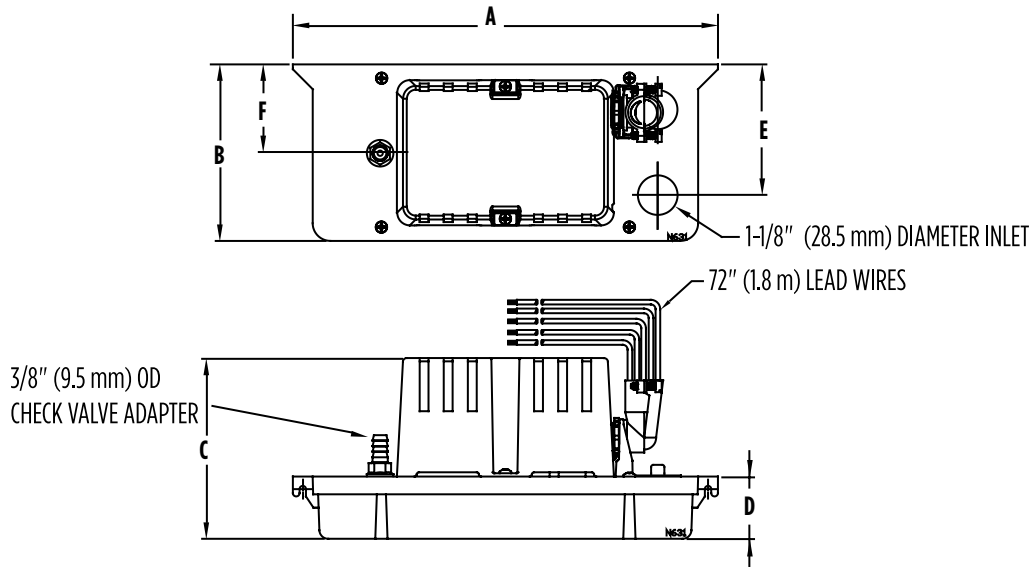

| A | B | C | D | E | F |
|----------------|-------------|-------------------|-----------------|-----------------|----------------|
| 12" (304.8 mm) | 5" (127 mm) | 5.09" (129.31 mm) | 1.75" (44.6 mm) | 3.70" (93.9 mm) | 2.50" (63.5mm) |

PERFORMANCE DATA

VCC-20-P 115 V and 230 V, 60 Hz

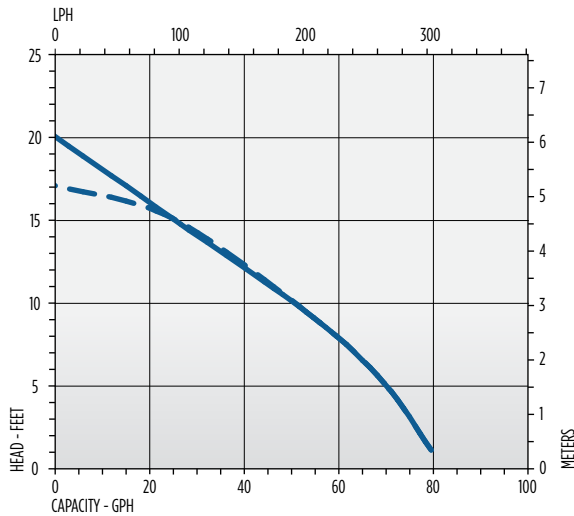

CONSTRUCTION

| | |
|------------------------|--------------------|
| Tank | G.F. Polypropylene |
| Tank Cover | G.F. Polypropylene |
| Motor/Switch Cover | G.F. Polypropylene |
| Volute Cover | G.F. Polypropylene |
| Impeller | G.F. Polypropylene |
| Volute Cover Seal Ring | EPDM |
| Check Valve /Adapter | Acetal |
| Motor Shaft | Stainless Steel |
| Fasteners | Stainless Steel |

VCL-14 SERIES

APPLICATIONS

- Designed for automatic collection and removal of condensate from air conditioning, refrigeration and dehumidification equipment when gravity drainage is not possible or practical. Also, suitable for high efficiency oil and gas-fired condensing furnace and condensing boiler equipment.

FEATURES

- 1 gallon collection tank
- 1/50 hp, fan cooled, concentric motor
- Vertical centrifugal pump design
- Stainless steel motor shaft
- Automatic start and stop operation
- Includes float (solid polymer) activated switch for automatic high-level water detection (overflow detection switch)
- Overflow detection switch: dual function NO and NC operation (set to NO from factory for equipment shut down connection)
- Overflow detection switch includes two 5" switch lead wires
- 3/8" barbed discharge adapter (for use with 3/8" I.D. vinyl tubing)*
- *Optional check valve adapter for 3/8" vinyl tubing sold separately (Part Number 599065)
- *Optional check valve for 3/8" copper tube sold separately (Part Number 599063)
- Two 1-1/8" diameter inlet openings
- Thermally protected
- Maximum water temperature: 120 °F
- 6 ft, 3-conductor cable with grounded 3-prong plug

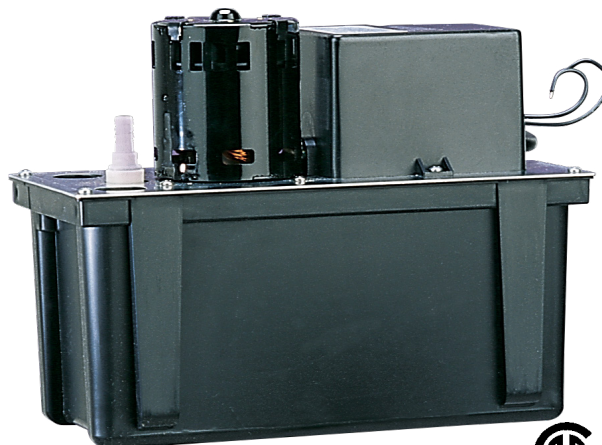

SERIES SPECIFICATIONS

| Item No. | Model | HP | Input Voltage | Hz | Amps (FLA) | Watts (kW) | Discharge Size | Performance GPH (LPH) @ Head | | | | Shut-Off Ft. | PSI | Cord | Weight (lbs) |
|----------|-----------|------|---------------|----|------------|------------|-------------------------|------------------------------|-----------|-------------|-------------|--------------|-----|-----------|---------------|
| | | | | | | | | 1' | 3' | 5' | 10' | | | | |
| 553101 | VCL-14ULS | 1/50 | 115 | 60 | 1.0 | 78 | 3/8" (9.5 mm) OD Barbed | 200 (758) | 185 (701) | 170 (644.3) | 125 (473.8) | 14 (4.3 m) | 6.1 | 6 (1.8 m) | 6.8 (3.08 Kg) |

VCL-14 SERIES

REPLACEMENT PARTS & KITS

| Item | Part Number |
|---------------------------|-------------|
| Tank | 153502 |
| Cover, Volute | 153110 |
| Impeller | 153132 |
| Adapter, 3/8" | 153300 |
| Seal Ring | 924038 |
| Switch, Pump | 950337 |
| Overflow Detection Switch | 950333 |

ENGINEERING DATA

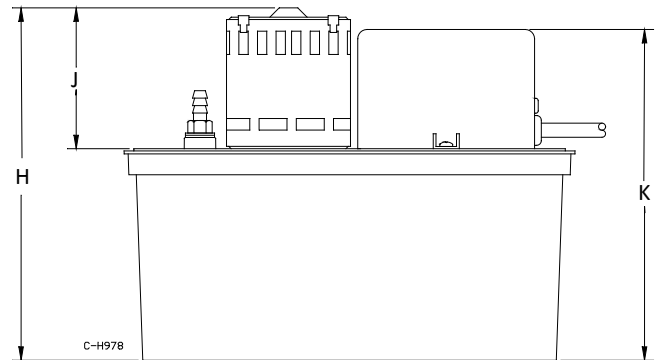
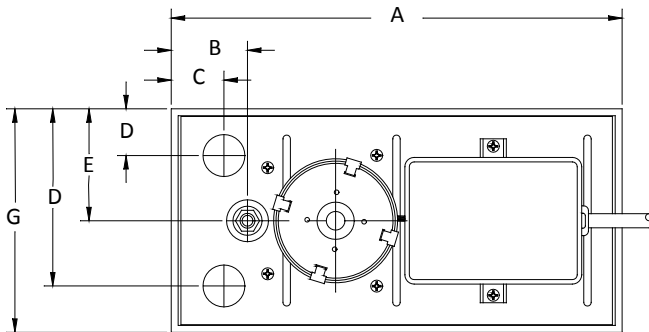

| A | B | C | D | E | F | G | H | J | K |
|---------------|--------------|-------------|--------------|----------|---------------|-----------|---------------|--------------|---------------|
| 12.1 (307.34) | 2.04 (51.82) | 1.4 (35.56) | 1.25 (31.75) | 3 (76.2) | 4.75 (120.65) | 6 (152.4) | 9.46 (240.28) | 3.78 (96.01) | 8.88 (225.55) |

PERFORMANCE DATA

115 V, 60 HZ

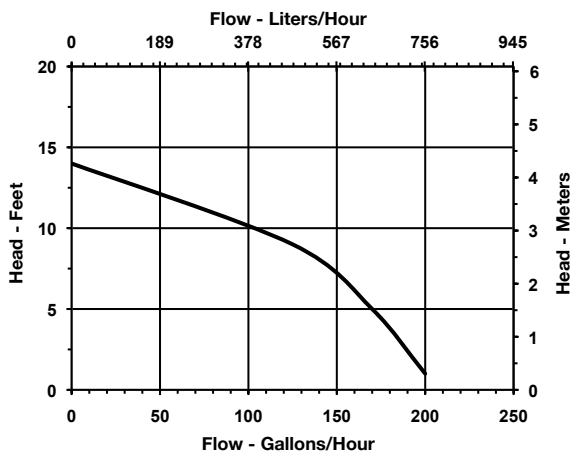

CONSTRUCTION

| | |
|-------------------|------------------|
| Motor | 1/50 hp |
| Discharge | 3/8" OD barbed |
| Pump Housing | ABS |
| Switch Housing | ABS |
| Tank | ABS |
| Tank Cover | Galvanized Steel |
| Motor Shaft | Stainless Steel |
| Impeller | Polypropylene |
| Discharge Adapter | Acetal |

VCL-24ULS SERIES

APPLICATIONS

- Designed for automatic collection and removal of condensate from air conditioning, refrigeration and dehumidification equipment when gravity drainage is not possible or practical. Also, suitable for high efficiency oil and gas-fired condensing furnace and condensing boiler equipment.

FEATURES

- 1 gallon collection tank
- Vertical centrifugal pump design
- 1/18 hp, fan cooled, concentric motor
- Stainless steel motor shaft
- Automatic start and stop operation
- Includes float (solid polymer) activated switch for automatic high-level water detection (overflow detection switch)
- Overflow detection switch: dual function NO and NC operation (set to NO from factory for equipment shut down connection)
- Overflow detection switch includes two 5" switch lead wires
- 3/8" barbed discharge adapter (for use with 3/8" I.D. vinyl tubing)* installed
- *Optional check valve adapter for 3/8" vinyl tubing included in box
- *Optional check valve for 3/8" O.D. copper tube sold separately (Part Number 599063)
- Two 1-1/8" diameter inlet openings
- Thermally protected, fan cooled motor
- Maximum water temperature: 120 °F
- 6 ft, 3-conductor cable with grounded 3-prong plug



SERIES SPECIFICATIONS

| Item No. | Model | HP | Input Voltage | Hz | Amps (FLA) | Watts (kW) | Discharge Size | Performance GPH (LPH) @ Head | | | | Shut-Off Ft. | PSI | Cord | Weight (lbs) |
|----------|------------|------|---------------|-------|------------|------------|-------------------------------------|------------------------------|-------------|-------------|-----------|--------------|------|-----------|----------------|
| | | | | | | | | 1' | 3' | 5' | 9' | | | | |
| 553206 | VCL-24UL | 1/18 | 115 | 60 | 2.5 | 148 | 1/4" FNPT x 3/8" (9.5 mm) OD Barbed | 270 (1023.3) | 260 (985.4) | 250 (947.5) | 210 (796) | 24 (7.3 m) | 10.4 | 6 (1.8 m) | 8.2 (3.7 Kg) |
| 553201 | VCL-24ULS | 1/18 | 115 | 60 | 2.5 | 148 | 1/4" FNPT x 3/8" (9.5 mm) OD Barbed | 270 (1023.3) | 260 (985.4) | 250 (947.5) | 210 (796) | 24 (7.3 m) | 10.4 | 6 (1.8 m) | 8.2 (3.7 Kg) |
| 14940371 | VCL-24ULS* | 1/18 | 115 | 60 | 2.5 | 148 | 1/4" FNPT x 3/8" (9.5 mm) OD Barbed | 270 (1023.3) | 260 (985.4) | 250 (947.5) | 210 (796) | 24 (7.3 m) | 10.4 | 6 (1.8 m) | 9.25 |
| 553211 | VCL-24ULS | 1/18 | 230 | 50/60 | 1.2 | 148 | 1/4" FNPT x 3/8" (9.5 mm) OD Barbed | 270 (1023.3) | 260 (985.4) | 250 (947.5) | 210 (796) | 24 (7.3 m) | 10.4 | 6 (1.8 m) | 8.2 (3.7 Kg) |
| 14940372 | VCL-24ULS* | 1/18 | 230 | 50/60 | 1.2 | 148 | 1/4" FNPT x 3/8" (9.5 mm) OD Barbed | 270 (1023.3) | 260 (985.4) | 250 (947.5) | 210 (796) | 24 (7.3 m) | 10.4 | 6 (1.8 m) | 9.25 (14.2 Kg) |

Note: 3/8" ID x 20 ft. tubing

VCL-24ULS SERIES

REPLACEMENT PARTS & KITS

| Item | Part Number |
|---------------------------|-------------|
| Tank | 153502 |
| Cover, Volute | 153110 |
| Impeller | 153131 |
| Adapter, 3/8" | 153300 |
| Seal Ring | 924038 |
| Switch, Pump | 950337 |
| Overflow Detection Switch | 950333 |

ENGINEERING DATA

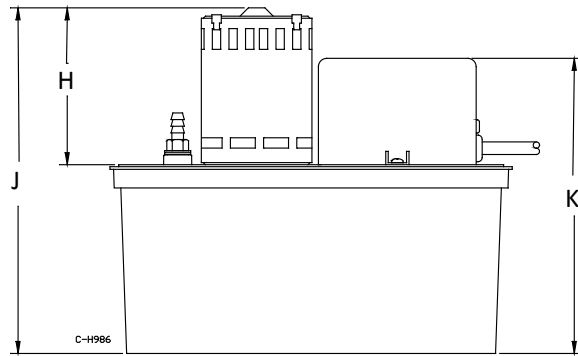
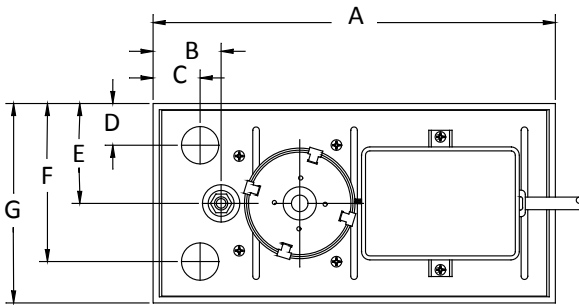

| A | B | C | D | E | F | G | H | J | K |
|----------------|--------------|----------|--------------|----------|---------------|-----------|---------------|---------------|---------------|
| 12.11 (307.59) | 2.04 (51.82) | 1 (25.4) | 1.25 (31.75) | 3 (76.2) | 4.75 (120.65) | 6 (152.4) | 4.72 (119.89) | 10.4 (264.16) | 8.88 (225.55) |

PERFORMANCE DATA

115 V, 60 HZ

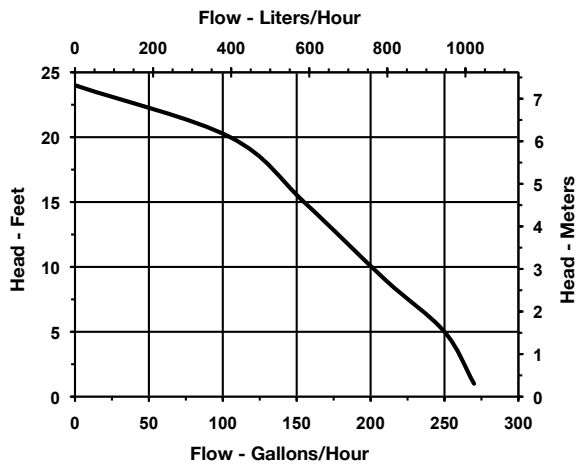

CONSTRUCTION

| | |
|-------------------|------------------|
| Pump Housing | ABS |
| Switch Housing | ABS |
| Tank | ABS |
| Tank Cover | Galvanized Steel |
| Motor Shaft | Stainless Steel |
| Impeller | Polypropylene |
| Discharge Adapter | Acetal |

VCL-45ULS SERIES

APPLICATIONS

- Designed for automatic collection and removal of condensate from air conditioning, refrigeration and dehumidification equipment when gravity drainage is not possible or practical. Also, suitable for high efficiency oil and gas-fired condensing furnace and condensing boiler equipment.

FEATURES

- 1 gallon collection tank
- Vertical centrifugal pump design
- 1/5 hp, fan cooled, PSC motor
- Stainless steel motor shaft
- Automatic start and stop operation
- Includes float (solid polymer) activated switch for automatic high-level water detection (overflow detection switch)
- Overflow detection switch: dual function NO and NC operation (set to NO from factory for equipment shut down connection)
- Overflow detection switch includes two 5" switch lead wires
- 3/8" O.D. copper tubing discharge
- *Optional check valve adapter for 3/8" O.D. copper tubing/3/8" I.D. vinyl tubing sold separately (Part Number 599064)
- 1-1/8" diameter inlet opening
- Thermally protected motor
- Maximum water temperature: 120 °F
- 6 ft, 3-conductor cable with grounded 3-prong plug



SERIES SPECIFICATIONS

| Item No. | Model | HP | Input Voltage | Hz | Amps (FLA) | Watts (kW) | Discharge Size | Performance GPH (LPH) @ Head | | | | | Shut-Off Ft. | PSI | Cord | Weight (lbs) |
|----------|-----------|-----|---------------|-------|------------|------------|-------------------------|------------------------------|--------------|--------------|--------------|--------------|--------------|------|-----------|--------------|
| | | | | | | | | 1' | 3' | 5' | 9' | 15' | | | | |
| 553240 | VCL-45ULS | 1/5 | 115 | 60 | 3.5 | 185 | 3/8" (9.5 mm) OD Copper | 450 (1705.5) | 445 (1686.6) | 440 (1667.6) | 415 (1572.9) | 380 (1440.2) | 45 (13.7 m) | 19.5 | 6 (1.8 m) | 13 (5.9 Kg) |
| 553245 | VCL-45ULS | 1/5 | 230 | 50/60 | 1.0 | 250 | 3/8" (9.5 mm) OD Copper | 450 (1705.5) | 445 (1686.6) | 440 (1667.6) | 415 (1572.9) | 380 (1440.2) | 45 (13.7 m) | 19.5 | 6 (1.8 m) | 14 (6.4 Kg) |

VCL-45ULS SERIES

REPLACEMENT PARTS & KITS

| Item | Part Number |
|---------------------------|-------------|
| Tank | 153502 |
| Cover, Switch Assy. | 153537 |
| Seal Ring | 928025 |
| Impeller | 153520 |
| Switch, Pump | 950337 |
| Overflow Detection Switch | 950333 |

ENGINEERING DATA

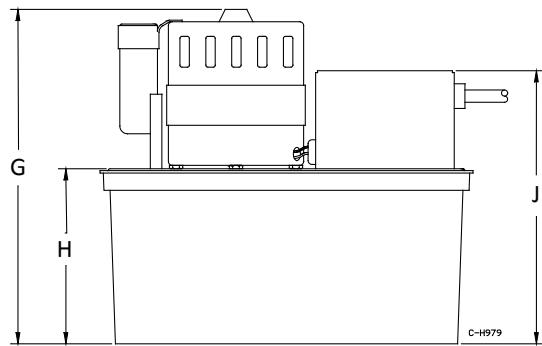
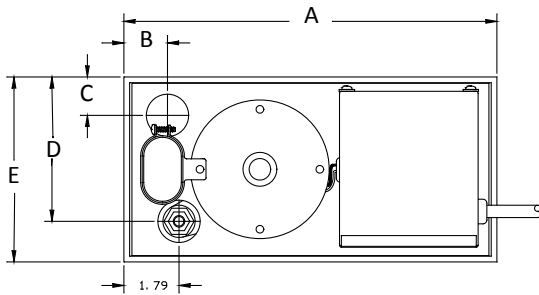

| A | B | C | D | E | F | G | H | J |
|----------------|--------------|--------------|---------------|-----------|--------------|----------------|---------------|---------------|
| 12.11 (307.59) | 1.42 (36.07) | 1.24 (31.50) | 4.68 (118.87) | 6 (152.4) | 1.79 (45.47) | 10.85 (275.59) | 5.68 (144.27) | 8.86 (225.04) |

PERFORMANCE DATA

115 V, 60 HZ

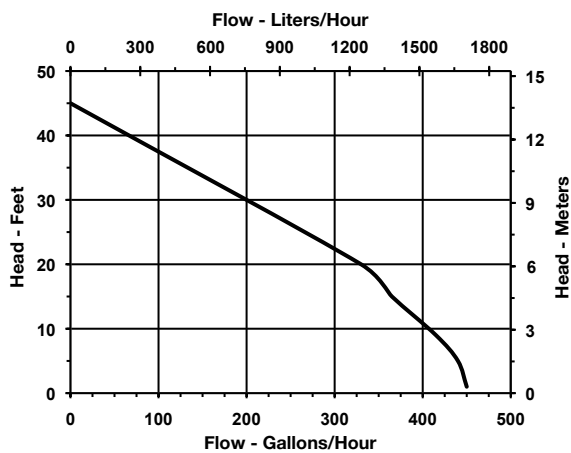

CONSTRUCTION

| | |
|----------------|------------------|
| Pump Housing | ABS |
| Switch Housing | ABS |
| Tank | ABS |
| Tank Cover | Galvanized Steel |
| Motor Shaft | Stainless Steel |
| Impeller | Polypropylene |
| Discharge | 3/8" copper tube |

1-ABS SERIES

APPLICATIONS

- Utilizing a sealed, submersible pump with sump-type pick-up, the 1-ABS offers low on and off levels and is ideal for in-pan placement for condensate removal. An integrated, unique float switch design assures reliability and security while providing easy access to the float for servicing.

FEATURES

- Permanently lubricated motor bearings require no maintenance during life of pump
- Oil-filled to maximize heat dissipation
- Epoxy-coated cast aluminum pump housing
- Automatic on-off operation
- Easy to remove float housing for servicing
- Includes removable inlet filter screen
- Includes 90° 1/4" MNPT adapter (suitable for 1/2" I.D. vinyl tubing)
- Low on and off level – turns on at 1-3/4" and off at 1-1/4" – will operate in most standard condensate drain pans
- Includes 9 ft power cord with molded plug (115 V versions)
- Item 550522 includes tank
- Suitable for intermittent water temperature up to 120 °F



SERIES SPECIFICATIONS

| Item No. | Model | HP | Input Voltage | Hz | Amps (FLA) | Watts (kW) | Discharge Size | Performance GPH (LPH) @ Head | | | Shut-Off Ft. | PSI | Cord | Weight (lbs) |
|----------|-----------------|-------|---------------|-------|------------|------------|----------------|------------------------------|-------------|-------------|--------------|-----|-------------|----------------|
| | | | | | | | | 1' | 3' | 5' | | | | |
| 550521 | 1-ABS | 1/150 | 115 | 60 | 1.1 | 70 | 1/4" MNPT | 205 (777) | 180 (682.2) | 145 (549.6) | 10' (3 m) | 4.3 | 9' (2.7 m) | 4.11 (1.86 Kg) |
| 550532 | 1-ABS | 1/150 | 230 | 50/60 | 0.6/0.5 | 70 | 1/4" MNPT | 205 (777) | 180 (682.2) | 145 (549.6) | 10' (3 m) | 4.3 | 11' (3.4 m) | 4.31 (1.95 Kg) |
| 550522 | 1-ABS with tank | 1/150 | 115 | 60 | 1.1 | 70 | 1/4" MNPT | 205 (777) | 180 (682.2) | 145 (549.6) | 10' (3 m) | 4.3 | 9' (2.7 m) | 4.35 (1.97 Kg) |

1-ABS SERIES

REPLACEMENT PARTS & KITS

| Item | Part Number |
|-------------------|--------------------------|
| Volute | 116375 |
| Impeller | 116437 |
| Seal Ring | 928007 |
| Screen | 101376 |
| Tank | 150102 (for 550552 only) |
| Float Replacement | 950060 |
| Float Screen | 950284 |

ENGINEERING DATA

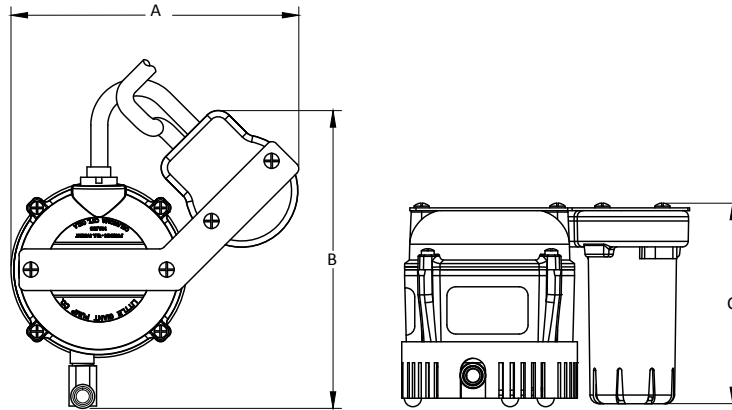

| A | B | C |
|--------------|--------------|--------------|
| 6.09 (154.7) | 6.32 (160.5) | 4.31 (109.5) |

PERFORMANCE DATA

115 V, 60 HZ

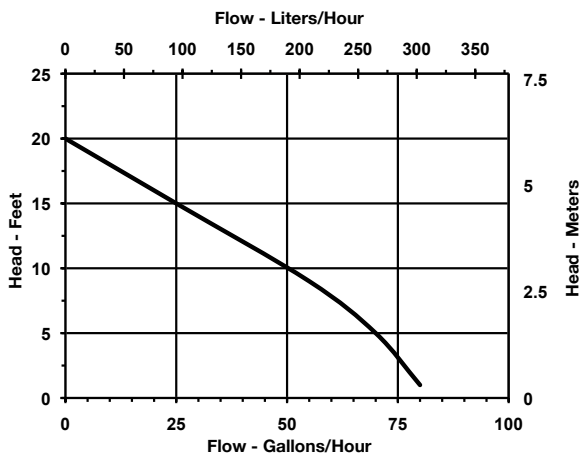

CONSTRUCTION

| | |
|----------------|----------------------------|
| Motor | 1/50 hp |
| Discharge | 1/4" MNPT |
| Housing | Epoxy-coated cast aluminum |
| Cover | Epoxy-coated cast aluminum |
| Volute | Nylon |
| Impeller | Nylon |
| Shaft Seal | Nitrile |
| Screen | Polypropylene |
| Switch Bracket | Stainless steel |
| Switch | ABS |

2-ABS SERIES

APPLICATIONS

- Utilizing a sealed submersible pump, the 2-ABS is ideal for in-pan placement for condensate removal. An integrated unique float switch design assures reliability and security while providing easy access to the float for servicing.

FEATURES

- Permanently lubricated motor bearings require no maintenance during life of pump
- Oil-filled to maximize heat dissipation
- Epoxy-coated cast aluminum pump housing
- Easy to remove float housing for servicing
- Includes removable inlet filter screen
- ¼" MNPT discharge is suitable for ½" I.D. vinyl tubing
- Automatic operation:
On level: 3" Off Level: 2"
- Suitable for intermittent water temperature up to 120 °F
- Includes 9 ft power cord with molded plug (115 V version)



SERIES SPECIFICATIONS

| Item No. | Model | HP | Input Voltage | Hz | Amps (FLA) | Watts (kW) | Discharge Size | Performance GPH (LPH) @ Head | | | | Shut-Off Ft. | PSI | Cord | Weight (lbs) |
|----------|-------|------|---------------|-------|------------|------------|----------------|------------------------------|-------------|-----------|------------|---------------|-----|-------------|--------------|
| | | | | | | | | 1' | 3' | 5' | 10' | | | | |
| 551020 | 2-ABS | 1/40 | 115 | 60 | 1.7 | 100 | 1/4" MNPT | 300 (1137) | 255 (966.5) | 205 (777) | 70 (265.3) | 11.8' (3.6 m) | 5.1 | 9' (2.7 m) | 6.8 (3.1 Kg) |
| 551030 | 2-ABS | 1/40 | 230 | 50/60 | 0.9/0.7 | 100 | 1/4" MNPT | 300 (1137) | 255 (966.5) | 205 (777) | 70 (265.3) | 11.8' (3.6 m) | 5.1 | 11' (3.4 m) | 7 (3.12 Kg) |

2-ABS SERIES

REPLACEMENT PARTS & KITS

| Item | Part Number |
|-------------------|-------------|
| Volute | 102378 |
| Impeller | 102470 |
| Seal Ring | 102601 |
| Screen | 101376 |
| Tank | 150102 |
| Float Replacement | 950061 |
| Float Screen | 950284 |

ENGINEERING DATA

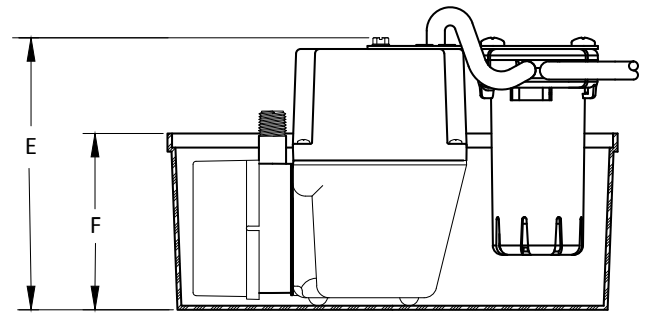
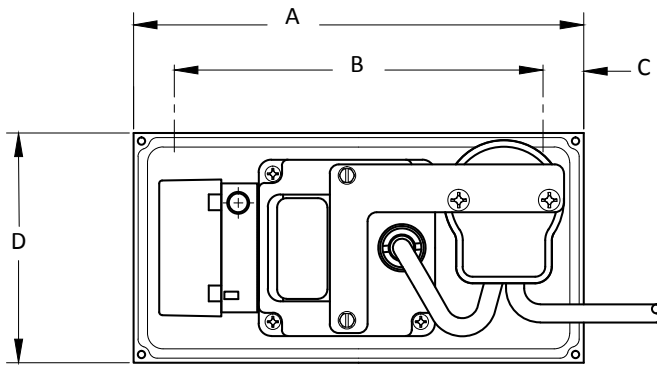

C-M989

| A | B | C | D | E | F |
|---------------|---------------|--------------|---------------|--------------|------------|
| 8.94 (227.08) | 7.32 (185.93) | 0.81 (20.57) | 4.56 (115.82) | 4.9 (124.46) | 3.5 (88.9) |

PERFORMANCE DATA

115 V, 60 HZ

Flow - Liters/Hour

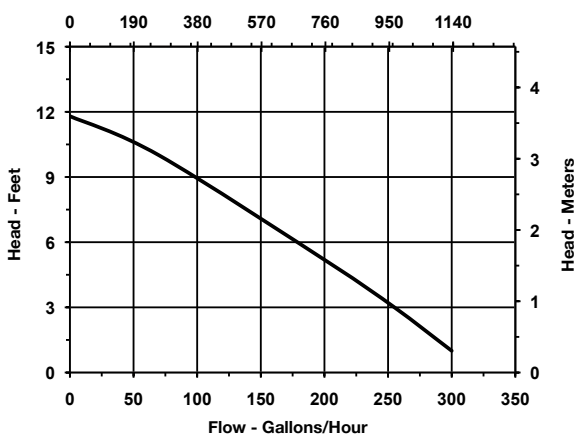

CONSTRUCTION

| | |
|----------------|----------------------------|
| Motor | 1/40 hp |
| Discharge | 1/4" MNPT |
| Housing | Epoxy-coated cast aluminum |
| Cover | Epoxy-coated cast aluminum |
| Volute | Nylon |
| Impeller | Nylon |
| Shaft Seal | Nitrile |
| Screen | Polyethylene |
| Switch Bracket | Stainless steel |

3-ABS SERIES

APPLICATIONS

- Utilizing a sealed, submersible pump with collection tank, the 3-ABS is an ideal choice for a self-contained, high volume, high head condensate removal pump. An integrated, unique float switch design assures reliability and security while providing easy access to the float for servicing.

FEATURES

- Includes 1 gallon ABS tank
- Permanently lubricated motor bearings require no maintenance during life of pump
- Oil-filled to maximize heat dissipation
- Epoxy-coated cast aluminum pump housing
- Galvanized steel tank cover has 1-1/8" inlet opening
- Automatic operation:
On level – 4.5" Off Level – 3.5"
- Easy to remove float housing for servicing
- Includes removable inlet filter screen
- 1/2" MNPT pump discharge with brass check valve and compression fitting for 1/2" OD copper or rigid plastic tubing
- Powerful 1/12 hp pump motor
- Suitable for intermittent water temperature up to 120 °F
- Includes 9 ft power cord with molded plug (115 V version)



SERIES SPECIFICATIONS

| Item No. | Model | HP | Input Voltage | Hz | Amps (FLA) | Watts (kW) | Discharge Size | Performance GPH (LPH) @ Head | | | | | Shut-Off Ft. | PSI | Cord | Weight (lbs) |
|----------|-------|------|---------------|-------|------------|------------|----------------|------------------------------|--------------|--------------|-------------|-----------|--------------|------|------------|--------------|
| | | | | | | | | 1' | 3' | 5' | 10' | 20' | | | | |
| 551320 | 3-ABS | 1/12 | 115 | 60 | 3.5 | 210 | 1/2" MNPT | 310 (1175) | 290 (1099.1) | 280 (1061.2) | 250 (947.5) | 110 (417) | 26' (7.9 m) | 11.2 | 9' (2.7 m) | 12 (5.44 Kg) |
| 551330 | 3-ABS | 1/12 | 230 | 50/60 | 1.8/1.6 | 210 | 1/2" MNPT | 310 (1175) | 290 (1099.1) | 280 (1061.2) | 250 (947.5) | 110 (417) | 26' (7.9 m) | 11.2 | 9' (2.7 m) | 12 (5.44 Kg) |

3-ABS SERIES

REPLACEMENT PARTS & KITS

| Item | Part Number |
|-------------------|-------------|
| Tank | 153502 |
| Cover | 151410 |
| Check Valve | 940003 |
| Volute | 103376 |
| Impeller | 104435 |
| Gasket | 103601 |
| Float Replacement | 950061 |
| Float Screen | 950284 |
| Elbow, Inlet | 119007 |

ENGINEERING DATA

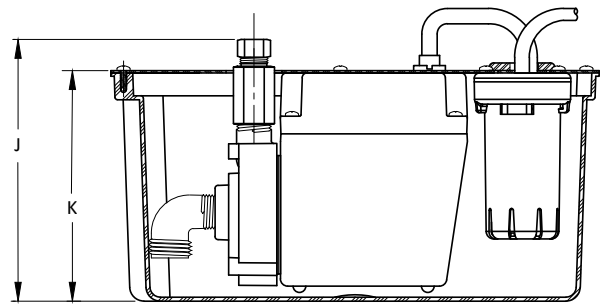
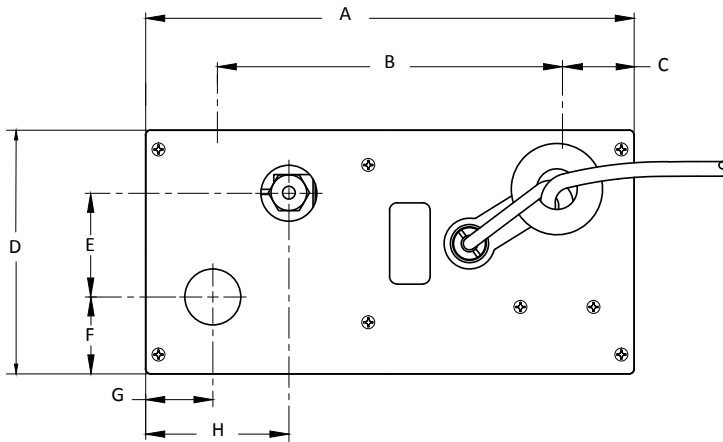

| A | B | C | D | E | F | G | H | J | K |
|----------------|-------------|--------------|-----------|--------------|--------------|--------------|--------------|-------------|---------------|
| 12.03 (305.56) | 8.5 (215.9) | 1.77 (44.96) | 6 (152.4) | 2.55 (64.77) | 1.89 (48.01) | 1.66 (42.16) | 3.53 (89.66) | 6.5 (165.1) | 5.68 (144.27) |

PERFORMANCE DATA

115 V, 60 HZ

Flow - Liters/Hour

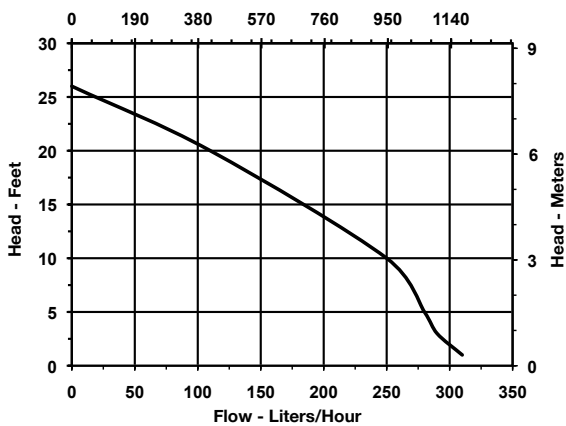

CONSTRUCTION

| | |
|---------------------------|----------------------------|
| Motor | 1/12 hp |
| Intake | 1-1/4" diameter |
| Discharge | 1/2" MNPT |
| Pump Housing/Cover | Epoxy-coated cast aluminum |
| Tank Cover | Galvanized steel |
| Volute | Nylon |
| Impeller | Nylon |
| Shaft Seal | Nitrile |
| Screen | Polyethylene |

EC-1-DV SERIES

APPLICATIONS

- The EC-1-DV model is designed to accommodate multiple electrical requirements within one pump. The DV suffix indicates that the pump is capable of operating from a wide range of supply voltage to maintain consistent pump performance.
- The EC-1-DV Series is a new concept for mini pumps incorporating an improved noise reducing design and reliable solid-state switching technology. Easy to install brackets provide a quick and precise method to accurately position and secure both parts of the pump quickly. The two-piece design allows the reservoir to be placed within the air handler while the pump-controller is located outside the air handler. The two components are connected via a convenient communications wire and suction tubing.
- EC-1-DV is designed for use in removing condensate from wall mount, ductless mini-split air conditioners up to 34,000 Btu. It can also be used to remove condensate from fan coils and suspended ceiling air conditioners. The pump can be installed above the air conditioner in a false ceiling, behind the wall mount air handler, or in plastic conduit or line-set channel. The reservoir, featuring a clear tank, connects to the condensate drain hose and must be positioned flat and horizontal while the pump can be oriented in any position within 3.3 ft.



FEATURES

Pump - Controller

- Normally-closed relay rated at 8 A resistive - 250 V alarm
- 21 dB(A)*
- 1/4" I.D. pump discharge outlet
- Elastomeric mounting grommets on pump housing bracket
- Elastomeric passive vibration isolator used to dampen pump vibration
- Separate wall bracket for pump and reservoir included
- Thermal protection: 176 °F
- 60" power cable
- 3.3' communications cable (pump to reservoir)
- Ambient temperature range: 32 °F - 140 °F
- Maximum water temperature: 140 °F
- 2-year warranty

Reservoir

- Clear reservoir for instant visual inspection of water level, float, and filter
- Hall effect on/off level sensors with high-water sensor feature
- Extra-large filter screen for longer intervals between cleaning
- Multi-step drain hose adapter (1/2", 5/8", and 3/4")
- Simple to open reservoir for easy maintenance

EC-1-DV SERIES

SERIES SPECIFICATIONS

| Item No. | Model | Input Voltage | Hz | Amps (FLA) | Watts (kW) | Discharge Size | Performance GPH (LPH) @ Head | | | | | Shut-Off Ft. | Suction Lift | PSI | Cord | Weight (lbs) |
|----------|---------|---------------|-------|------------|------------|----------------|------------------------------|-----------|-----------|-----------|-----------|--------------|--------------|-----|-------------|---------------|
| | | | | | | | 0' | 1' | 5' | 10' | 20' | | | | | |
| 553507 | EC-1-DV | 110-240 | 50/60 | 0.18 | 18 | 1/4" | 2.7 (10) | 2.5 (9.5) | 1.8 (6.8) | 1.5 (5.7) | 1.2 (4.5) | 33 (10m) | 3' (.91 m) | 26 | 4.9 (1.5 m) | 1.7 (0.77 Kg) |

ENGINEERING DATA

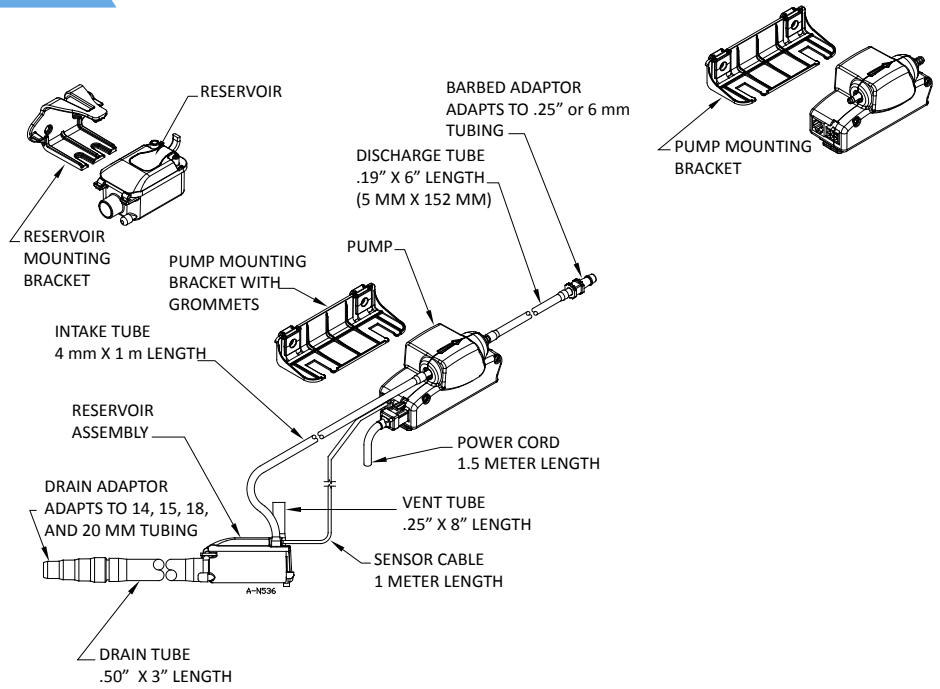
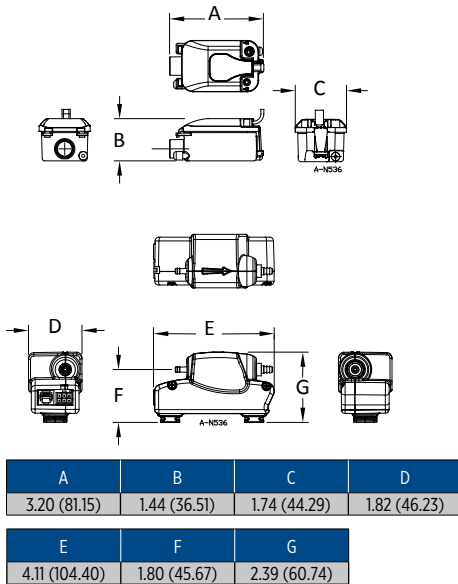

PERFORMANCE DATA

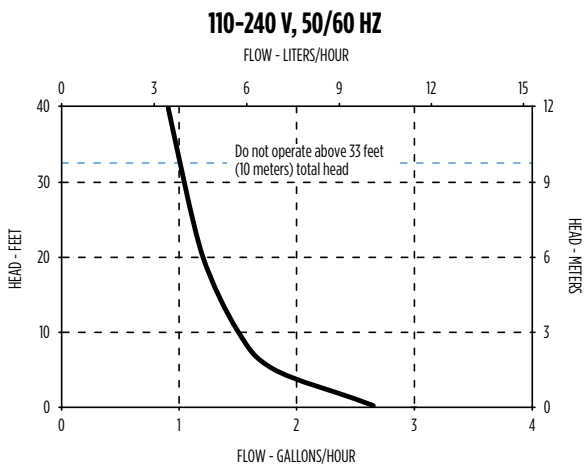

*Tested under conditions assumed consistent with competitors' published sound ratings.

EC-1K-DV SERIES

APPLICATIONS

- The EC-1K-DV model is designed to accommodate multiple electrical requirements within one pump. The DV suffix indicates that the pump is capable of operating from a wide range of supply voltage to maintain consistent pump performance.
- EC-1K-DV Line Set Duct provides space to install the EC-1-DV, line-set pipes, electrical wiring and drain hoses providing a clean, finished look in any décor. The pump is easily accessible for maintenance or cleaning by removing the cover (no tools required). When using the EC-1K-DV Line Set Duct, the EC-1-DV pump is always properly positioned to maximize the quiet operation of the pump and keep the reservoir level for ideal operating performance.

FEATURES

- Includes **EC-1-DV Mini Condensate Pump**
- 21 dB(A)*
- 2.7 gph (10 lph) flow
- 33 ft (10 m) shut off (max. recommended)
- Hall effect switching
- Large inlet filter
- Multi-size hose drain adapter fits all popular drain hose connections
- 2-year warranty

Line Set Kit

- Right- or left-side installation options
- 2.1" x 3.0" (5.3 cm x 7.6 cm) Line Set Duct inside dimension
- 19.7" (50 cm) drain hose tubing
- Detachable power cord 84" (213.4 cm)
- 90° "elbow" for locating pump reservoir
- 31.5" (80 cm) straight line set cover
- Room inside Line Set Duct for 3/8" and 5/8" line set pipe
- Twist motion snap-lock clips and cable ties to secure the line set
- Pump enclosure and pump mounting bracket
- Wall fasteners included (to secure Line Set Duct to wall)
- Air conditioner trim and bracket for "finished" look
- Includes ceiling plate when pump enclosure



EC-1K-DV SERIES

SERIES SPECIFICATIONS

| Item No. | Model | Input Voltage | Hz | Amps (FLA) | Watts (kW) | Discharge Size | Performance GPH (LPH) @ Head | | | | | Shut-Off Ft. | Suction Lift | PSI | Cord | Weight (lbs) | Dimensions (H x L x W in) |
|----------|----------|---------------|-------|------------|------------|----------------|------------------------------|-----------|-----------|-----------|-----------|--------------|--------------|-----|-------------|---------------|---|
| | | | | | | | 0' | 1' | 5' | 10' | 20' | | | | | | |
| 553517 | EC-1K-DV | 110-240 | 50/60 | 0.18 | 18 | 1/4" | 2.7 (10) | 2.5 (9.5) | 1.8 (6.8) | 1.5 (5.7) | 1.2 (4.5) | 33 (10m) | 3' (.91 m) | 26 | 4.9 (1.5 m) | 1.7 (0.77 Kg) | 4.1" x 1.8" x 2.4" (10.4 cm x 4.6 cm x 6.1 cm) |

ENGINEERING DATA

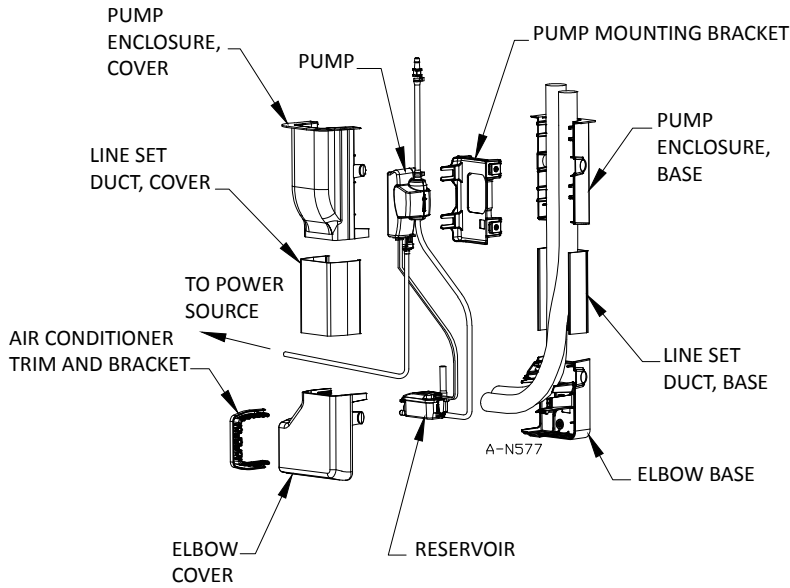

PERFORMANCE DATA

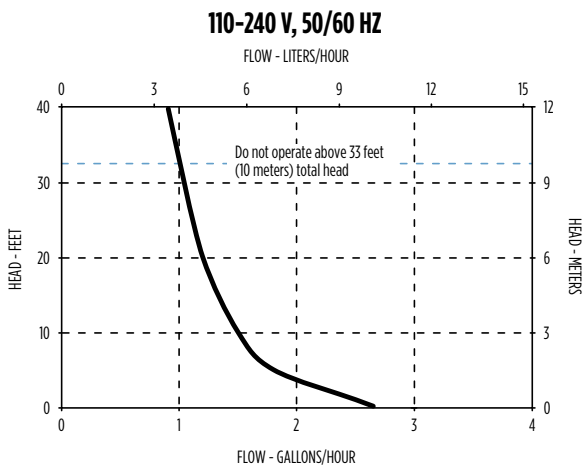

*Tested under conditions assumed consistent with competitors' published sound ratings.

EC-OP-K SERIES

APPLICATIONS

- Removes condensate from wall mounted, ceiling and fan coil air conditioning equipment up to 34,000 BTU

FEATURES

- Pump float retainer for easy serviceability
- Clear reservoir for visual inspection of water level, float and filter
- 8A resistive – 250 V alarm contact
- 5/16" inlet tubing with universal adapter
- 5/32" discharge tubing with 1/4" adapter
- 5/32" discharge tubing
- Ambient temperature range 32 ° - 104 °F
- 176 °F thermal protection
- Alarm ready, suitable for Building Automation System
- Easy to install mounting bracket (kit only)
- Quiet operation
- Stylish pump unit cover – fits any décor (kit only)
- Easy to service without removing from the wall
- Requires no space inside the wall mount air conditioner

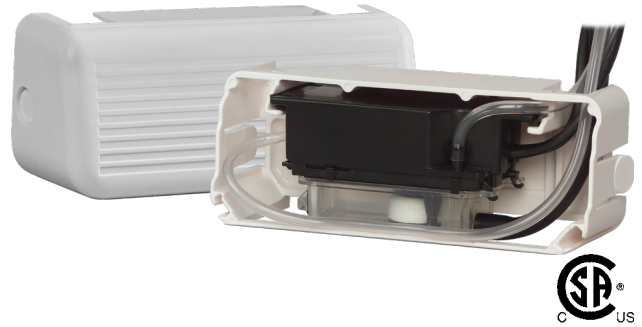

SERIES SPECIFICATIONS

| Item No. | Model | Input Voltage | Hz | Amps (FLA) | Watts (kW) | Performance GPH (LPH) @ Head | | | | | | Shut-Off Ft. | PSI | Weight (lbs) |
|----------|---------|---------------|-------|------------|------------|------------------------------|------------|----------|------------|---------|-----------|----------------|-----|--------------|
| | | | | | | 2' | 4' | 6' | 8' | 12' | 20' | | | |
| 553712 | EC-OP-K | 230 | 50/60 | 0.1 | 20 | 3.6 (13.6) | 3.3 (12.5) | 3 (11.4) | 2.7 (10.2) | 2 (7.6) | 1.2 (4.5) | 34.77 (10.6 m) | 15 | 3 (1.4 KG) |

EC-OP-K SERIES

ENGINEERING DATA

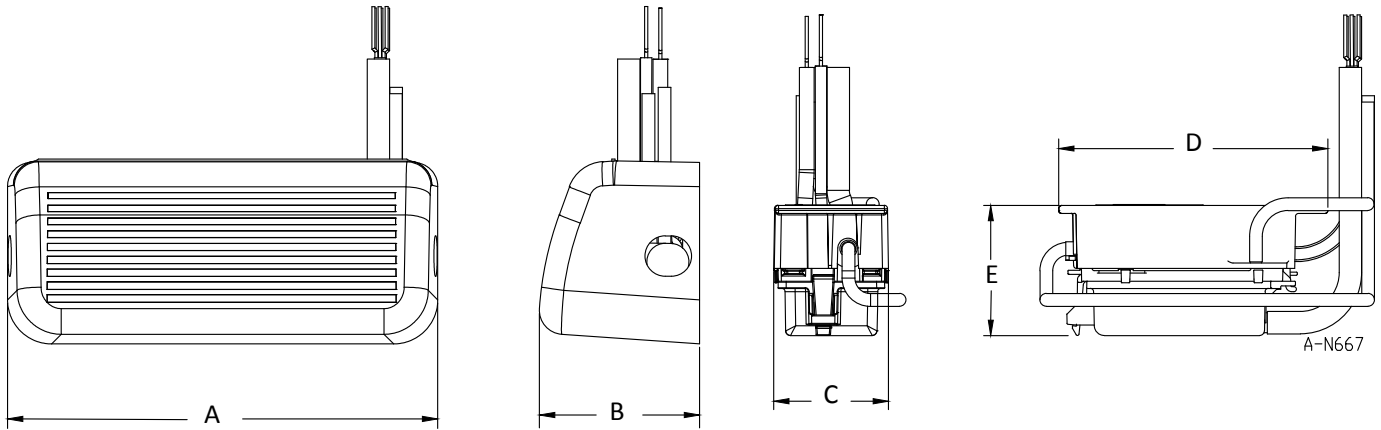

| A | B | C | D | E |
|---------------|--------------|--------------|---------------|--------------|
| 8.43 (214.12) | 3.14 (79.76) | 2.25 (57.15) | 5.27 (113.86) | 2.55 (64.77) |

PERFORMANCE DATA

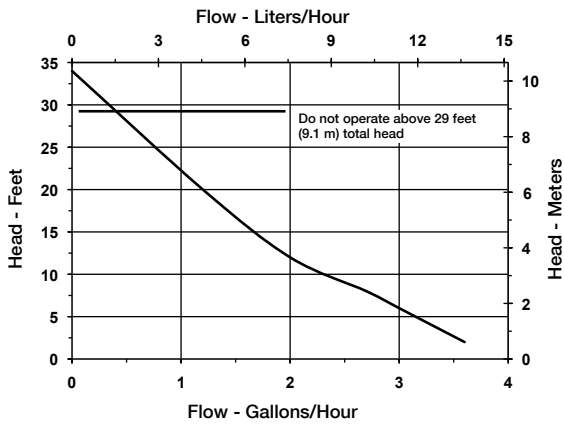

CONSTRUCTION

| | |
|----------------------|---------------------|
| Material | Flame retardant ABS |
| Fuse | 3A max |
| Filter Screen | Stainless steel |

TP SERIES

APPLICATIONS

- Self-priming pump that removes condensate from air conditioning systems

FEATURES

- Quiet operation
- 1/4" inlet and outlet adapter
- 6.5' of suction lift
- 46' shut off head
- 5-minute stop delay on TPT model
- Run dry capabilities
- Test switch
- Wall mounting bracket
- Quick and easy peristaltic tube replacement
- Thermoplastic peristaltic tube
- Pump not affected by dust, tobacco smoke, algae, mold or bacteria found in condensate water
- Peristaltic tube housing provides reinforced surface for peristaltic tube to be compressed



SERIES SPECIFICATIONS

| Item No. | Model | Input Voltage | Hz | Amps (FLA) | Watts (kW) | Shut-Off Ft. | Suction Lift | Max Flow GPM (LPM) | Lead Length | Weight (lbs) | Dimensions (H x L x W) |
|-----------------|-------|---------------|-------|------------|------------|--------------|--------------|--------------------|-------------|---------------|--|
| 553674 | TPS | 230 | 50/60 | 0.06 | 13 | 46 (14.02 m) | 6.5' (2 m) | 2.5 (9.5) | 72" (182.9) | 2.3 (1.04 Kg) | 4.5" x 3.8" x 3.9" (11.4 cm x 9.7 cm x 9.9 cm) |
| 553675 | TPT | 230 | 50/60 | 0.06 | 13 | 46 (14.02 m) | 6.5' (2 m) | 2.5 (9.5) | 72" (182.9) | 2.3 (1.04 Kg) | 4.5" x 3.8" x 3.9" (11.4 cm x 9.7 cm x 9.9 cm) |
| 553676 | TPR | 230 | 50/60 | 0.06 | 13 | 46 (14.02 m) | 6.5' (2 m) | 2.5 (9.5) | 72" (182.9) | 2.3 (1.04 Kg) | 4.5" x 3.8" x 3.9" (11.4 cm x 9.7 cm x 9.9 cm) |
| Reservoir | | | | | | | | | | | 3.25" x 3.4" x 4.5" (8.25 cm x 8.6 cm x 11.4 cm) |
| Pump/Controller | | | | | | | | | | | 3.9" X 1.5" x 1.5" (9.9 cm x 3.8 cm x 3.8 cm) |



TPS Series Pump is connected directly to air conditioner and operates when air conditioner is on.



TPT Series Pump is controlled by changes in temperature of the air moving through the air condition coil. Thermal sensors constantly measure difference of "air in" and "air out". When temperature difference reaches 10 °F, pump starts. Sensor cable is 6.5 ft.



TPR Series Pump is controlled by float-operated switches and activates when water enters float reservoir. It incorporates overflow control circuit with 5 A volt-free alarm circuit. Reservoir cable is 3 ft.

TP SERIES

REPLACEMENT PARTS & KITS

| Description | Part Number | Used on Model |
|---|-------------|-------------------|
| Tube, Natural Rubber | 944322 | TPR |
| Reservoir Assembly | 153781 | TPR |
| Temperature Sensor Cable Assembly | 951584 | TPT |
| T-RPCT-RPC-10 Replacement Tube Assembly | 599270 | TPS, TPT, and TPR |
| PC-10-PRK Pump Repair Kit | 599325 | TPS, TPT, and TPR |
| ERC | 599170 | TPT and TPR |

ENGINEERING DATA

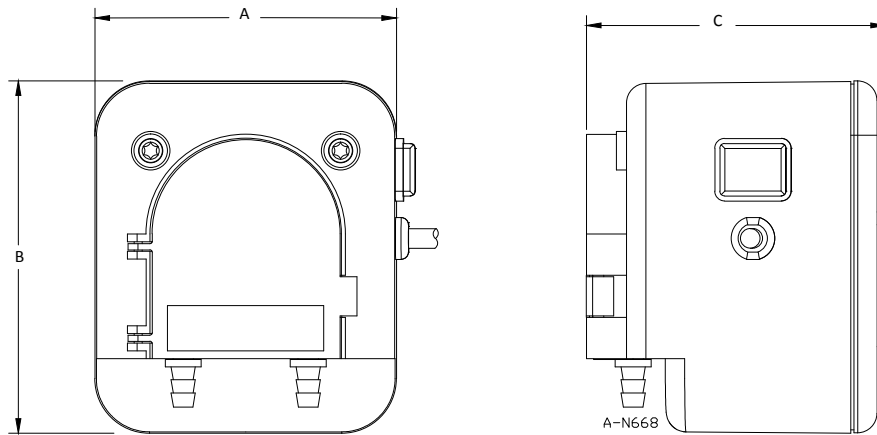

| A | B | C |
|-------------|-------------|-------------|
| 3.8 (96.52) | 4.5 (114.3) | 3.9 (99.06) |

PERFORMANCE DATA

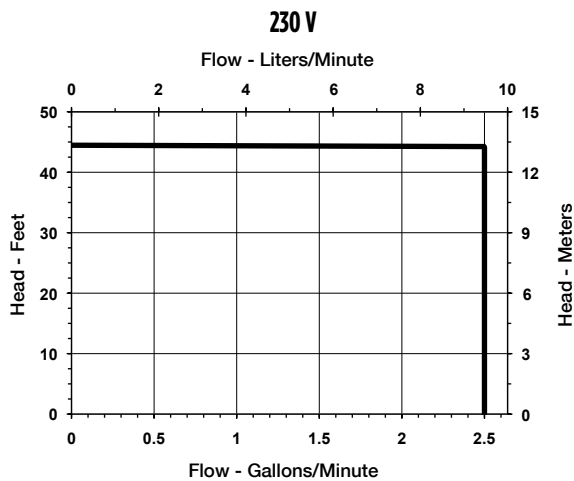

CONSTRUCTION

| | |
|-------------------------|---------------------------------|
| Volute | Polycarbonate |
| Impeller | Polycarbonate |
| Housing | Polycarbonate |
| Cover | Polycarbonate |
| Volute Tube | Thermoplastic Vulcanizate (TPV) |
| Tube Adapters | Acetal (POM) Homopolymer |
| Rollers | Acetal |
| Volute Cover | Polycarbonate |
| Mounting Bracket | ABS |

CP SERIES

APPLICATIONS

- For use in evaporative coolers, sales displays, laboratories, water bath circulation and many other uses. Ideal as a universal OEM replacement pump
- Ideal for residential, commercial, and industrial cooler pump replacement

FEATURES

- High quality concentric fan-cooled double coil motor
- Thermal overload protection
- One-piece corrosion resistant steel shaft
- Universal mounting configurations
- 45° discharge adapter
- Optional 90° elbow with bleed off port included
- Low pump down and recovery level
- Grounded electric plug
- 5 ft electric cord on CP1 and CP2 models
- 6 ft electric cord on CP3 models
- Flame retardant housing
- Snap-off volute plate for easy cleaning



SERIES SPECIFICATIONS

| Item No. | Model | HP | Input Voltage | Hz | Amps (FLA) | Watts (kW) | Discharge Size | Performance GPH (LPH) @ Head | | | | Shut-Off Ft. | PSI | Cord | Weight (lbs) |
|----------|---------|------|---------------|-------|------------|------------|------------------|------------------------------|------------|------------|-----------|--------------|-----|-----------|--------------|
| | | | | | | | | 1' | 3' | 5' | 10' | | | | |
| 540005 | CP1-115 | 1/70 | 115/127 | 60 | 0.8 | 70 | 1/2", 5/8", 3/4" | 307 (1164) | 265 (1004) | 213 (807) | - | 9.5 (2.9 m) | 4.1 | 5 (1.5 m) | 2.5 (1.1 Kg) |
| 540015 | CP1-230 | 1/70 | 230 | 50/60 | 0.4 | 70 | 1/2", 5/8", 3/4" | 307 (1164) | 265 (1004) | 213 (807) | - | 9.5 (2.9 m) | 4.1 | 5 (1.5 m) | 2.5 (1.1 Kg) |
| 541005 | CP2-115 | 1/50 | 115 | 60 | 1.0 | 80 | 5/8", 3/4" | 502 (1903) | 440 (1668) | 371 (1406) | 89 (337) | 11 (3.4 m) | 4.8 | 5 (1.5 m) | 3 (1.4 Kg) |
| 541015 | CP2-230 | 1/50 | 230 | 50/60 | 0.5 | 80 | 5/8", 3/4" | 502 (1903) | 440 (1668) | 371 (1406) | 89 (337) | 11 (3.4 m) | 4.8 | 5 (1.5 m) | 3 (1.4 Kg) |
| 542005 | CP3-115 | 1/30 | 115 | 60 | 1.1 | 90 | 5/8", 3/4" | 563 (2134) | 512 (1941) | 460 (1743) | 231 (876) | 12 (3.7 m) | 5.2 | 6 (1.8 m) | 3.5 (1.6 Kg) |
| 542015 | CP3-230 | 1/30 | 230 | 50/60 | 0.56 | 90 | 5/8", 3/4" | 563 (2134) | 512 (1941) | 460 (1743) | 231 (876) | 12 (3.7 m) | 5.2 | 6 (1.8 m) | 3.5 (1.6 Kg) |

CP SERIES

ENGINEERING DATA

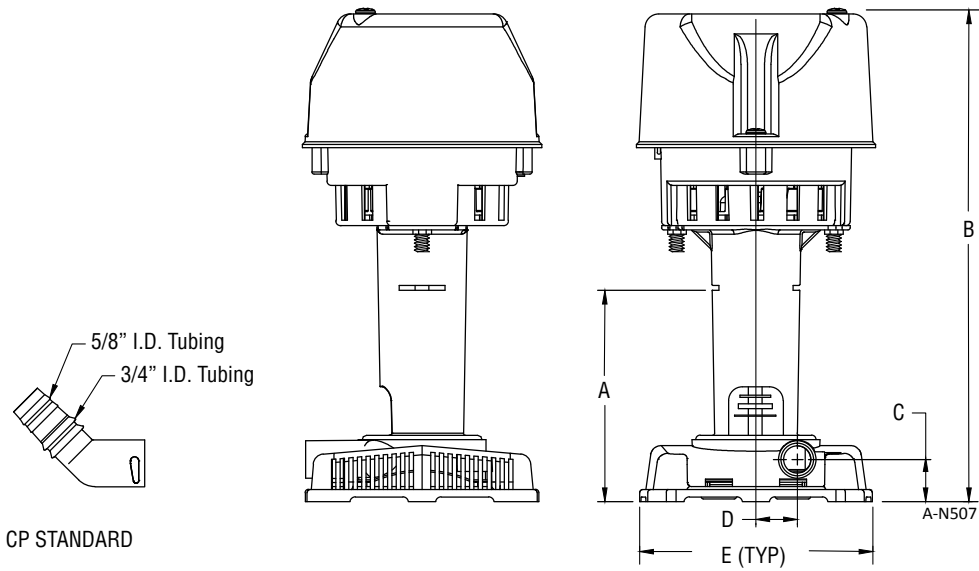

| A | B | C | D | E |
|--------------|---------------|-------------|--------------|---------------|
| 3.85 (97.79) | 8.95 (227.33) | 0.8 (20.32) | 0.78 (19.81) | 4.25 (107.95) |

PERFORMANCE DATA

115 V, 60 HZ

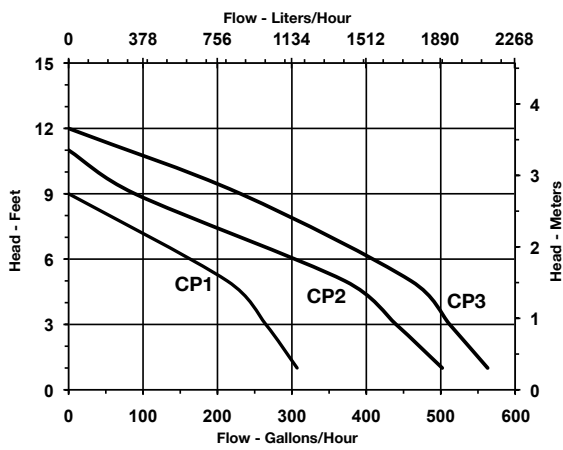

CONSTRUCTION

| | |
|------------------|---------------------------------|
| Motor | Heavy duty fan cooled |
| Housing | Flame retardant thermal plastic |
| Motor Cover | Flame retardant thermal plastic |
| Volute | Flame retardant thermal plastic |
| Impeller | Polyester |
| Mounting Bracket | Galvanized steel |

RIM-U SERIES

APPLICATIONS

- Commercial ice machine universal replacement water pump

FEATURES

- Dual voltage (115/230 V, 50/60 Hz) 1/25 hp fan cooled motor
- Upper and lower sealed ball bearings
- Thermally protected
- Moisture proof windings
- Corrosion resistant stainless steel motor shaft
- 3 ft 4-wire leads
- Pump easily disassembles for installing and servicing
- Designed to re-use original ice machine OEM pump mounting bracket
- Multiple impellers (included) to match most US-made ice machine OEM water pump specifications
- Multiple discharge adapters (included) to match most US-made ice machine OEM water pumps specifications, including 1/2", 5/8", 3/4", 1", plus a "Y" adapter for 5/8" tubing



SERIES SPECIFICATIONS

| Item No. | Model | HP | Input Voltage | Hz | Amps (FLA) | Watts (kW) | Discharge Size | Lead Wires (ft) | Weight (lbs) |
|----------|-------|------|---------------|-------|------------|------------|-----------------------------------|-----------------|---------------|
| 545600 | RIM-U | 1/25 | 115/230 | 50/60 | 1.5/.75 | 125 | 1/2", 5/8", 3/4", 1", 5/8" Y O.D. | 3 (0.9 m) | 4.31 (2.0 Kg) |

RIM-U SERIES

REPLACEMENT PARTS & KITS

| Item Number | Part Number | Description | Qty. |
|-------------|-------------|---|------|
| 1 | 145463 | Impeller/adaptor assembly pack (4) Impeller sizes (5) Discharge adapters (6) Volute thumb screws (1) Impeller spring (1) Impeller thumb screw (1) O-ring seal | 1 |
| 2 | 145459 | Stand | 1 |
| 3 | 145461 | Slinger plate | 1 |
| 4 | 921073 | Flat washer | 2 |
| 5 | 921072 | Locking washer | 2 |
| 6 | 920026 | Thumb nut (motor) | 2 |
| 7 | 145460 | Volute | 1 |

ENGINEERING DATA

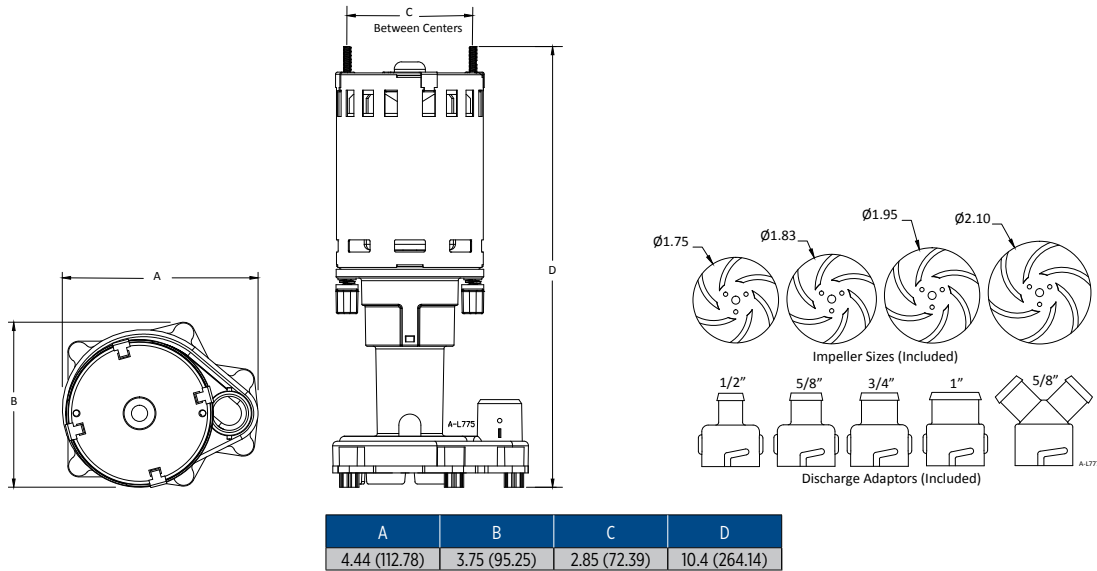

PERFORMANCE DATA

| Impeller Diameter | Discharge Adapter (I.D. Tubing Size) | Flow - Gallons/Liters per hour | |
|-------------------|--------------------------------------|--------------------------------|------|
| | | 2 Ft/.6m | |
| | | GPH | LPH |
| 1.75" / 44.5 mm | 1/2" / 12.7 mm | 290 | 1097 |
| | 5/8" / 15.8 mm | 435 | 1646 |
| | 3/4" / 19.1 mm | 540 | 2044 |
| | 1" / 24.5 mm | 585 | 2214 |
| 1.83" / 46.5 mm | 1/2" / 12.7 mm | 360 | 1362 |
| | 5/8" / 15.8 mm | 550 | 2081 |
| | 3/4" / 19.1 mm | 700 | 2649 |
| | 1" / 24.5 mm | 810 | 3066 |
| 1.95" / 49.5 mm | 1/2" / 12.7 mm | 385 | 1457 |
| | 5/8" / 15.8 mm | 600 | 2271 |
| | 3/4" / 19.1 mm | 760 | 2876 |
| | 1" / 24.5 mm | 825 | 3122 |
| 2.10" / 53.3 mm | 1/2" / 12.7 mm | 400 | 1514 |
| | 5/8" / 15.8 mm | 600 | 2271 |
| | 3/4" / 19.1 mm | 700 | 2649 |
| | 1" / 24.5 mm | 760 | 2876 |

CONSTRUCTION

| | |
|---------------------|----------------|
| Pump Housing | NSF-listed ABS |
| Volute | NSF-listed ABS |
| Impeller(s) | NSF-listed |

GKPK-SC SERIES

APPLICATIONS

- For effective cleaning, deliming and descaling of coils
(Coil cleaning chemicals not included)

FEATURES

- 5-gallon polyethylene tank
- Snap-on acrylic tank cover
- Tank baffle to reduce splash
- Includes 2-MD-SC magnetic drive pump with special volute for vertical installation
(Pump only includes cCSAus mark)
- Stainless pump bracket
- 1/2" O.D. intake and discharge
- 10' x 1/2' vinyl tubing
- Intermittent liquid temperature up to 150 °F
- Tubing clamps and adapters included
- Inlet filter screen
- 14.6' maximum head
- 6' power cord



SERIES SPECIFICATIONS

| Item No. | Model | HP | Input Voltage | Hz | Amps (FLA) | Watts (kW) | Discharge Size | Performance GPH (LPH) @ Head | | | | Shut-Off Ft. | PSI | Cord | Weight (lbs) |
|----------|---------|------|---------------|----|------------|------------|----------------|------------------------------|------------|------------|------------|--------------|-----|-----------|--------------|
| | | | | | | | | 1' | 3' | 6' | 9' | | | | |
| 562660 | GKPK-SC | 1/30 | 115 | 60 | 1.4 | 109 | 1/2" O.D. | 510 (1933) | 465 (1763) | 410 (1554) | 330 (1251) | 14.6 (4.5 m) | 6.3 | 6 (1.8 m) | 11 (5 Kg) |

GKPK-SC SERIES

REPLACEMENT PARTS & KITS

| Item | Part Number |
|-------------------|-------------|
| Pump | 580523 |
| Tank Cover | 162125 |
| Baffle | 162116 |
| Tubing 1/2" x 18" | 944222 |
| Tubing 1/2" x 10" | 944213 |

ENGINEERING DATA

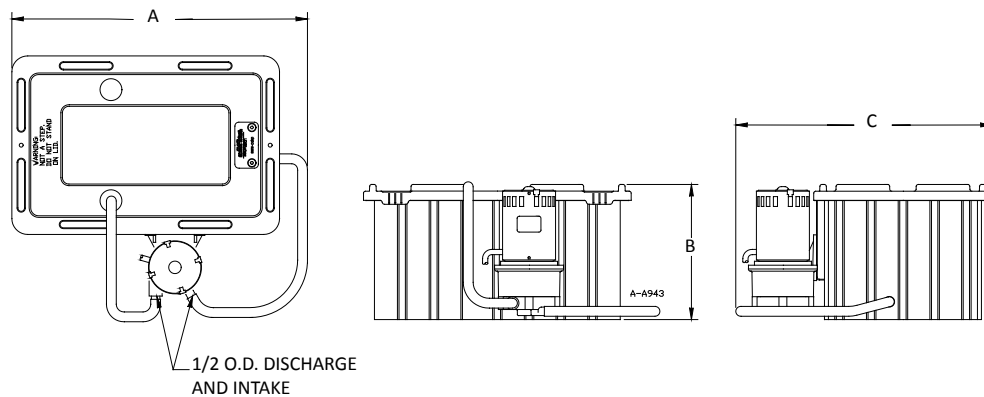

| A | B | C |
|---------------|--------------|---------------|
| 20.00 (50.90) | 8.60 (21.84) | 16.00 (40.64) |

PERFORMANCE DATA

115 V, 60 HZ

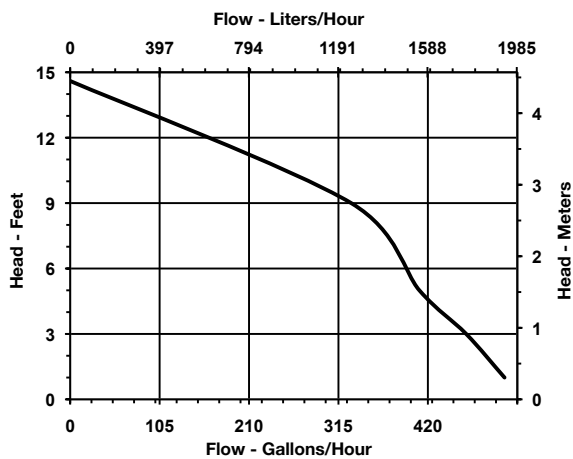

CONSTRUCTION

| | |
|---------------------------|------------------|
| Tank | Polyethylene |
| Tank Cover | Acrylic |
| Pump Head | GF Polypropylene |
| Pump Shaft/Thrust Washers | Ceramic |
| Inlet/Outlet Tubing | Vinyl |

ACS-2 & 3 IN-PAN CONDENSATE OVERFLOW DETECTION SWITCHES

APPLICATIONS

- The ACS-2 & 3 Condensate Overflow Switches install in air conditioner drain pan to shut off the unit if condensate level approaches overflow.

FEATURES

- Easy to install, inspect and maintain
- Compact design mounts to side of A/C condensate drain pans
- Can be installed to activate audible or visual alarm circuitry
- ABS housing and float
- Complies with applicable building codes
- Switches can be wired to operate as NO or NC
- Operation:
ACS-2 — 48 VAC/DC max, 5 amps max
ACS-3 — 125-250 VAC max, 11 amps max, up to 1/3 HP
- Lead wires:
ACS-2 — 18" and 72" leads
ACS-3 — 72" leads



SERIES SPECIFICATIONS

| Item No. | Model | HP | Input Voltage | Amps (FLA) | Lead length | Weight (lbs) |
|----------|-------|----------|---------------|------------|----------------|----------------|
| 599122 | ACS-2 | - | 48 V AC/DC | 5 max. | 18" (45.7 cm) | 0.21 (0.10 Kg) |
| 599123 | ACS-2 | - | 48 V AC/DC | 5 amx. | 72" (182.9 cm) | 0.29 (0.13 Kg) |
| 599124 | ACS-3 | 1/3 max. | 125-250 VAC | 11 max. | 72" (182.9 cm) | 0.29 (0.13 Kg) |

ACS-2 & 3 IN-PAN CONDENSATE OVERFLOW DETECTION SWITCHES

ENGINEERING DATA

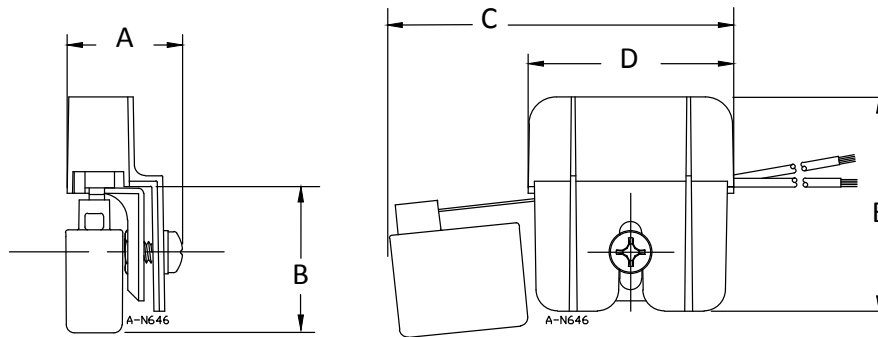

SIDE VIEW

BACK VIEW

| A | B | C | D | E |
|--------------|--------------|-------------|------------|------------|
| 1.34 (34.04) | 4.91 (101.6) | 2.4 (60.96) | 2.5 (63.5) | 2.5 (63.5) |

TYPICAL INSTALLATION

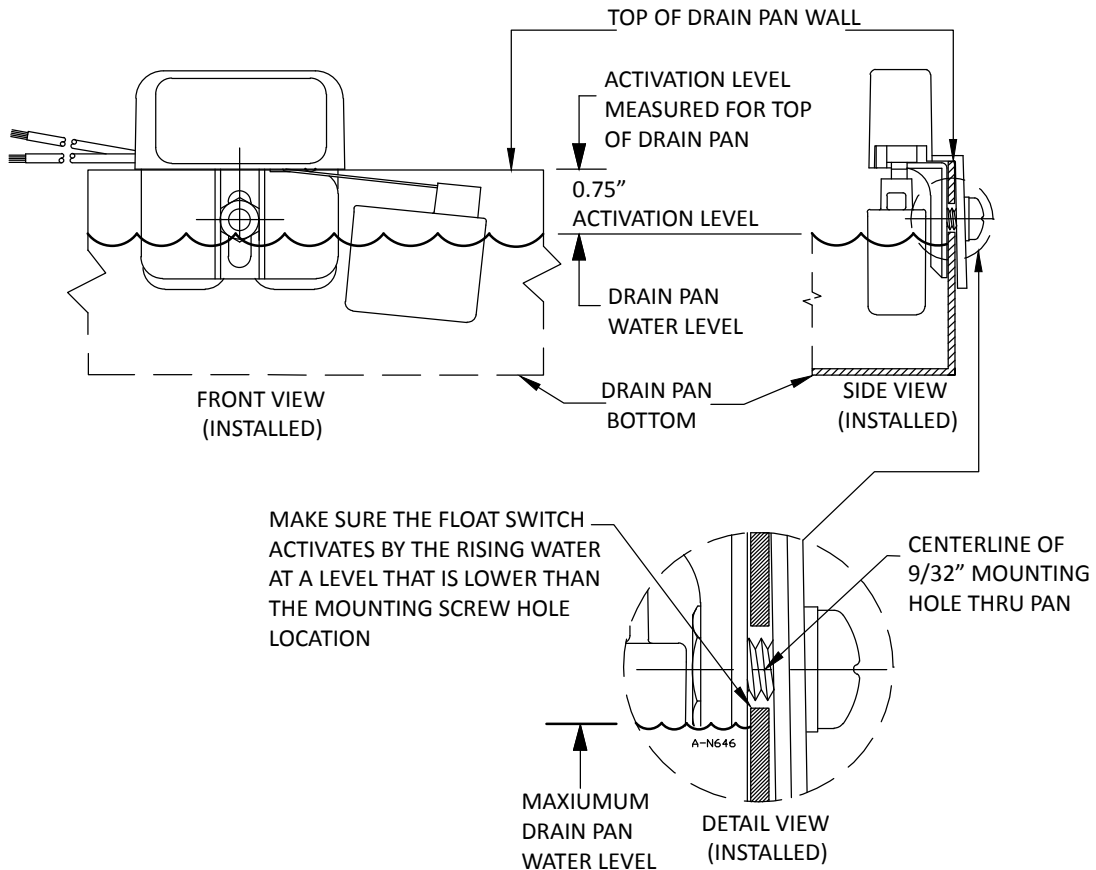

ACS-4 SERIES

APPLICATIONS

- ACS-4 in-line switch is designed to detect condensate drain line clogs or blockages and shut off equipment or alert users to the potential overflow condition. ACS-4 installs on 3/4" PVC condensate drain pipe in either a horizontal or vertical position. Using the included 3/4" PVC drain pan fitting, ACS-4 can also be installed directly at the drain pan primary or auxiliary outlet to detect pan overflow and shut off equipment or alert users to the potential overflow condition.

FEATURES

- Installs horizontally or vertically for confined spaces
- Reliable mechanical switch and polymer float
- Allows easy access to drain line for cleaning and inspection (by lifting off switch assembly)
- Can be installed in-line on A/C equipment condensate drain pipe, directly at the drain pan outlet or directly at the auxiliary (secondary) drain pan outlet
- Shuts off equipment when clog or blockage backs up condensate water in drain line
- Can simultaneously be connected to a warning light, audible alarm circuit or BMS/BAS system in addition to connection for equipment shut down
- Dual switch contacts allow NO and/or NC operation (additional lead wire required if both circuits used)
- Includes two 18 gauge, 6' (72") leads
- Includes schedule 40 PVC 3/4" 90° (tee) housing, 3/4" MNPT x 3/4" male slip adapter (to fit standard 3/4" equipment pan outlets), 3/4" PVC plug and 1" x 3/4" PVC bushing
- Suitable for 24 VAC Class 2 (thermostat) circuit
- 5 amp switching capacity
- Complies with applicable building codes



SERIES SPECIFICATIONS

| Item No. | Model | Input Voltage | Amps (FLA) |
|----------|-------|---------------|------------|
| 599125 | ACS-4 | 24 VAC | 5 max. |

ACS-4 SERIES

ENGINEERING DATA

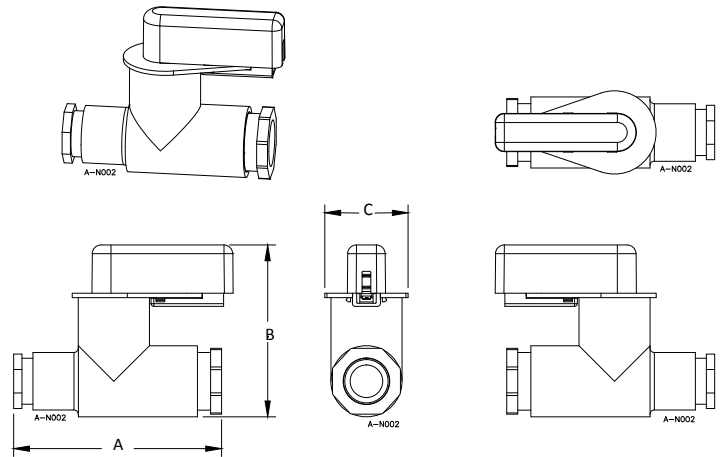
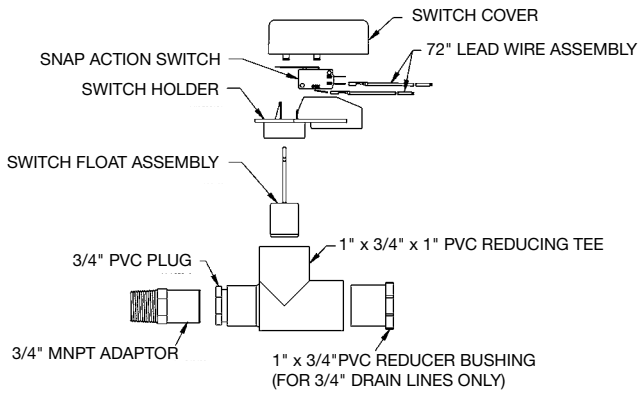

| A | B | C |
|--------------|-------------|-------------|
| 4.7 (119.38) | 3.9 (99.06) | 1.9 (48.26) |

TYPICAL INSTALLATION

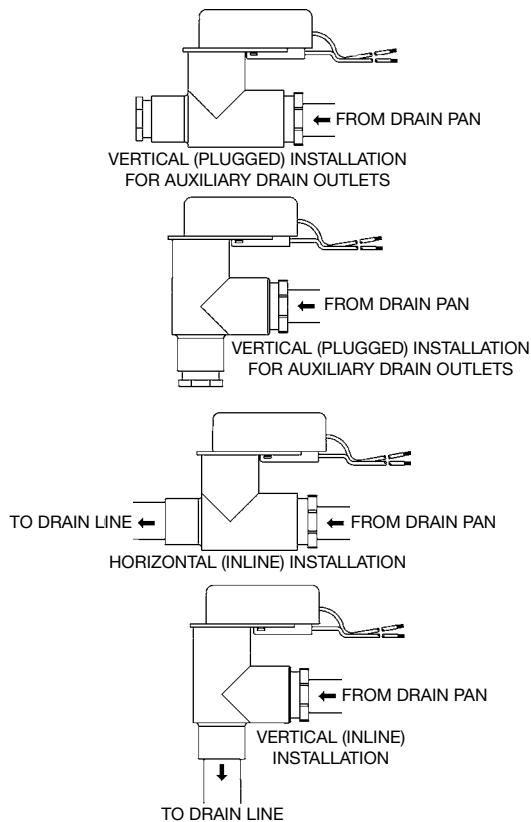

ACS-5 SERIES

APPLICATIONS

- Designed for use as a primary or secondary condensate drain pan overflow detection unit, it will shut off equipment or alert users to potential overflow condition. Easily installs directly at the auxiliary drain pan outlet using included 3/4" PVC drain pan fitting.

FEATURES

- Installs in confined spaces
- Reliable mechanical switch and solid, polymer float
- Can be installed on A/C equipment overflow drain outlet or primary/secondary auxiliary drain pan outlet
- Shuts off equipment when clog or blockage backs up condensate water in drain line
- Can simultaneously be connected to a warning light or audible alarm circuit or BMS/BAS system to send a signal in addition to shut off equipment
- Dual contacts allow NO and/or NC operation (additional lead wire required if both circuits used)
- Includes two 18 gauge, 6' leads
- Includes schedule 40 PVC 3/4" 90° housing and 3/4" MNPT x 3/4" male slip adapter to fit standard 3/4" equipment/pan outlets
- Suitable for 24 VAC Class 2 (thermostat) circuit
- 5 amp switching capacity
- Complies with applicable building codes



SERIES SPECIFICATIONS

| Item No. | Model | Input Voltage | Amps (FLA) |
|----------|-------|---------------|------------|
| 14940157 | ACS-5 | 24 VAC | 5 max. |

ACS-5 SERIES

ENGINEERING DATA

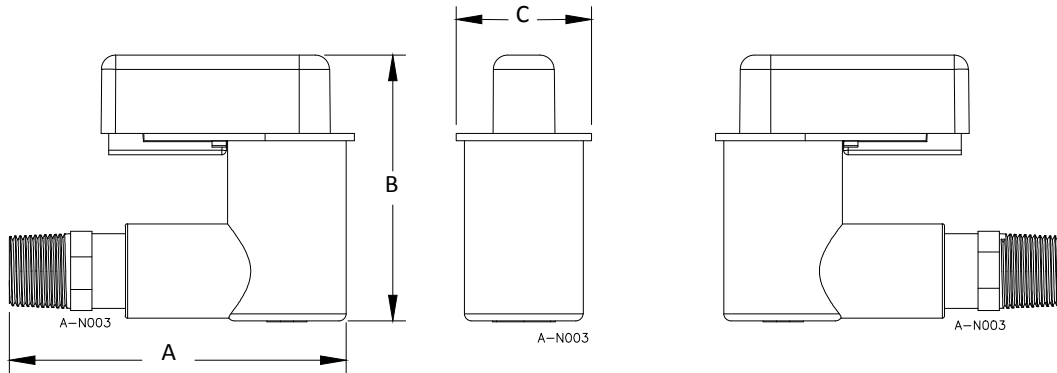
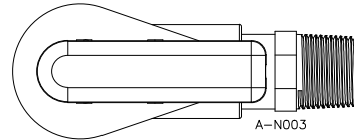
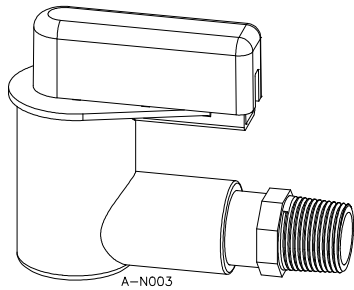

| A | B | C |
|--------------|-------------|-------------|
| 4.7 (119.38) | 3.7 (93.98) | 1.9 (48.26) |

ACCESSORIES

T-20/25

TUBING



| Item No. | Model |
|----------|---------|
| 599033 | T-20/25 |

- One carton of 25 pieces of 20' (6.01 m) length 3/8" (9.5 mm) ID VC tubing

T-3/8

TUBING



| Item No. | Model |
|----------|-------|
| 599107 | T-3/8 |

- 100' (640.1 m) of 3/8" (9.5 mm) ID x 1/2" (12.37 mm) OD clear tubing

PC-10-PRK

PUMP REPAIR KIT



| Item No. | Model |
|----------|-------|
| 599325 | PC-10 |

- Replacement roller and tube kit for TP Series and PC-10

T-RPC-10

TUBE



| Item No. | Model |
|----------|----------|
| 599270 | T-RPC-10 |

- Replacement tube assembly for TPS, TPT, and TPR pumps

ERC

EXTENSION CABLE



| Item No. | Model |
|----------|-------|
| 599170 | ERC |

- 3.3' (1 m) extension cable for TPT temperature sensor and TPR reservoir assembly

RESERVOIR ASSEMBLY



| Item No. | Model |
|----------|--------------------|
| 153781 | Reservoir Assembly |

- Replacement reservoir assembly for TPR pumps

CV-2

CHECK VALVE



| Item No. | Model |
|----------|-------|
| 599061 | CV-2 |

- For ABS Series pumps
- 1/4" FNPT (6.35 mm) to 1/4" (6.35 mm) OD tubing

CV-4

CHECK VALVE



| Item No. | Model |
|----------|-------|
| 599062 | CV-4 |

- For ABS Series pumps
- 1/2" FNPT (12.7 mm) to 1/2" (12.7 mm) OD tubing rigid plastic or copper tubing

CV-35

CHECK VALVE



| Item No. | Model |
|----------|-------|
| 599064 | CV-35 |

- For VCL-45ULS
- 3/8" (9.5 mm) rigid plastic or copper tubing on both ends

CV-10

CHECK VALVE



| Item No. | Model |
|----------|-------|
| 599065 | CV-10 |

- For VCC Series, VCMA Series and VCL-14/24 pumps
- 1/4" FNPT (6.35 mm) to 3/8" (9.5 mm) ID vinyl tubing

CV-X38

CHECK VALVE



| Item No. | Model |
|----------|--------|
| 599058 | CV-X38 |

- For Condensate Pump Series VCMX
- 3/8" (9.5 mm) OD rigid plastic or copper tubing

CV-14/24

CHECK VALVE



| Item No. | Model |
|----------|----------|
| 599069 | CV-14/24 |

- For VCC Series, VCMA Series and VCL-14/24 pumps
- 1/4" MNPT (6.35 mm) to 3/8" (9.5 mm) OD rigid plastic or copper tubing

ACCESSORIES

CV-15/20

CHECK VALVE

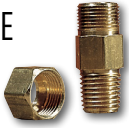

| Item No. | Model |
|----------|---------|
| 599033 | T-20/25 |

- Brass check valve for VCMA-15/20
- 1/4" MNPT (6.35 mm) to 3/8" (9.5 mm) OD rigid plastic or copper tubing

ACS-X10

OVERFLOW DETECTION SWITCH



| Item No. | Model |
|----------|---------|
| 599136 | ACS-X10 |

- For use with VCMX

ACS-X72

OVERFLOW DETECTION SWITCH



| Item No. | Model |
|----------|---------|
| 599137 | ACS-X72 |

- For use with VCMX

VCMX-CK

ANTI-SWEAT SLEEVE



| Item No. | Model |
|----------|---------|
| 599138 | VCMX-CK |

- For use with VCMX

ELBOW



| Item No. | Model |
|----------|-------|
| 140341 | Elbow |

- For use with CP Series
- 90° Elbow with bleed off

ADDITIONAL CHECK VALVES

CHECK VALVE



| Item No. |
|----------|
| 154708 |

- For VCMA, VCM and VCC Series pumps
- 3/8" NPT x 1/4" OD

CHECK VALVE



| Item No. |
|----------|
| 154725 |

- For use with VCMX
- 1/4" OD

