

MSI Malleable Iron Pipe Fitting Specifications

800-678-2544 phone 800-678-0857 fax www.msi-products.com msisales@msi-products.com

THREADS: ANSI / ASME B1.20.1 DIMENSIONS: ANSI B16.3 MATERIAL: ASTM A197

90° Elbows

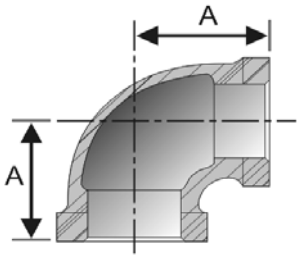

Size	Inner Carton	Master Case	"A" Inch	Black Item Number	Galv. Item Number	Approx. Wgt. Ea / lbs.
1/8"	50	600	0.71	A2010002	A2210002	0.065
1/4"	35	420	0.83	A2010004	A2210004	0.115
3/8"	45	540	0.98	A2010006	A2210006	0.175
1/2"	50	400	1.10	A2010008	A2210008	0.255
3/4"	35	210	1.30	A2010012	A2210012	0.390
1"	20	120	1.50	A2010016	A2210016	0.651
1 1/4"	20	80	1.77	A2010020	A2210020	1.031
1 1/2"	10	60	1.97	A2010024	A2210024	1.342
2"	8	32	2.28	A2010032	A2210032	2.112
2 1/2"	6	18	2.71	A2010040	A2210040	3.841
3"	7	14	3.07	A2010048	A2210048	5.365
4"	2	6	3.78	A2010064	A2210064	9.989

45° Elbows

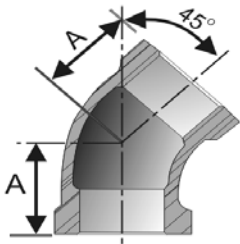

Size	Inner Carton	Master Case	"A" Inch	Black Item Number	Galv. Item Number	Approx. Wgt. Ea / lbs.
1/8"	50	600	0.63	A2010402	A2210402	0.075
1/4"	30	360	0.75	A2010404	A2210404	0.115
3/8"	50	600	0.39	A2010406	A2210406	0.155
1/2"	50	400	0.59	A2010408	A2210408	0.225
3/4"	40	240	0.98	A2010412	A2210412	0.351
1"	20	120	1.10	A2010416	A2210416	0.582
1 1/4"	20	80	1.30	A2010420	A2210420	0.865
1 1/2"	10	60	1.42	A2010424	A2210424	1.155
2"	12	36	1.69	A2010432	A2210432	1.795
2 1/2"	9	27	1.97	A2010440	A2210440	3.021
3"	10	20	2.16	A2010448	A2210448	4.692
4"	2	6	2.59	A2010464	A2210464	8.255

90° Street Elbows

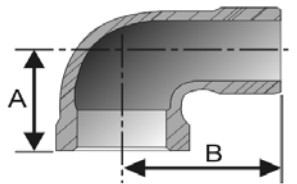

Size	Inner Carton	Master Case	"A" Inch	"B" Inch	Black Item Number	Galv. Item Number	Approx. Wgt. Ea / lbs.
1/8"	60	720	0.71	0.98	A2010602	A2210602	0.065
1/4"	35	420	0.83	1.14	A2010604	A2210604	0.105
3/8"	40	480	0.98	1.46	A2010606	A2210606	0.175
1/2"	60	360	1.10	1.61	A2010608	A2210608	0.255
3/4"	35	210	1.30	1.89	A2010612	A2210612	0.415
1"	30	120	1.50	2.08	A2010616	A2210616	0.665
1 1/4"	25	75	1.77	2.40	A2010620	A2210620	1.102
1 1/2"	9	54	1.97	2.63	A2010624	A2210624	1.495
2"	10	30	2.28	3.26	A2010632	A2210632	3.452
2 1/2"	9	18	2.71	3.85	A2010640	A2210640	4.135
3"	7	14	3.07	4.52	A2010648	A2210648	6.615
4"	2	6	3.78	5.70	A2010664	A2210664	11.551

MSI Malleable Iron Pipe Fitting Specifications

800-678-2544 phone 800-678-0857 fax www.msi-products.com msisales@msi-products.com

THREADS: ANSI / ASME B1.20.1 DIMENSIONS: ANSI B16.3 MATERIAL: ASTM A197

45° Street Elbows

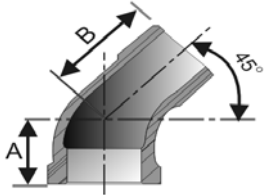

Size	Inner Carton	Master Case	"A" Inch	"B" Inch	Black Item Number	Galv. Item Number	Approx. Wgt. Ea / lbs.
1/8"	70	840	0.63	0.83	A2010802	A2210802	0.065
1/4"	40	480	0.75	0.94	A2010804	A2210804	0.105
3/8"	50	600	0.79	1.02	A2010806	A2210806	0.175
1/2"	75	450	0.87	1.10	A2010808	A2210808	0.255
3/4"	40	240	0.98	1.30	A2010812	A2210812	0.415
1"	25	150	1.10	1.46	A2010816	A2210816	0.665
1 1/4"	10	80	1.30	1.69	A2010820	A2210820	1.102
1 1/2"	10	60	1.42	1.89	A2010824	A2210824	1.495
2"	12	36	1.69	2.20	A2010832	A2210832	3.452
2 1/2"	12	24	1.97	2.56	A2010840	A2210840	4.135
3"	6	18	2.16	2.99	A2010848	A2210848	6.615
4"	1	3	2.59	3.70	A2010864	A2210864	11.551

Tees

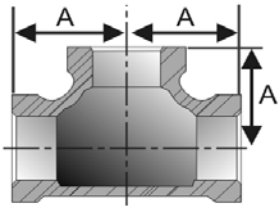

Size	Inner Carton	Master Case	"A" Inch	Black Item Number	Galv. Item Number	Approx. Wgt. Ea / lbs.
1/8"	80	960	0.71	A2020002	A2220002	0.095
1/4"	50	600	0.83	A2020004	A2220004	0.155
3/8"	30	360	0.98	A2020006	A2220006	0.255
1/2"	40	240	1.10	A2020008	A2220008	0.352
3/4"	35	140	1.30	A2020012	A2220012	0.555
1"	20	80	1.50	A2020016	A2220016	0.925
1 1/4"	14	56	1.77	A2020020	A2220020	1.385
1 1/2"	15	45	1.97	A2020024	A2220024	1.835
2"	10	30	2.28	A2020032	A2220032	2.752
2 1/2"	8	16	2.71	A2020040	A2220040	4.995
3"	6	12	3.07	A2020048	A2220048	7.652
4"	2	6	3.78	A2020064	A2220064	14.025

Side Outlet Elbows

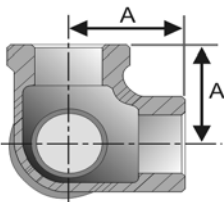

Size	Inner Carton	Master Case	"A" Inch	Black Item Number	Galv. Item Number	Approx. Wgt. Ea / lbs.
1/4"	50	600	0.83	A2010904	A2210904	0.135
3/8"	50	400	0.98	A2010906	A2210906	0.205
1/2"	45	270	1.10	A2010908	A2210908	0.305
3/4"	20	160	1.30	A2010912	A2210912	0.505
1"	20	80	1.50	A2010916	A2210916	0.755
1 1/4"	15	45	1.77	A2010920	A2210920	1.112
1 1/2"	12	36	1.97	A2010924	A2210924	1.495
2"	12	24	2.28	A2010932	A2210932	2.351

MSI Malleable Iron Pipe Fittings Meet the following Specifications: ASME B16.3; ASTM A197; ASME B1.20.1

MSI Malleable Iron Pipe Fitting Specifications

800-678-2544 phone 800-678-0857 fax www.msi-products.com msisales@msi-products.com

THREADS: ANSI / ASME B1.20.1 DIMENSIONS: ANSI B16.3 MATERIAL: ASTM A197

Street / Service Tee

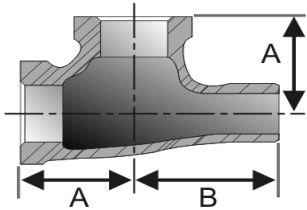

Size	Inner Carton	Master Case	"A" Inch	"B" Inch	Black Item Number	Galv. Item Number	Approx. Wgt. Ea / lbs.
3/8"	40	240	0.94	1.46	A2020406	A2220406	0.255
1/2"	40	240	1.10	1.61	A2020408	A2220408	0.335
3/4"	25	150	1.30	1.89	A2020412	A2220412	0.555
1"	20	80	1.50	2.12	A2020416	A2220416	0.965
1 1/4"	15	60	1.73	2.44	A2020420	A2220420	1.475
1 1/2"	12	36	1.93	2.67	A2020424	A2220424	1.965
2"	8	24	2.24	3.26	A2020432	A2220432	3.335

Crosses

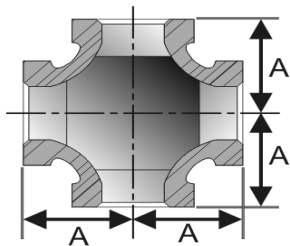

Size	Inner Carton	Master Case	"A" Inch	Black Item Number	Galv. Item Number	Approx. Wgt. Ea / lbs.
1/8"	30	360	0.71	A2030202	A2230202	0.125
1/4"	40	480	0.83	A2030204	A2230204	0.195
3/8"	25	300	0.98	A2030206	A2230206	0.295
1/2"	30	180	1.10	A2030208	A2230208	0.425
3/4"	20	120	1.30	A2030212	A2230212	0.675
1"	15	60	1.50	A2030216	A2230216	1.035
1 1/4"	20	40	1.77	A2030220	A2230220	1.555
1 1/2"	18	36	1.97	A2030224	A2230224	2.075
2"	10	20	2.28	A2030232	A2230232	3.115
2 1/2"	3	12	2.71	A2030240	A2230240	5.655
3"	2	8	3.07	A2030248	A2230248	8.355
4"	2	4	3.78	A2030264	A2230264	13.755

Unions

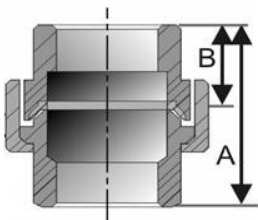

Size	Inner Carton	Master Case	"A" Inch	"B" Inch	Black Item Number	Galv. Item Number	Approx. Wgt. Ea / lbs.
1/8"	30	360	1.26	0.63	A2040802	A2240802	0.194
1/4"	20	240	1.44	0.72	A2040804	A2240804	0.205
3/8"	20	240	1.61	0.81	A2040806	A2240806	0.351
1/2"	50	200	1.72	0.86	A2040808	A2240808	0.432
3/4"	35	140	1.95	0.98	A2040812	A2240812	0.628
1"	20	80	2.06	1.03	A2040816	A2240816	0.912
1 1/4"	15	60	2.26	1.13	A2040820	A2240820	1.354
1 1/2"	10	40	2.40	1.20	A2040824	A2240824	1.755
2"	6	24	2.75	1.38	A2040832	A2240832	2.625
2 1/2"	8	16	3.23	1.61	A2040840	A2240840	4.412
3"	7	14	3.50	1.75	A2040848	A2240848	5.645
4"	1	7	3.86	1.93	A2040864	A2240864	10.345

MSI Malleable Iron Pipe Fitting Specifications

800-678-2544 phone 800-678-0857 fax www.msi-products.com msisales@msi-products.com

THREADS: ANSI / ASME B1.20.1 DIMENSIONS: ANSI B16.3 MATERIAL: ASTM A197

Couplings / Banded

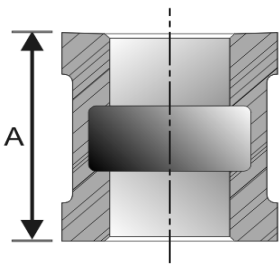

Size	Inner Carton	Master Case	"A" Inch	Black Item Number	Galv. Item Number	Approx. Wgt. Ea / lbs.
1/8"	70	840	0.98	A2030402	A2230402	0.055
1/4"	40	480	1.06	A2030404	A2230404	0.085
3/8"	50	600	1.18	A2030406	A2230406	0.125
1/2"	40	480	1.42	A2030408	A2230408	0.185
3/4"	50	300	1.54	A2030412	A2230412	0.285
1"	25	150	1.77	A2030416	A2230416	0.455
1 1/4"	16	128	1.97	A2030420	A2230420	0.675
1 1/2"	18	72	2.16	A2030424	A2230424	0.925
2"	12	48	2.55	A2030432	A2230432	1.475
2 1/2"	8	32	2.91	A2030440	A2230440	1.525
3"	12	24	3.15	A2030448	A2230448	3.695
4"	6	12	3.70	A2030464	A2230464	6.025

Caps

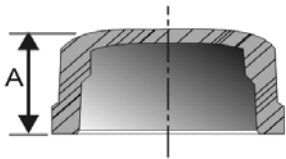

Size	Inner Carton	Master Case	"A" Inch	Black Item Number	Galv. Item Number	Approx. Wgt. Ea / lbs.
1/8"	120	1440	0.55	A2040502	A2240502	0.055
1/4"	80	960	0.63	A2040504	A2240504	0.085
3/8"	60	720	0.75	A2040506	A2240506	0.105
1/2"	75	900	0.91	A2040508	A2240508	0.145
3/4"	40	480	0.98	A2040512	A2240512	0.225
1"	35	280	1.18	A2040516	A2240516	0.345
1 1/4"	25	200	1.30	A2040520	A2240520	0.555
1 1/2"	25	150	1.34	A2040524	A2240524	0.695
2"	18	108	1.46	A2040532	A2240532	0.975
2 1/2"	28	56	1.73	A2040540	A2240540	1.765
3"	21	42	1.81	A2040548	A2240548	2.625
4"	7	21	2.08	A2040564	A2240564	4.335

Locknuts

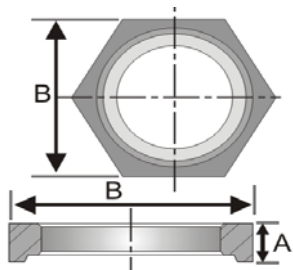

Size	Inner Carton	Master Case	"A" Inch	"B" Inch	Black Item Number	Galv. Item Number	Approx. Wgt. Ea / lbs.
1/8"	250	3000	0.19	0.71	A2040602	A2240602	0.024
1/4"	125	1500	0.26	0.84	A2040604	A2240604	0.040
3/8"	125	1500	0.28	1.00	A2040606	A2240606	0.045
1/2"	100	1200	0.31	1.18	A2040608	A2240608	0.065
3/4"	60	720	0.35	1.43	A2040612	A2240612	0.125
1"	40	480	0.39	1.75	A2040616	A2240616	0.175
1 1/4"	30	360	0.43	2.10	A2040620	A2240620	0.285
1 1/2"	45	270	0.47	2.12	A2040624	A2240624	0.265
2"	25	150	0.53	2.88	A2040632	A2240632	0.562
2 1/2"	20	80	0.59	3.50	A2040640	A2240640	1.135
3"	20	60	0.67	4.27	A2040648	A2240648	1.342
4"	7	28	0.80	5.39	A2040664	A2240664	2.572

MSI Malleable Iron Pipe Fitting Specifications

800-678-2544 phone 800-678-0857 fax www.msi-products.com msisales@msi-products.com

THREADS: ANSI / ASME B1.20.1 DIMENSIONS: ANSI B16.3 MATERIAL: ASTM A197

Hex Bushings

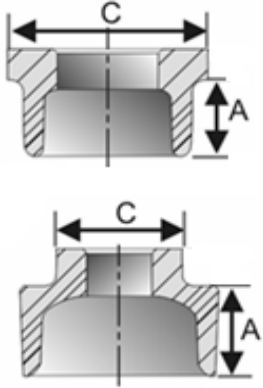

Size	Inner Carton	Master Case	"A" Inch	"C" Inch	Black Item Number	Galv. Item Number	Approx. Wgt. Ea / lbs.
1/4" x 1/8"	100	600	0.44	0.78	A204000402	A224000402	0.024
3/8" x 1/8"	100	600	0.48	0.78	A204000602	A224000602	0.037
3/8" x 1/4"	100	600	0.48	0.78	A204000604	A224000604	0.042
1/2" x 1/8"	100	600	0.56	0.95	A204000802	A224000802	0.095
1/2" x 1/4"	100	600	0.56	0.95	A204000804	A224000804	0.075
1/2" x 3/8"	100	600	0.56	0.95	A204000806	A224000806	0.066
3/4" x 1/8"	50	600	0.63	1.02	A204001202	A224001202	0.165
3/4" x 1/4"	50	600	0.63	1.02	A204001204	A224001204	0.161
3/4" x 3/8"	50	600	0.63	1.02	A204001206	A224001206	0.143
3/4" x 1/2"	50	600	0.63	1.02	A204001208	A224001208	0.099
1" x 1/4"	50	400	0.75	1.14	A204001604	A224001604	0.190
1" x 3/8"	50	400	0.75	1.14	A204001606	A224001606	0.238
1" x 1/2"	50	400	0.75	1.14	A204001608	A224001608	0.207
1" x 3/4"	50	400	0.75	1.14	A204001612	A224001612	0.172
1 1/4" x 1/4"	30	240	0.80	1.22	A204002004	A224002004	0.306
1 1/4" x 3/8"	30	240	0.80	1.22	A204002006	A224002006	0.432
1 1/4" x 1/2"	30	240	0.80	1.22	A204002008	A224002008	0.291
1 1/4" x 3/4"	30	240	0.80	1.22	A204002012	A224002012	0.355
1 1/4" x 1"	30	240	0.80	1.22	A204002016	A224002016	0.293
1 1/2" x 1/4"	25	150	0.83	1.22	A204002404	A224002404	0.646
1 1/2" x 3/8"	25	150	0.83	1.22	A204002406	A224002406	0.639
1 1/2" x 1/2"	25	150	0.83	1.22	A204002408	A224002408	0.397
1 1/2" x 3/4"	25	150	0.83	1.22	A204002412	A224002412	0.386
1 1/2" x 1"	25	150	0.83	1.22	A204002416	A224002416	0.463
1 1/2" x 1 1/4"	25	150	0.83	1.22	A204002420	A224002420	0.322
2" x 3/8"	20	120	0.88	1.38	A204003206	A224003206	0.948
2" x 1/2"	20	120	0.88	1.38	A204003208	A224003208	0.838
2" x 3/4"	20	120	0.88	1.38	A204003212	A224003212	0.631
2" x 1"	20	120	0.88	1.38	A204003216	A224003216	0.670
2" x 1 1/4"	20	120	0.88	1.38	A204003220	A224003220	0.732
2" x 1 1/2"	20	120	0.88	1.38	A204003224	A224003224	0.703
2 1/2" x 1/2"	15	60	1.07	1.57	A204004008	A224004008	1.572
2 1/2" x 3/4"	15	60	1.07	1.57	A204004012	A224004012	1.543
2 1/2" x 1"	15	60	1.07	1.57	A204004016	A224004016	1.515
2 1/2" x 1 1/4"	15	60	1.07	1.57	A204004020	A224004020	1.415
2 1/2" x 1 1/2"	15	60	1.07	1.57	A204004024	A224004024	1.376
2 1/2" x 2"	15	60	1.07	1.57	A204004032	A224004032	1.109
3" x 1"	12	48	1.14	1.73	A204004816	A224004816	1.466
3" x 1 1/4"	12	48	1.14	1.73	A204004820	A224004820	2.227
3" x 1 1/2"	12	48	1.14	1.73	A204004824	A224004824	1.923

MSI Malleable Iron Pipe Fitting Specifications

800-678-2544 phone 800-678-0857 fax www.msi-products.com msisales@msi-products.com

THREADS: ANSI / ASME B1.20.1 DIMENSIONS: ANSI B16.3 MATERIAL: ASTM A197

Hex Bushings

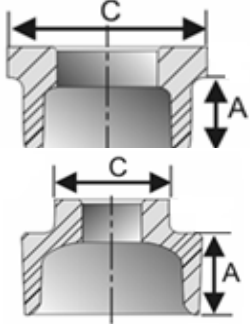

Size	Inner Carton	Master Case	"A" Inch	"C" Inch	Black Item Number	Galv. Item Number	Approx. Wgt. Ea / lbs.
3" x 2"	12	48	1.14	1.73	A204004832	A224004832	1.922
3" x 2 1/2"	12	48	1.14	1.73	A204004840	A224004840	1.504
4" x 3/4"	5	20	1.22	2.00	A204006412	A224006412	3.309
4" x 1"	5	20	1.22	2.00	A204006416	A224006416	2.588
4" x 1 1/4"	5	20	1.22	2.00	A204006420	A224006420	3.624
4" x 1 1/2"	5	20	1.22	2.00	A204006424	A224006424	3.915
4" x 2"	5	20	1.22	2.00	A204006432	A224006432	2.897
4" x 2 1/2"	5	20	1.22	2.00	A204006440	A224006440	2.773
4" x 3"	5	20	1.22	2.00	A204006448	A224006448	3.034

Square Head Plugs

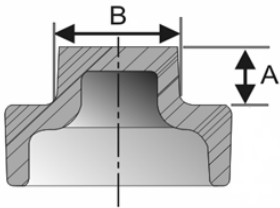

Size	Inner Carton	Master Case	"A" Inch	"B" Inch	Black Item Number	Galv. Item Number	Approx. Wgt. Ea / lbs.
1/8"	300	3600	0.24	0.28	A2050102	A2250102	0.015
1/4"	150	1800	0.28	0.37	A2050104	A2250104	0.029
3/8"	100	1200	0.31	0.43	A2050006	A2250006	0.051
1/2"	50	600	0.38	0.56	A2050008	A2250008	0.086
3/4"	30	360	0.44	0.63	A2050012	A2250012	0.132
1"	20	240	0.50	0.81	A2050016	A2250016	0.220
1 1/4"	40	240	0.56	0.93	A2050020	A2250020	0.399
1 1/2"	30	180	0.62	1.13	A2050024	A2250024	0.461
2"	20	120	0.68	1.31	A2050032	A2250032	0.741
2 1/2"	16	64	0.74	1.50	A2050040	A2250040	1.246
3"	16	48	0.80	1.69	A2050048	A2250048	1.693
4"	8	16	1.00	2.32	A2050064	A2250064	2.705

Extension Pieces

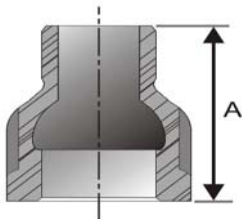

Size	Inner Carton	Master Case	"A" Inch	"B" Inch	Black Item Number	Galv. Item Number	Approx. Wgt. Ea / lbs.
1/2"	50	600	1.38	0.98	A2040408	A2240408	0.159
3/4"	40	320	1.69	1.18	A2040412	A2240412	0.280
1"	30	180	2.16	1.50	A2040416	A2240416	0.441
1 1/4"	30	120	2.36	1.61	A2040420	A2240420	0.661
1 1/2"	20	80	2.48	1.73	A2040424	A2240424	0.875
2"	15	60	2.75	1.81	A2040432	A2240432	1.323



MSI Malleable Iron Pipe Fitting Specifications

800-678-2544 phone 800-678-0857 fax www.msi-products.com msisales@msi-products.com

THREADS: ANSI / ASME B1.20.1 DIMENSIONS: ANSI B16.3 MATERIAL: ASTM A197

Reducer Coupling

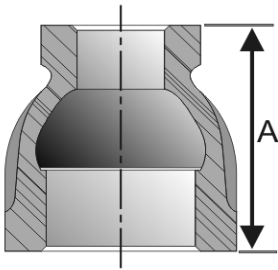

Size	Inner Carton	Master Case	"A" Inch	Black Item Number	Galv. Item Number	Approx. Wgt. Ea / lbs.
1/4" x 1/8"	50	600	1.02	A203080402	A223080402	0.0772
3/8" x 1/8"	35	420	1.14	A203080602	A223080602	0.1014
3/8" x 1/4"	30	360	1.14	A203080604	A223080604	0.1168
1/2" x 1/8"	50	600	1.34	A203080802	A223080802	0.1662
1/2" x 1/4"	50	600	1.34	A203080804	A223080804	0.1543
1/2" x 3/8"	40	480	1.34	A203080806	A223080806	0.1631
3/4" x 1/4"	30	360	1.50	A203081204	A223081204	0.2116
3/4" x 3/8"	30	360	1.50	A203081206	A223081206	0.2227
3/4" x 1/2"	60	360	1.50	A203081208	A223081208	0.2866
1" x 1/4"	45	270	1.73	A203081604	A223081604	0.3704
1" x 3/8"	30	240	1.73	A203081606	A223081606	0.3483
1" x 1/2"	30	240	1.73	A203081608	A223081608	0.3682
1" x 3/4"	25	200	1.73	A203081612	A223081612	0.4057
1 1/4" x 1/2"	25	150	2.00	A203082008	A223082008	0.5556
1 1/4" x 3/4"	25	150	2.00	A203082012	A223082012	0.6041
1 1/4" x 1"	15	120	2.00	A203082016	A223082016	0.6592
1 1/2" x 3/8"	30	120	2.24	A203082406	A223082406	0.5886
1 1/2" x 1/2"	20	120	2.24	A203082408	A223082408	0.7716
1 1/2" x 3/4"	15	120	2.24	A203082412	A223082412	0.7893
1 1/2" x 1"	25	100	2.24	A203082416	A223082416	0.8444
1 1/2" x 1 1/4"	12	96	2.24	A203082420	A223082420	0.8642
2" x 3/8"	15	90	2.79	A203083206	A223083206	0.9700
2" x 1/2"	14	84	2.79	A203083208	A223083208	1.1222
2" x 3/4"	14	84	2.79	A203083212	A223083212	1.1133
2" x 1"	14	84	2.79	A203083216	A223083216	1.2809
2" x 1 1/4"	12	72	2.79	A203083220	A223083220	1.3051
2" x 1 1/2"	12	72	2.79	A203083224	A223083224	1.4065
2 1/2" x 1/2"	20	40	3.26	A203084008	A223084008	1.7152
2 1/2" x 3/4"	20	40	3.26	A203084012	A223084012	1.6006
2 1/2" x 1"	20	40	3.26	A203084016	A223084016	1.8387
2 1/2" x 1 1/4"	20	40	3.26	A203084020	A223084020	1.8254
2 1/2" x 1 1/2"	20	40	3.26	A203084024	A223084024	1.7417
2 1/2" x 2"	20	40	3.26	A203084032	A223084032	1.7924
3" x 3/4"	16	48	3.70	A203084812	A223084812	2.2046
3" x 1"	16	32	3.70	A203084816	A223084816	2.0600
3" x 1 1/4"	16	32	3.70	A203084820	A223084820	2.0084
3" x 1 1/2"	16	32	3.70	A203084824	A223084824	2.1848
3" x 2"	16	32	3.70	A203084832	A223084832	2.2664
3" x 2 1/2"	12	24	3.70	A203084840	A223084840	3.5142
4" x 1"	6	18	4.37	A203086416	A223086416	3.9705
4" x 1 1/4"	6	18	4.37	A203086420	A223086420	3.6619
4" x 1 1/2"	6	18	4.37	A203086424	A223086424	3.8405
4" x 2"	4	12	4.37	A203086432	A223086432	4.9692
4" x 2 1/2"	6	18	4.37	A203086440	A223086440	4.0168
4" x 3"	4	12	4.37	A203086448	A223086448	4.0764

MSI Malleable Iron Pipe Fittings Meet the following Specifications: ASME B16.3; ASTM A197; ASME B1.20.1



MSI Malleable Iron Pipe Fitting Specifications

800-678-2544 phone 800-678-0857 fax www.msi-products.com msisales@msi-products.com

THREADS: ANSI / ASME B1.20.1 DIMENSIONS: ANSI B16.3 MATERIAL: ASTM A197

Reducing Elbows

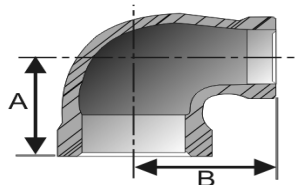

Size	Inner Carton	Master Case	"A" Inch	"B" Inch	Black Item Number	Galv. Item Number	Approx. Wgt. Ea / lbs.
1/4" x 1/8"	40	480	0.75	0.75	A201020402	A221020402	0.097
3/8" x 1/8"	70	840	0.83	0.87	A201020602	A221020602	0.128
3/8" x 1/4"	60	720	0.87	0.91	A201020604	A221020604	0.141
1/2" x 1/4"	40	480	0.98	0.98	A201020804	A221020804	0.176
1/2" x 3/8"	50	400	1.02	1.02	A201020806	A221020806	0.214
3/4" x 1/4"	40	320	1.06	1.06	A201021204	A221021204	0.245
3/4" x 3/8"	25	300	1.10	1.10	A201021206	A221021206	0.276
3/4" x 1/2"	30	240	1.18	1.22	A201021208	A221021208	0.317
1" x 3/8"	40	240	1.18	1.26	A201021606	A221021606	0.390
1" x 1/2"	30	180	1.26	1.34	A201021608	A221021608	0.445
1" x 3/4"	25	150	1.38	1.42	A201021612	A221021612	0.520
1 1/4" x 1/2"	35	140	1.34	1.54	A201022008	A221022008	0.637
1 1/4" x 3/4"	15	120	1.42	1.61	A201022012	A221022012	0.703
1 1/4" x 1"	10	80	1.57	1.65	A201022016	A221022016	0.809
1 1/2" x 1/2"	25	100	1.38	1.65	A201022408	A221022408	0.926
1 1/2" x 3/4"	15	90	1.54	1.77	A201022412	A221022412	0.739
1 1/2" x 1"	10	80	1.65	1.81	A201022416	A221022416	0.661
1 1/2" x 1 1/4"	15	60	1.81	1.89	A201022420	A221022420	1.268
2" x 1/2"	15	60	1.50	1.89	A201023208	A221023208	0.996
2" x 3/4"	10	60	1.61	1.97	A201023212	A221023212	1.213
2" x 1"	14	56	1.73	1.97	A201023216	A221023216	1.226
2" x 1 1/4"	10	40	1.89	2.08	A201023220	A221023220	1.431
2" x 1-1/2"	10	40	2.04	2.16	A201023224	A221023224	1.367
2-1/2" x 3/4"	10	40	1.73	2.32	A201024012	A221024012	1.742
2-1/2" x 1"	8	32	1.89	2.40	A201024016	A221024016	2.183
2-1/2" x 1 1/4"	8	24	2.09	2.48	A201024020	A221024020	2.123
2-1/2" x 1 1/2"	8	24	2.16	2.48	A201024024	A221024024	2.205
2-1/2" x 2"	8	24	2.40	2.60	A201024032	A221024032	2.701
3" x 1"	8	24	2.16	2.64	A201024816	A221024816	2.725
3" x 1 1/4"	5	24	2.16	2.71	A201024820	A221024820	2.943
3" x 1 1/2"	5	20	2.28	2.79	A201024824	A221024824	3.031
3" x 2"	6	18	2.52	2.87	A201024832	A221024832	3.086
3" x 2 1/2"	8	16	2.83	2.99	A201024840	A221024840	3.880
4" x 1 1/2"	1	12	2.48	3.38	A201026424	A221026424	5.582
4" x 2"	1	12	2.76	3.42	A201026432	A221026432	5.690

MSI Malleable Iron Pipe Fittings Meet the following Specifications: ASME B16.3; ASTM A197; ASME B1.20.1



MSI Malleable Iron Pipe Fitting Specifications

800-678-2544 phone 800-678-0857 fax www.msi-products.com msisales@msi-products.com

THREADS: ANSI / ASME B1.20.1 DIMENSIONS: ANSI B16.3 MATERIAL: ASTM A197

Reducing Tees

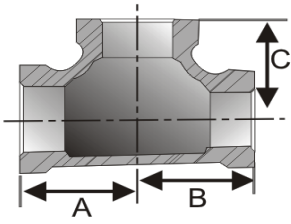

Size	Inner Carton	Master Case	"A" Inch	"B / C" Inch	Black Item Number	Galv. Item Number	Approx. Wgt. Ea / lbs.
1/4" x 1/4" x 1/8"	25	300	0.74	0.74 / 0.74	A20202040402	A22202040402	0.132
3/8" x 3/8" x 1/8"	60	480	0.83	0.83 / 0.87	A20202060602	A22202060602	0.161
3/8" x 3/8" x 1/4"	40	480	0.91	0.91 / 0.91	A20202060604	A22202060604	0.181
1/2" x 1/2" x 1/4"	25	300	0.94	0.94 / 0.94	A20202080804	A22202080804	0.256
1/2" x 1/2" x 3/8"	45	270	1.02	1.02 / 1.02	A20202080806	A22202080806	0.287
1/2" x 1/2" x 3/4"	30	180	1.22	1.22 / 1.18	A20202080812	A22202080812	0.430
1/2" x 1/2" x 1"	40	160	1.34	1.34 / 1.26	A20202080816	A22202080816	0.485
3/4" x 1/2" x 1/2"	30	180	1.18	1.10 / 1.22	A20202120808	A22202120808	0.428
3/4" x 1/2" x 3/4"	40	160	1.22	1.30 / 1.22	A20202120812	A22202120812	0.507
3/4" x 3/4" x 1/4"	25	200	1.02	1.02 / 1.06	A20202121204	A22202121204	0.353
3/4" x 3/4" x 3/8"	30	180	1.10	1.10 / 1.10	A20202121206	A22202121206	0.403
3/4" x 3/4" x 1/2"	30	180	1.18	1.18 / 1.22	A20202121208	A22202121208	0.474
3/4" x 3/4" x 1"	20	120	1.42	1.42 / 1.38	A20202121216	A22202121216	0.668
3/4" x 3/4" x 1 1/4"	25	100	1.61	1.61 / 1.50	A20202121220	A22202121220	0.772
1" x 1/2" x 1/2"	20	120	1.28	1.10 / 1.34	A20202160808	A22202160808	0.485
1" x 1/2" x 3/4"	20	120	1.38	1.50 / 1.42	A20202160812	A22202160812	0.595
1" x 1/2" x 1"	15	90	1.50	1.34 / 1.50	A20202160816	A22202160816	0.741
1" x 3/4" x 1/2"	20	120	1.26	1.18 / 1.34	A20202161208	A22202161208	0.615
1" x 3/4" x 3/4"	25	100	1.38	1.30 / 1.42	A20202161212	A22202161212	0.664
1" x 3/4" x 1"	15	90	1.50	1.42 / 1.50	A20202161216	A22202161216	0.791
1" x 1" x 1/4"	25	150	1.10	1.10 / 1.22	A20202161604	A22202161604	0.525
1" x 1" x 3/8"	20	120	1.18	1.18 / 1.26	A20202161606	A22202161606	0.602
1" x 1" x 1/2"	15	120	1.26	1.26 / 1.34	A20202161608	A22202161608	0.703
1" x 1" x 3/4"	25	100	1.38	1.38 / 1.42	A20202161612	A22202161612	0.774
1" x 1" x 1 1/4"	15	15	1.65	1.65 / 1.57	A20202161620	A22202161620	0.915
1" x 1" x 1 1/2"	15	15	1.81	1.81 / 1.65	A20202161624	A22202161624	1.157
1" x 1" x 2"	12	12	2.00	2.00 / 1.93	A20202161632	A22202161632	1.455
1 1/4" x 1/2" x 1/2"	25	100	1.34	1.06 / 1.50	A20202200808	A22202200808	0.661
1 1/4" x 1/2" x 3/4"	25	100	1.46	1.18 / 1.57	A20202200812	A22202200812	0.794
1 1/4" x 1/2" x 1"	20	80	1.57	1.38 / 1.65	A20202200816	A22202200816	0.935
1 1/4" x 1/2" x 1 1/4"	10	60	1.77	1.50 / 1.77	A20202200820	A22202200820	1.080
1 1/4" x 3/4" x 1/2"	25	100	1.34	1.14 / 1.50	A20202201208	A22202201208	0.763
1 1/4" x 3/4" x 3/4"	10	80	1.42	1.30 / 1.61	A20202201212	A22202201212	0.705
1 1/4" x 3/4" x 1"	10	80	1.57	1.42 / 1.65	A20202201216	A22202201216	0.968
1 1/4" x 3/4" x 1 1/4"	10	60	1.77	1.61 / 1.77	A20202201220	A22202201220	1.160
1 1/4" x 1" x 1/2"	18	72	1.34	1.26 / 1.50	A20202201608	A22202201608	0.750
1 1/4" x 1" x 3/4"	18	72	1.42	1.38 / 1.61	A20202201612	A22202201612	0.906
1 1/4" x 1" x 1"	18	72	1.57	1.50 / 1.61	A20202201616	A22202201616	0.970
1 1/4" x 1" x 1 1/4"	10	60	1.77	1.65 / 1.77	A20202201620	A22202201620	1.146
1 1/4" x 1 1/4" x 3/8"	20	80	1.30	1.30 / 1.42	A20202202006	A22202202006	0.849
1 1/4" x 1 1/4" x 1/2"	20	80	1.34	1.34 / 1.50	A20202202008	A22202202008	0.970
1 1/4" x 1 1/4" x 3/4"	12	72	1.42	1.42 / 1.81	A20202202012	A22202202012	1.005
1 1/4" x 1 1/4" x 1"	16	64	1.57	1.57 / 1.65	A20202202016	A22202202016	1.100
1 1/4" x 1 1/4" x 1 1/2"	14	56	1.89	1.89 / 1.81	A20202202024	A22202202024	1.453



MSI Malleable Iron Pipe Fitting Specifications

800-678-2544 phone 800-678-0857 fax www.msi-products.com msisales@msi-products.com

THREADS: ANSI / ASME B1.20.1 DIMENSIONS: ANSI B16.3 MATERIAL: ASTM A197

Reducing Tees

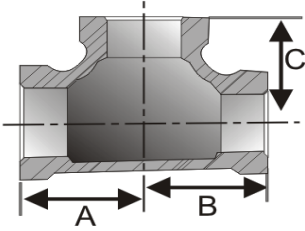

Size	Inner Carton	Master Case	"A" Inch	"B / C" Inch	Black Item Number	Galv. Item Number	Approx. Wgt. Ea / lbs.
1 1/4" x 1 1/4" x 2"	10	40	2.13	2.13 / 1.89	A20202202032	A22202202032	1.742
1 1/2" x 1/2" x 1 1/2"	12	48	1.97	1.65 / 1.97	A20202240824	A22202240824	1.435
1 1/2" x 3/4" x 1 1/2"	12	48	1.97	1.73 / 1.97	A20202241224	A22202241224	1.343
1 1/2" x 1" x 1 1/2"	14	56	1.97	1.81 / 1.97	A20202241624	A22202241624	1.367
1 1/2" x 1 1/4" x 1/2"	8	64	1.42	1.43 / 1.65	A20202242008	A22202242008	1.038
1 1/2" x 1 1/4" x 3/4"	8	64	1.50	1.42 / 1.73	A20202242012	A22202242012	1.036
1 1/2" x 1 1/4" x 1"	14	56	1.65	1.57 / 1.81	A20202242016	A22202242016	1.204
1 1/2" x 1 1/4" x 1 1/4"	12	48	1.81	1.77 / 1.89	A20202242020	A22202242020	1.389
1 1/2" x 1 1/4" x 1 1/2"	10	40	1.97	1.89 / 1.97	A20202242024	A22202242024	1.440
1 1/2" x 1 1/2" x 2"	8	32	2.17	2.17 / 2.04	A20202242432	A22202242432	1.984
1 1/2" x 1 1/2" x 3/8"	18	72	1.34	1.34 / 1.57	A20202242406	A22202242406	0.981
1 1/2" x 1 1/2" x 1/2"	18	72	1.42	1.42 / 1.65	A20202242408	A22202242408	1.030
1 1/2" x 1 1/2" x 3/4"	10	60	1.42	1.42 / 1.61	A20202242412	A22202242412	1.250
1 1/2" x 1 1/2" x 1"	13	52	1.57	1.57 / 1.65	A20202242416	A22202242416	1.409
1 1/2" x 1 1/2" x 1 1/4"	15	45	1.81	1.81 / 1.89	A20202242420	A22202242420	1.579
2" x 1/2" x 2"	8	32	2.25	1.89 / 2.25	A20202320832	A22202320832	2.037
2" x 3/4" x 2"	8	32	2.28	1.97 / 2.28	A20202321232	A22202321232	1.984
2" x 1" x 1 1/2"	10	40	2.00	1.81 / 2.17	A20202321624	A22202321624	1.768
2" x 1" x 2"	8	32	2.28	2.05 / 2.28	A20202321632	A22202321632	1.953
2" x 1 1/4" x 1 1/4"	6	36	1.89	1.77 / 2.13	A20202322020	A22202322020	1.543
2" x 1 1/4" x 1 1/2"	8	32	2.05	1.89 / 2.17	A20202322024	A22202322024	1.698
2" x 1 1/4" x 2"	13	26	2.28	2.17 / 2.28	A20202322032	A22202322032	2.205
2" x 1 1/2" x 3/4"	10	40	1.57	1.50 / 1.97	A20202322412	A22202322412	1.376
2" x 1 1/2" x 1"	10	40	1.73	1.65 / 2.05	A20202322416	A22202322416	1.572
2" x 1 1/2" x 1 1/4"	8	32	1.89	1.81 / 2.13	A20202322420	A22202322420	1.698
2" x 1 1/2" x 1 1/2"	8	32	2.05	1.97 / 2.17	A20202322424	A22202322424	1.812
2" x 1 1/2" x 2"	10	30	2.28	2.17 / 2.28	A20202322432	A22202322432	2.277
2" x 2" x 3/8"	10	40	1.46	1.46 / 1.81	A20202323206	A22202323206	1.455
2" x 2" x 1/2"	10	40	1.50	1.50 / 1.89	A20202323208	A22202323208	1.614
2" x 2" x 3/4"	10	40	1.57	1.57 / 1.97	A20202323212	A22202323212	1.777
2" x 2" x 1"	12	36	1.73	1.73 / 2.05	A20202323216	A22202323216	1.975
2" x 2" x 1 1/4"	8	32	1.89	1.89 / 2.13	A20202323220	A22202323220	1.925
2" x 2" x 1 1/2"	8	32	2.05	2.05 / 2.17	A20202323224	A22202323224	2.081
2" x 2" x 2 1/2"	8	16	2.60	2.60 / 2.40	A20202323240	A22202323240	3.269
2 1/2" x 2" x 2"	11	22	2.40	2.24 / 2.60	A20202403232	A22202403232	3.192
2 1/2" x 2" x 2 1/2"	8	16	2.72	2.60 / 2.72	A20202403240	A22202403240	4.079
2 1/2" x 2 1/2" x 1/2"	8	24	1.61	1.61 / 2.24	A20202404008	A22202404008	2.608
2 1/2" x 2 1/2" x 3/4"	8	24	1.73	1.73 / 2.32	A20202404012	A22202404012	2.853
2 1/2" x 2 1/2" x 1"	8	24	1.86	1.86 / 2.36	A20202404016	A22202404016	2.941
2 1/2" x 2 1/2" x 1 1/4"	10	20	2.05	2.05 / 2.44	A20202404020	A22202404020	2.959
2 1/2" x 2 1/2" x 1 1/2"	5	15	2.16	2.16 / 2.48	A20202404024	A22202404024	3.389
2 1/2" x 2 1/2" x 2"	8	16	2.40	2.40 / 2.60	A20202404032	A22202404032	3.898

MSI Malleable Iron Pipe Fittings Meet the following Specifications: ASME B16.3; ASTM A197; ASME B1.20.1



MSI Malleable Iron Pipe Fitting Specifications

800-678-2544 phone 800-678-0857 fax www.msi-products.com msisales@msi-products.com

THREADS: ANSI / ASME B1.20.1 DIMENSIONS: ANSI B16.3 MATERIAL: ASTM A197

Reducing Tees

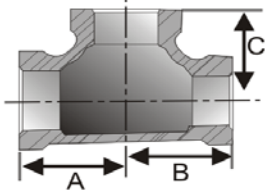

Size	Inner Carton	Master Case	"A" Inch	"B / C " Inch	Black Item Number	Galv. Item Number	Approx. Wgt. Ea / lbs.
3" x 3" x 1/2"	6	18	2.00	2.00 / 2.68	A20202484808	A22202484808	2.822
3" x 3" x 3/4"	6	18	2.00	2.00 / 2.68	A20202484812	A22202484812	3.175
3" x 3" x 1"	5	15	2.00	2.00 / 2.64	A20202484816	A22202484816	3.497
3" x 3" x 1 1/4"	6	12	2.17	2.17 / 2.76	A20202484820	A22202484820	3.836
3" x 3" x 1 1/2"	6	12	2.28	2.28 / 2.80	A20202484824	A22202484824	4.806
3" x 3" x 2"	6	12	2.52	2.52 / 2.87	A20202484832	A22202484832	4.553
3" x 3" x 2 1/2"	6	12	2.83	2.83 / 2.99	A20202484840	A22202484840	5.137
4" x 4" x 1"	2	8	2.20	2.20 / 3.19	A20202646416	A22202646416	5.800
4" x 4" x 1 1/4"	2	8	2.40	2.40 / 3.27	A20202646420	A22202646420	6.515
4" x 4" x 1 1/2"	2	8	2.52	2.52 / 3.30	A20202646424	A22202646424	6.636
4" x 4" x 2"	4	8	2.76	2.76 / 3.38	A20202646432	A22202646432	6.978
4" x 4" x 2 1/2"	2	6	3.03	3.03 / 3.50	A20202646440	A22202646440	9.083
4" x 4" x 3"	2	6	3.30	3.30 / 3.62	A20202646448	A22202646448	8.175

Side Outlet Tees

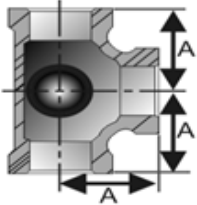

Size	Inner Carton	Master Case	"A" Inch	Black Item Number	Galv. Item Number	Approx. Wgt. Ea / lbs.
1/2"	45	270	1.10	A2020808	A2220808	0.379
3/4"	20	160	1.30	A2020812	A2220812	0.578
1"	20	80	1.50	A2020816	A2220816	0.891
1 1/4"	15	45	1.77	A2020820	A2220820	1.389
1 1/2"	12	36	1.97	A2020824	A2220824	1.653
2"	12	24	2.28	A2020832	A2220832	2.582

Floor Flanges

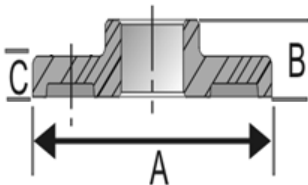

Size	Inner Carton	Master Case	"A" Inch	"B / C " Inch	Black Item Number	Galv. Item Number	Approx. Wgt. Ea / lbs.
3/8"	25	150	2.83	0.47 / 0.20	A2063006	A2263006	0.608
1/2"	25	100	2.95	0.59 / 0.20	A2063008	A2263008	0.730
3/4"	15	90	3.35	0.59 / 0.20	A2063012	A2263012	0.752
1"	15	60	3.66	0.75 / 0.20	A2063016	A2263016	1.005
1 1/4"	10	60	3.97	0.87 / 0.24	A2063020	A2263020	1.082
1 1/2"	8	48	4.37	0.87 / 0.24	A2063024	A2263024	1.709
2"	8	32	5.66	0.87 / 0.31	A2063032	A2263032	3.236

300lb. 90° Elbows

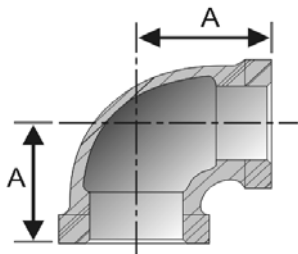

Size	Inner Carton	Master Case	"A" Inch	Black Item Number	Galv. Item Number	Approx. Wgt. Ea / lbs.
1/4"	180	360	0.94	A2910004	A7210004	0.205
3/8"	120	240	1.06	A2910006	A7210006	0.298
1/2"	40	80	1.25	A2910008	A7210008	0.448
3/4"	30	60	1.44	A2910012	A7210012	0.723
1"	20	40	1.63	A2910016	A7210016	1.160
1 1/4"	12	24	1.94	A2910020	A7210020	1.698
1 1/2"	8	16	2.13	A2910024	A7210024	2.452
2"	6	12	2.49	A2910032	A7210032	3.761
2 1/2"	4	8	2.94	A2910040	A7210040	6.230
3"	2	4	3.38	A2910048	A7210048	9.405
4"	1	2	4.13	A2910064	A7210064	14.083

300lb. 45° Elbows

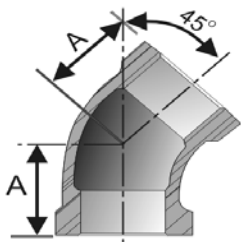

Size	Inner Carton	Master Case	"A" Inch	Black Item Number	Galv. Item Number	Approx. Wgt. Ea / lbs.
1/4"	180	360	0.81	A2910404	A7210404	0.192
3/8"	120	240	0.88	A2910406	A7210406	0.284
1/2"	40	80	0.99	A2910408	A7210408	0.423
3/4"	30	60	1.13	A2910412	A7210412	0.683
1"	20	40	1.31	A2910416	A7210416	1.041
1 1/4"	12	24	1.50	A2910420	A7210420	1.691
1 1/2"	8	16	1.69	A2910424	A7210424	2.249
2"	6	12	1.99	A2910432	A7210432	3.620
2 1/2"	2	4	2.25	A2910440	A7210440	5.542
3"	1	2	2.49	A2910448	A7210448	8.684
4"	1	2	2.80	A2910464	A7210464	11.722

300lb. 90° Street Elbows

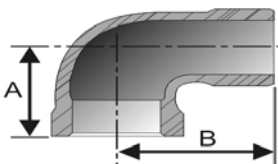

Size	Inner Carton	Master Case	"A" Inch	"B" Inch	Black Item Number	Galv. Item Number	Approx. Wgt. Ea / lbs.
1/4"	180	360	0.94	1.44	A2910604	A7210604	0.172
3/8"	120	240	1.06	1.63	A2910606	A7210606	0.258
1/2"	40	80	1.25	1.99	A2910608	A7210608	0.390
3/4"	30	60	1.44	2.19	A2910612	A7210612	0.628
1"	20	40	1.63	2.56	A2910616	A7210616	1.021
1 1/4"	12	24	1.94	2.87	A2910620	A7210620	1.678
1 1/2"	8	16	2.13	3.13	A2910624	A7210624	1.726
2"	6	12	2.49	3.69	A2910632	A7210632	3.633
2 1/2"	2	4	2.89	4.02	A2910640	A7210640	3.907
3"	1	2	3.35	4.72	A2910648	A7210648	7.438
4"	1	2	4.13	5.83	A2910664	A7210664	10.496

MSI Malleable Iron Pipe Fitting Specifications

800-678-2544 phone 800-678-0857 fax www.msi-products.com msisales@msi-products.com

THREADS: ANSI / ASME B1.20.1 DIMENSIONS: ANSI B16.3 MATERIAL: ASTM A197

300lb. Tees

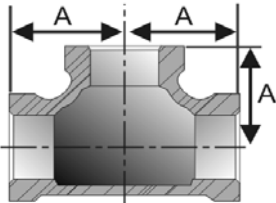

Size	Inner Carton	Master Case	"A" Inch	Black Item Number	Galv. Item Number	Approx. Wgt. Ea / lbs.
1/4"	120	240	0.94	A2920004	A7220004	0.289
3/8"	90	180	1.06	A2920006	A7220006	0.425
1/2"	30	60	1.25	A2920008	A7220008	0.655
3/4"	20	40	1.44	A2920012	A7220012	1.049
1"	12	24	1.63	A2920016	A7220016	1.570
1 1/4"	10	20	1.94	A2920020	A7220020	2.544
1 1/2"	6	12	2.13	A2920024	A7220024	3.316
2"	4	8	2.49	A2920032	A7220032	5.302
2 1/2"	2	4	2.94	A2920040	A7220040	8.314
3"	1	2	3.37	A2920048	A7220048	12.712
4"	1	2	4.13	A2920064	A7220064	18.964

300lb. Couplings - Banded

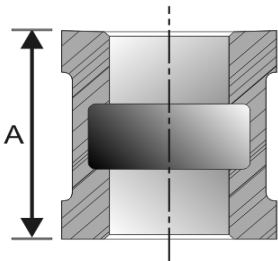

Size	Inner Carton	Master Case	"A" Inch	Black Item Number	Galv. Item Number	Approx. Wgt. Ea / lbs.
1/4"	200	400	1.37	A2930404	A7230404	0.163
3/8"	150	300	1.62	A2930406	A7230406	0.265
1/2"	40	80	1.87	A2930408	A7230408	0.412
3/4"	30	60	2.12	A2930412	A7230412	0.653
1"	20	40	2.37	A2930416	A7230416	1.014
1 1/4"	12	24	2.87	A2930420	A7230420	1.656
1 1/2"	12	24	2.16	A2930424	A7230424	2.015
2"	6	12	2.87	A2930432	A7230432	3.483
2 1/2"	4	8	4.12	A2930440	A7230440	5.342
3"	2	4	4.12	A2930448	A7230448	7.291
4"	2	4	4.25	A2930464	A7230464	10.448

300lb. Caps

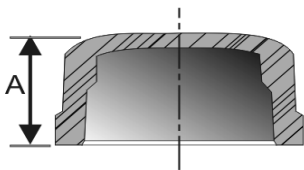

Size	Inner Carton	Master Case	"A" Inch	Black Item Number	Galv. Item Number	Approx. Wgt. Ea / lbs.
3/8"	120	240	0.83	A2940506	A7240506	0.137
1/2"	80	160	0.98	A2940508	A7240508	0.223
3/4"	50	100	1.08	A2940512	A7240512	0.342
1"	30	60	1.26	A2940516	A7240516	0.534
1 1/4"	20	40	1.38	A2940520	A7240520	0.814
1 1/2"	15	30	1.43	A2940524	A7240524	1.082
2"	10	20	1.68	A2940532	A7240532	1.845
2 1/2"	8	16	2.21	A2940540	A7240540	3.003
3"	5	10	2.36	A2940548	A7240548	4.370
4"	3	6	2.76	A2940564	A7240564	6.916

MSI Malleable Iron Pipe Fitting Specifications

800-678-2544 phone 800-678-0857 fax www.msi-products.com msisales@msi-products.com

THREADS: ANSI / ASME B1.20.1 DIMENSIONS: ANSI B16.3 MATERIAL: ASTM A197

300lb. Unions

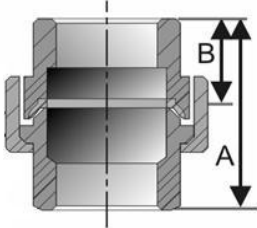

Size	Inner Carton	Master Case	"A" Inch	"B" Inch	Black Item Number	Galv. Item Number	Approx. Wgt. Ea / lbs.
1/4"	120	240	1.65	0.84	A2940804	A7240804	0.333
3/8"	90	180	1.80	0.90	A2940806	A7240806	0.465
1/2"	40	80	2.03	1.02	A2940808	A7240808	0.600
3/4"	30	60	2.25	1.12	A2940812	A7240812	0.844
1"	18	36	2.42	1.21	A2940816	A7240816	1.435
1 1/4"	12	24	2.80	1.40	A2940820	A7240820	2.097
1 1/2"	10	20	3.03	1.50	A2940824	A7240824	2.489
2"	6	12	3.43	1.72	A2940832	A7240832	4.096
2 1/2"	4	8	3.73	1.86	A2940840	A7240840	6.554
3"	3	6	4.45	2.24	A2940848	A7240848	10.587
4"	1	2	4.96	2.48	A2940864	A7240864	18.682

300lb. Reducing Tees

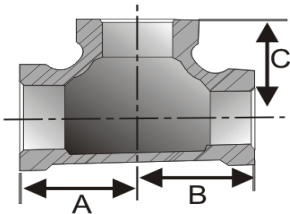

Size	Inner Carton	Master Case	"A" Inch	"B / C" Inch	Black Item Number	Galv. Item Number	Approx. Wgt. Ea / lbs.
3/4" x 3/4" x 1/2"	30	60	1.31	1.31 / 1.37	A29202121208	A72202121208	1.248
1" x 1" x 1/2"	16	32	1.44	1.44 / 1.49	A29202161608	A72202161608	1.270
1" x 1" x 3/4"	15	30	1.38	1.49 / 1.56	A29202161612	A72202161612	1.367
1 1/4" x 1 1/4" x 1/2"	12	24	1.50	1.50 / 1.69	A29202202008	A72202202008	2.022
1 1/4" x 1 1/4" x 3/4"	12	24	1.63	1.63 / 1.74	A29202202012	A72202202012	1.993
1 1/4" x 1 1/4" x 1"	12	24	1.74	1.74 / 1.82	A29202202016	A72202202016	2.218
1 1/2" x 1 1/2" x 1/2"	10	20	1.63	1.63 / 1.81	A29202242408	A72202242408	2.626
1 1/2" x 1 1/2" x 3/4"	10	20	1.69	1.69 / 1.88	A29202242412	A72202242412	2.716
1 1/2" x 1 1/2" x 1"	10	20	1.81	1.81 / 2.00	A29202242416	A72202242416	2.665
1 1/2" x 1 1/2" x 1 1/4"	8	16	2.00	2.00 / 2.06	A29202242420	A72202242420	3.045
2" x 2" x 1"	5	10	2.00	2.00 / 2.25	A29202323216	A72202323216	4.447
2" x 2" x 1 1/4"	5	10	2.13	2.13 / 2.38	A29202323220	A72202323220	4.363
2" x 2" x 1 1/2"	5	10	2.24	2.24 / 2.31	A29202323224	A72202323224	4.614
2 1/2" x 2 1/2" x 2"	4	8	2.69	2.69 / 2.75	A29202404032	A72202404032	3.320
3" x 3" x 2"	2	4	2.81	2.81 / 3.13	A29202646432	A72202484832	9.667



MSI Malleable Iron Pipe Fitting Specifications

800-678-2544 phone 800-678-0857 fax www.msi-products.com msisales@msi-products.com

THREADS: ANSI / ASME B1.20.1 DIMENSIONS: ANSI B16.3 MATERIAL: ASTM A197

300lb. Reducer Coupling

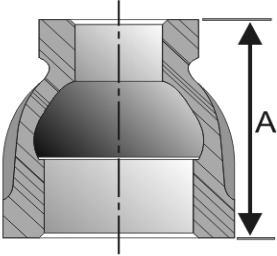

Size	Inner Carton	Master Case	"A" Inch	Black Item Number	Galv. Item Number	Weight Ea / (lb.)
1/2" x 1/4"	100	200	1.69	A293080804	A723080804	0.311
1/2" x 3/8"	100	200	1.69	A293080806	A723080806	0.340
3/4 x 3/8"	60	120	1.75	A293081206	A723081206	0.459
3/4 x 1/2"	60	120	1.75	A293081208	A723081208	0.496
1" x 1/2"	50	100	2.00	A293081608	A723081608	0.772
1" x 3/4"	40	80	2.00	A293081612	A723081612	0.853
1 1/4" x 1/2"	24	48	2.38	A293082008	A723082008	1.120
1 1/4" x 3/4"	20	40	2.38	A293082012	A723082012	1.204
1 1/4" x 1"	20	40	2.38	A293082016	A723082016	1.246
1 1/2" x 1/2"	24	48	2.69	A293082408	A723082408	1.475
1 1/2" x 3/4"	20	40	2.69	A293082412	A723082412	1.539
1 1/2" x 1"	18	36	2.69	A293082416	A723082416	1.629
1 1/2" x 1 1/4"	18	36	2.69	A293082420	A723082420	1.814
2" x 1/2"	12	24	3.19	A293083208	A723083208	2.460
2" x 3/4"	12	24	3.19	A293083212	A723083212	2.407
2" x 1"	12	24	3.19	A293083216	A723083216	2.463
2" x 1 1/4"	8	16	3.19	A293083220	A723083220	2.709
2" x 1 1/2"	4	16	3.19	A293083224	A723083224	2.758
2 1/2" x 1 1/2"	6	8	3.69	A293084024	A723084024	3.757
2 1/2" x 2"	6	12	3.69	A293084032	A723084032	4.376
3" x 2"	4	8	4.06	A293084832	A723084832	5.847
3" x 2 1/2"	4	8	4.06	A293084840	A723084840	6.288
4" x 3"	2	4	4.41	A293086448	A723086448	8.999