

Wi-Fi Interface for VRF

Job Name: _____
 Location: _____
 Engineer: _____
 Submitted to: _____
 Submitted by: _____
 Reference: _____

Date: _____
 Approval: _____
 Construction: _____
 Unit #: _____
 Drawing #: _____



General Features

The Wi-Fi Interface for VRF is used to manage VRF indoor units through the Internet using a smart phone, tablet or PC. It is an external module that connects the VRF indoor unit to the Internet cloud using the Wi-Fi network.

Features

- Manages the VRF indoor unit using the iOS or Android
- Programs the indoor unit operation schedule.
- Offers access to several indoor unit settings including, Mode, temperature set point, and much more.
- Offers early startup that brings the space to the desired set point before arriving.
- Also, offers delayed setback after leaving.
- Powered through the Indoor Unit. No external power supply required.
- Provides instant alarm notifications.
- Error reporting, available in several languages.

Other

Warranty 2 years
 Enclosure UL Approval ABS (UL 94 HB)
 RoHS Conformity..... Compliant with RoHS directive (2002/95/EC)
 Certifications.....CE conformity to EMC directive (2004/108/EC) and low voltage directive (2006/95/EC)
 EN 60950-1
 EN301489-1 v1.8.1
 EN301489-17 v2.1.1

Electrical

Power Supply DC (V) 12
 Current (mA) 55

Temperature

Operating Temperature Range °F (°C) 32 - 104 (0 - 40)
 Humidity range (%) < 93 (no condensation)

Weight and Dimensions

Weight lbs.(g) 0.17 (80)
 Dim.Net (HxWxD) in(mm) 2-3/4 x 4-1/4 x 1-1/8 (70 x 108 x 28)
 ColorWhite
 LED light while setting up and off when is connected.

Compatible remotes

UTY-RNKU, UTY-RSKU, UTY-RHKU,UTY-LNHU

Installation Example

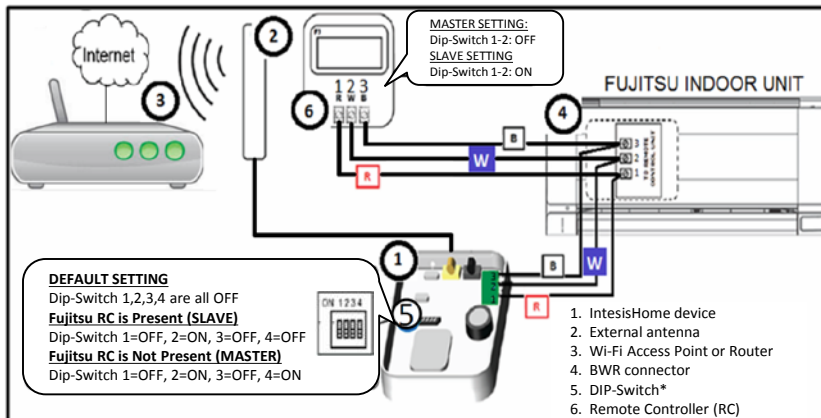

Wi-Fi Interface for VRF

Model Compatibility

Type	Indoor unit Model	Required parts*
Compact Wall Mounted (ASUA)	7, 9, 12, 14RLAV	Plug model: K9707476019
	7, 9, 12, 14TLAV	
Wall Mounted (ASUB)	18, 24RLAV	Plug model: K9709223017
	18, 24TLAV	
Compact Cassette (AUUA)	7, 9, 12, 14, 18, 24RLAV	Built-in Low voltage terminal block
	7, 9, 12, 14, 18, 24TLAV	
Cassette (AUUB)	18, 24, 30, 36RLAV	
	18, 24, 30, 36TLAV	
Floor/Ceiling (ABUA)	12, 14, 18, 24RLAV	
	12, 14, 18, 24TLAV	
Ceiling (ABUA)	30, 36RLAV	
	30, 36TLAV	
Slim Duct (ARUL)	7, 9, 12, 14, 18RLAV	
	7, 9, 12, 14, 18TLAV	
Medium Static Pressure Duct (ARUM)	24, 30, 36RLAV	
	24, 30, 36TLAV	
High Static Pressure Duct (ARUH)	36, 48, 60RLAV	
	36, 48, 60, 72, 96TLAV	
Vertical Air Handler (ARUV)	12, 18, 24, 30, 36, 48, 60TLAV	

*Plug included with indoor wall mount units

Dimensions

Unit: in (mm)

