



just your speed.

Three speeds.



One reputation.

If you've been searching for a reliable 3-speed circulator, search no more. Our Radiant and Service 3-speed pumps are built to the exacting standards you've come to expect from Taco.

The 00R 3-Speed Radiant Pump. **Heavy duty reliability.**

Everything that goes into the 3-Speed Radiant Pump – from the powerful, high performance motor to the durable 3-speed switch – says “heavy duty”. With the highest starting torque in its class, this circulator delivers the performance and fine tuning capabilities sure to satisfy the most demanding installer of hydronic systems.

The 0010 3-Speed Service Pump. A perfect fit.

The 3-Speed Service Pump is specially designed to make short work of service calls. Since it replaces the most commonly used circulators you'll appreciate it the next time you're out on a job at 2 AM. The handy new **universal 4-bolt flange** simplifies change-out of any pump, regardless of style, type, or age. Keep one in the truck – just in case!

Performance & convenience.

Both 3-speed circulators feature a removable Integral Flow Check (IFC®) that maximizes pump performance and protects against

gravity flow, even in the tallest buildings. Wiring is a snap thanks to an extra roomy capacitor box and convenient dual electrical knock-outs.

Try one on for size.

Whether you need a single speed 00®, a 3-Speed Radiant Pump for easy fine-tuning, or a 3-Speed Service Pump for convenience, you can be sure that every Taco circulator is designed to build your business. Visit www.taco-hvac.com learn more or stop by your wholesaler for a first-hand look. You'll find we're just your speed.

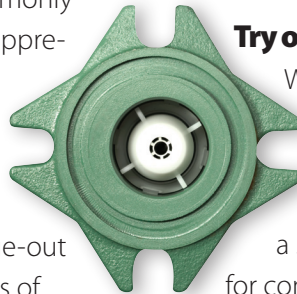

Taco
comfort made easy®
www.taco-hvac.com

Catalog # 100-51
 Submittal Data # 101-125
 Supersedes: 06/24/11

Effective: 12/06/11

Features

- Multi-Speed performance
- Fine tune to system requirements
- Highest performance & starting torque in class
- Heavy duty construction for longer life
- 4-bolt universal flange (0010 only)
- Removable high-flow Integral Flow Check (IFC*)
 - Prevents gravity flow
 - Reduces installation costs
 - Improves pump performance
- Replaceable cartridge design
- Quiet, efficient operation
- Self lubricating, no mechanical seal
- Wide range of applications
- Cast Iron, flanged construction

Materials of Construction

Casing:.....Cast Iron
 Integral Flow Check (IFC*):
 Body, Plunger.....Acetal
 O-ring Seal.....EPDM
 SpringStainless Steel
 Stator Housing:.....Steel
 Cartridge:.....Stainless Steel
 Impeller:.....Non-Metallic
 Shaft:.....Ceramic
 Bearings:.....Carbon
 O-Ring & Gaskets:.....EPDM

Model Nomenclature

F – Cast Iron, Flanged
 MS – Multi-Speed
 IFC – Integral Flow Check

Performance Data

	00R	0010
Flow Range (GPM):	0-18	0-29
Head Range (FT):	0-21	0-10.5
Minimum Fluid Temperature:	40°F (4°C)	
Maximum Fluid Temperature:	230°F (110°C)	
Maximum Working Pressure:	125 psi	
Connection Sizes:	3/4", 1", 1-1/4", 1-1/2" Flanged	



FOR INDOOR USE ONLY

Application

The 00R 3-Speed Radiant pump is specifically designed for the flow and head requirements of today's radiant heat systems yet is adaptable for hydronic baseboard systems as well. Its 3-Speed switching capability provides fine tuning control to match a wide combination of tube diameters and length of runs. The 00R 3-Speed Radiant pump is a direct replacement for the Grundfos UPS 15-58 3-Speed. The 00R delivers the highest starting torque in its class and a removable, high-flow Integral Flow Check (IFC*) that prevents gravity flow, reduces installation costs and improves pump performance.

The 0010 3-Speed Service pump is designed as an ideal replacement circulator for service contractors to use on any emergency "no-heat" call. The 0010 3-Speed replaces most commonly used circulators. Simply install it and set the speed to match the original pump performance. The handy new four bolt flange matches up to any pump regardless of style, type or age.

Pump Dimensions & Weights

Cast Iron Models	A		B		C		D		F		G		Ship Wt.	
	in.	mm	in.	mm	in.	mm	in.	mm	in.	mm	in.	mm	lbs.	Kg
00R-MSF2 IFC	6-1/2	165	4-5/8	118	3-3/16	81	3-7/16	78	5-3/8	137	6-3/8	162	8	3.5
00R-MSF2-1 IFC	6	152	4-5/8	118	3-3/16	81	3-7/16	78	5-3/8	137	6-3/8	162	8	3.5
0010-MSF1-IFC	6-11/16	170	4-3/4	120	3-3/16	81	3-7/16	78	5-3/8	137	6-3/8	162	10	4.5

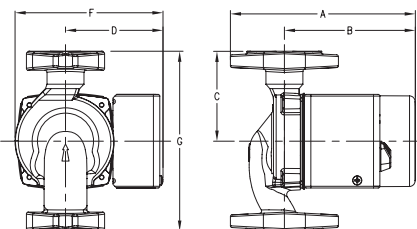

Mounting Positions

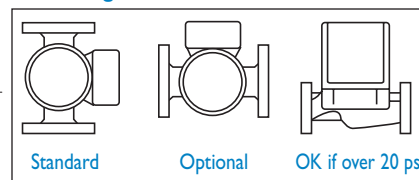

Electrical Data

Model	Volts	Hz	Ph	Amps			RPM (Speed 3)	HP
				Speed 1	Speed 2	Speed 3		
All Models	115	60	1	.71	.82	.98	3250	1/20
Motor Type	Permanent Split Capacitor Thermally Protected							

Flange Orientation

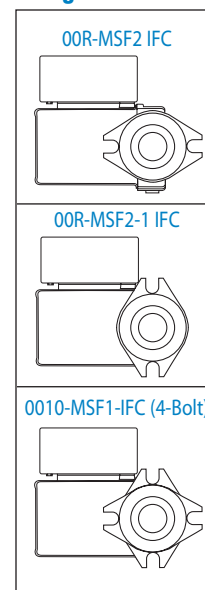

Performance Field - 60Hz

