

Cabinet Features

- Models 1210/1310/1410 are whole home air cleaners.
- Unit operation is completely silent.
- Only maintenance required is replacement of the disposable media.
- Outer housing is heavy gauge, preassembled galvanized steel.
- Self-aligning painted door easily snaps into place every time.
- Cabinet and media are UL classified.
- Warranted for five (5) years from the date of installation to be free from defects in materials or workmanship. Media is disposable and does not apply to warranty.
- Narrow 6.75" cabinet for easier installations and more flexible applications.



Replacement Media Features

- MERV 11 media permanently traps up to 85% of pollen-sized particles (5.0 microns) and up to 80% of mold and spore-sized particles (3.0 microns).
- Collapsible media with self spacing pleats installs in seconds.
- Media replacement is recommended after one year.
- SelfSeal™ dramatically reduces air bypass, improving media performance.
- Exclusive media design protects your replacement media business.

Upgrade Replacement Media Features

- MERV 13 media permanently traps up to 75% of bacteria sized particles (.3 to 1 micron).
- MERV 13 media permanently traps over 90% of respirable dust and pet dander sized particles (1.0 to 3.0 microns).
- MERV 13 media permanently traps over 90% of pollen, mold and spore sized particles (3.0 to 10.0 microns).

PRODUCT SPECIFICATIONS

1210/1310/1410 UNITS

210/310/410 REPLACEMENT MEDIA (MERV 11)

213/313/413 UPGRADE MEDIA (MERV 13)

1210/1310/1410 UNITS		210/310/410 REPLACEMENT MEDIA (MERV 11)			213/313/413 UPGRADE MEDIA (MERV 13)				
	Shipping Weight		Resistance @ Airflow Volume (inches w.c. @CFM)	Shipping Weight (full carton)	Filtering Media Area		Resistance @ Airflow Volume (inches w.c. @CFM)	Shipping Weight (full carton)	Filtering Media Area
Model 1210	18 lbs.	Model 210	.04"@600 .13"@1400 .06"@800 .16"@1600 .08"@1000 .19"@1800 .11"@1200 .22"@2000	28.4 lbs.	31.4 sq. ft.	Model 213	.06"@600 .20"@1400 .09"@800 .25"@1600 .12"@1000 .30"@1800 .16"@1200 .35"@2000	29.4 lbs.	31.4 sq. ft.
Model 1310	15 lbs.	Model 310	.07"@600 .19"@1200 .10"@800 .25"@1400 .14"@1000	19.9 lbs.	19.4 sq. ft.	Model 313	.09"@600 .13"@800 .18"@1000 .23"@1200	20.9 lbs.	19.4 sq. ft.
Model 1410	17 lbs.	Model 410	.05"@600 .15"@1400 .07"@800 .19"@1600 .09"@1000 .22"@1800 .12"@1200 .27"@2000	27.8 lbs.	28.3 sq. ft.	Model 413	.06"@600 .22"@1400 .09"@800 .26"@1600 .13"@1000 .31"@1800 .17"@1200 .37"@2000	28.8 lbs.	28.3 sq. ft.



APRILAIRE MODEL 1210/1310/1410 MEDIA AIR CLEANERS

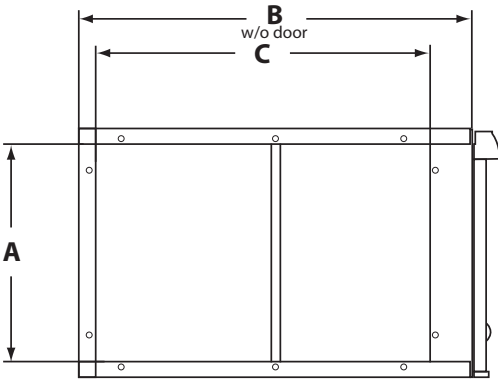

Outlet Side
Furnace Connection

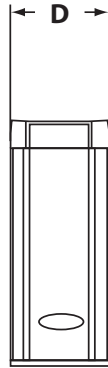

Front

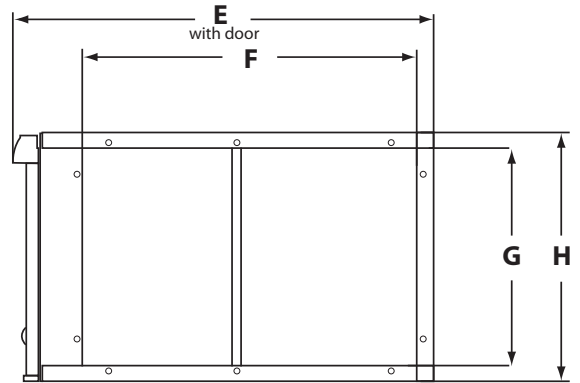

Inlet Side
Return Duct Connection

Dimension	Description	Model 1210	Model 1310	Model 1410
A	Outlet Opening Height	19.75" (502mm)	18.06" (459mm)	15.44" (392mm)
B	Outer Housing Depth Without Door	25.38" (645mm)	20.06" (510mm)	28.06" (713mm)
C	Outlet Opening Width	21.19" (557mm)	15.88" (403mm)	23.88" (625mm)
D	Unit Width	6.75" (254mm)	6.75" (254mm)	6.75" (254mm)
E	Outer Housing Depth With Door	27.38" (679mm)	22.06" (560mm)	30.06" (749mm)
F	Inlet Opening Width	21.19" (502mm)	15.88" (403mm)	23.88" (606mm)
G	Inlet Opening Height	19.75" (546mm)	18.06" (459mm)	15.44" (392mm)
H	Unit Height	22.06" (560mm)	20.38" (518mm)	17.75" (451mm)

Clean Air

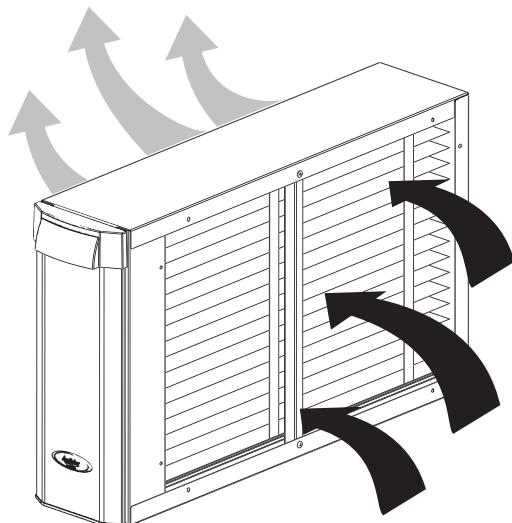

Dirt
Pet Dander
Allergens
Chemicals
Pollen

REPLACEMENT MEDIA

MODEL	APRILAIRE PART #	MERV
MODEL 1210	APRILAIRE PART # 210	MERV 11
	APRILAIRE PART # 213	MERV 13
MODEL 1310	APRILAIRE PART # 310	MERV 11
	APRILAIRE PART # 313	MERV 13
MODEL 1410	APRILAIRE PART # 410	MERV 11
	APRILAIRE PART # 413	MERV 13

APRILAIRE RESERVES THE RIGHT TO CHANGE SPECIFICATIONS WITHOUT NOTICE.



PO Box 1467 • Madison, WI 53701-1467 • Phone 800/334-6011 • Fax 608/257-4357 • www.aprilairepartners.com